

DOG HOUSE RULES

FRONTIER TOWNS

FORT GRIFFIN

DOG HOUSE RULES
SAVAGED

THE FLAT MAP PACK 1" x 1" GRID



DHR1020SW

CENTRAL STATES
AND
OF THE
ERN D

10 Square Miles
Scale of Miles

DOG HOUSE RULES

FRONTIER TOWNS

FORT GRIFFIN



CREDITS

Author: Christopher S. Warner

Contributing Author: Geoff Spakes

Senior Editor: Thomas L. Gregory

Associate Editors: Bradley W. Hindman, Mark Olson

Layout and Graphic Design: Karl Keesler

Cartography: Karl Keesler, Geoff Spakes, Kirk Veitch, Christopher S. Warner

Cover Design: Karl Keesler

Original Artwork: Manoel Magalhães

Proofreader: Dana Warner

This game references the *Savage Worlds* game system, available from Pinnacle Entertainment Group at www.peginc.com. *Savage Worlds* and all associated logos and trademarks are copyrights of Pinnacle Entertainment Group. Used with permission. Pinnacle makes no representation or warranty as to the quality, viability, or suitability for purpose of this product.



Copyright © 2017, 2010 Dog House Rules LLC. Christopher S. Warner, Bradley W. Hindman, Karl Keesler, Thomas L. Gregory, Geoff Spakes.
All rights reserved under international copyright conventions.



THE FLAT MAP PACK

Any Judge presiding over The Flat will need maps of the town and all its establishments at the ready. Of course, the Dog House Gang has embedded maps in the main Fort Griffin Savaged document, for easy reading, but when the Judge sits down at the tabletop (good solid wood or one of those newfangled electronic contraptions) the contents herein will put things in apple pie order.

Included for your shoot 'em-up fun:

Three types of maps are provided for use at the Judge's discretion.

Tiled establishment maps – two versions of each, suitable for tabletop printing

- With a 1" x 1" grid (grid size is 1 inch = 5 feet of gaming space) -- fgsmapsgrid.pdf
- Without a grid (so grid size ain't a concern) -- fgsmapswithoutgrid.pdf

VTT establishment maps – two versions of each, compatible with VTT systems

- With a 1" x 1" grid (grid size is 1 inch = 5 feet of gaming space) -- fgsVTTmaps.zip\1x1_GRID
- Without a grid -- fgsVTTmaps.zip\NO_GRID

Area maps – one page JPEG, without a grid

- The Flat -- fgsVTTmaps.zip\TheFlat.jpg
- North Central Texas four-county area -- fgsVTTmaps.zip\FortGriffinArea.jpg

How to Print

This pdf is built in layers, allowing the Judge to print the maps in different ways, with a simple toggle to include or remove elements on the page. A few tips for the trail:

- Background layer – toggle off to remove page borders and background color
- Text layer – toggle off to remove all text from display
- Maps layer – toggle off to remove maps from the pages (*Ed. Note: now why would anyone want to print map pages without the maps?*)

Additionally, here are some particulars about the maps:

The tiled establishment maps for the tabletop warrant some small explanation. The Dog House Gang recommends the following:

- Print out each tiled map section at 100%.
- Cut out the individual map segments, assemble them and connect them using either glue or tape or some such. (We prefer to glue the sections of the maps on black poster board from the local general store, for extra stability at the table.)

The VTT versions of the establishments and the area maps are simple, we reckon. Go ahead and click "print," pard.

SHANNSEY'S SALOON



SHANNSEY'S SALOON



✂ BEEHIVE SALOON *✂*

FIRST FLOOR

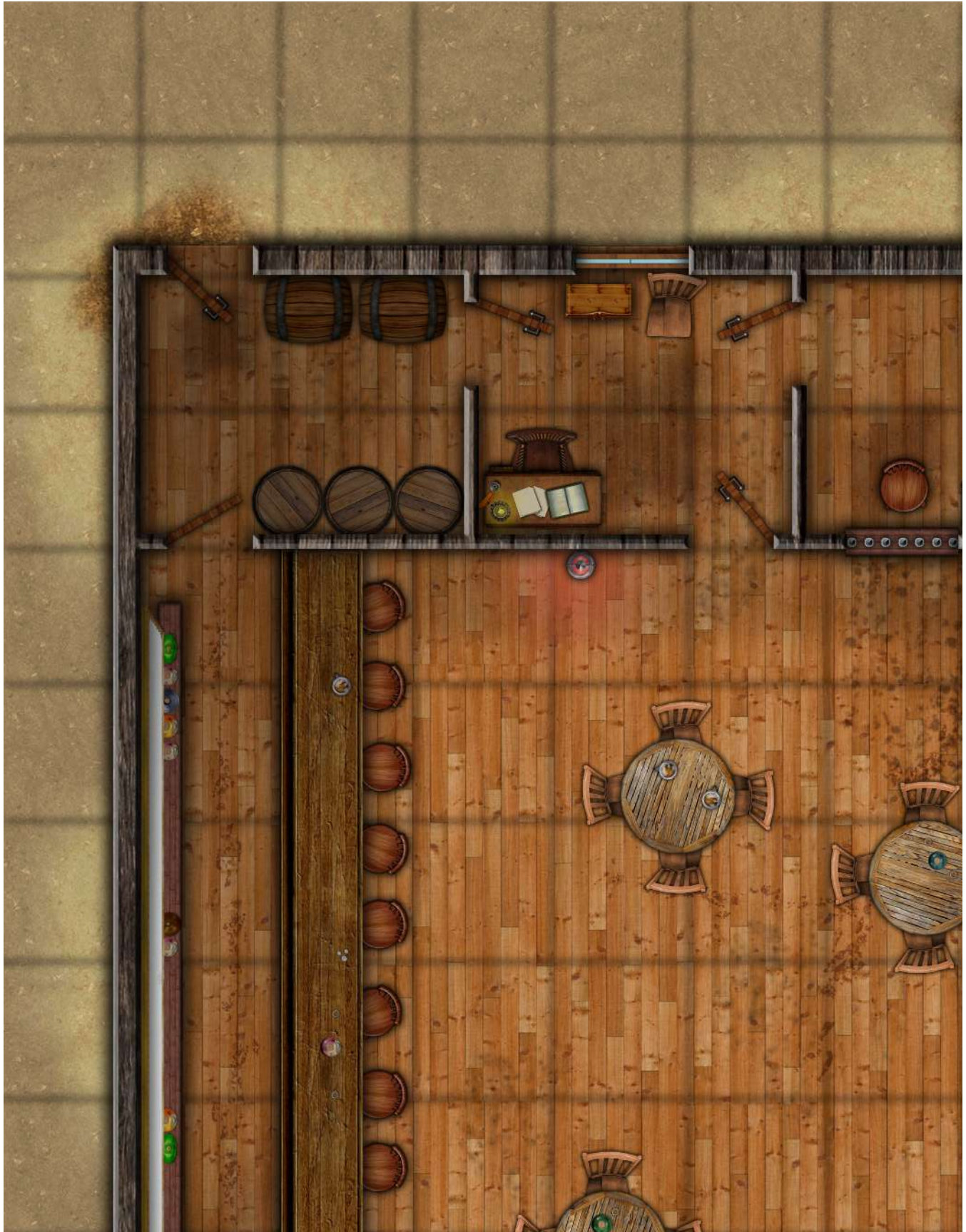

❧ BEEHIVE SALOON ❧

FIRST FLOOR

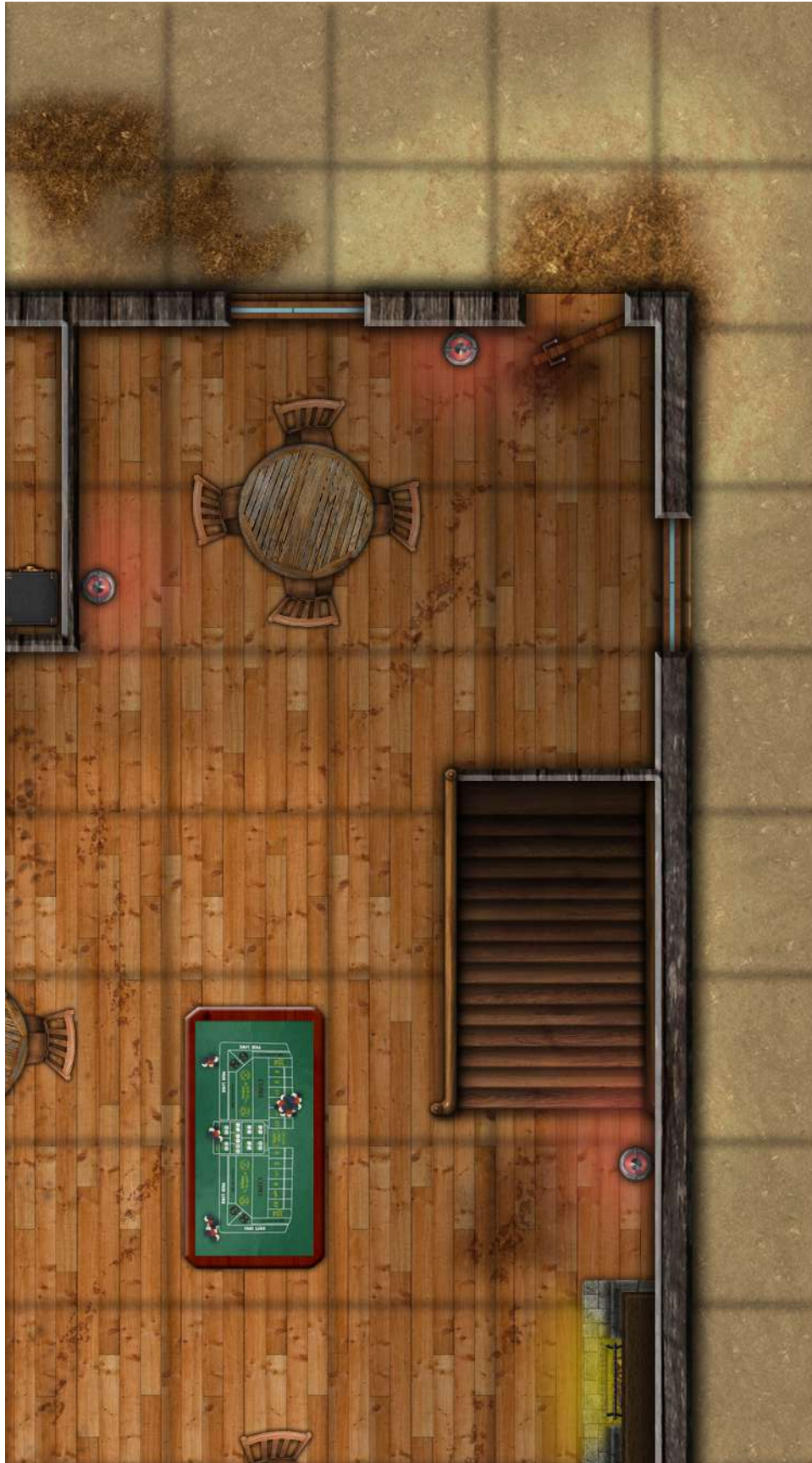

✂ BEEHIVE SALOON ✂

FIRST FLOOR

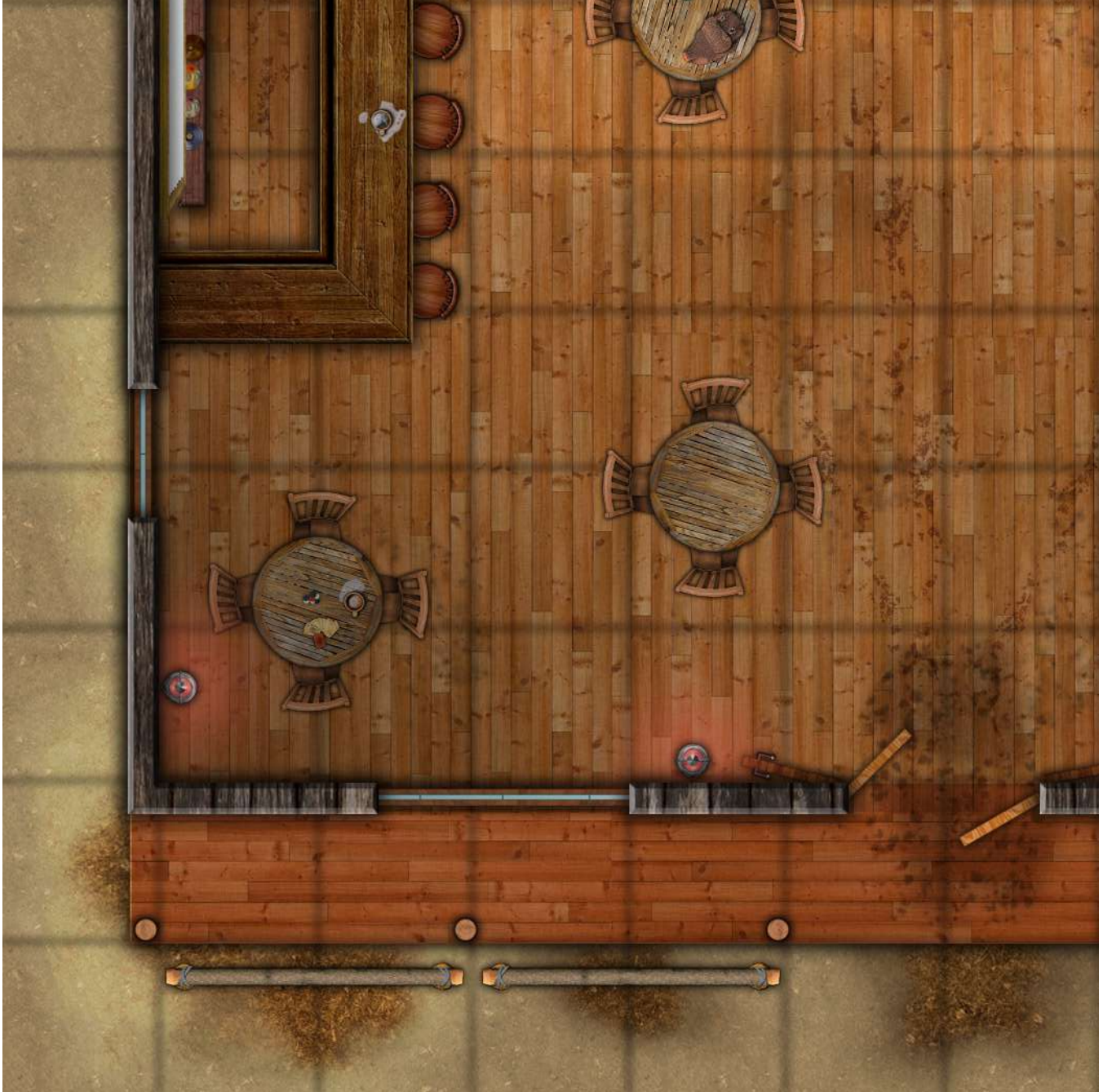

❧ BEEHIVE SALOON ❧

FIRST FLOOR



~ BEEHIVE SALOON *~*

SECOND FLOOR

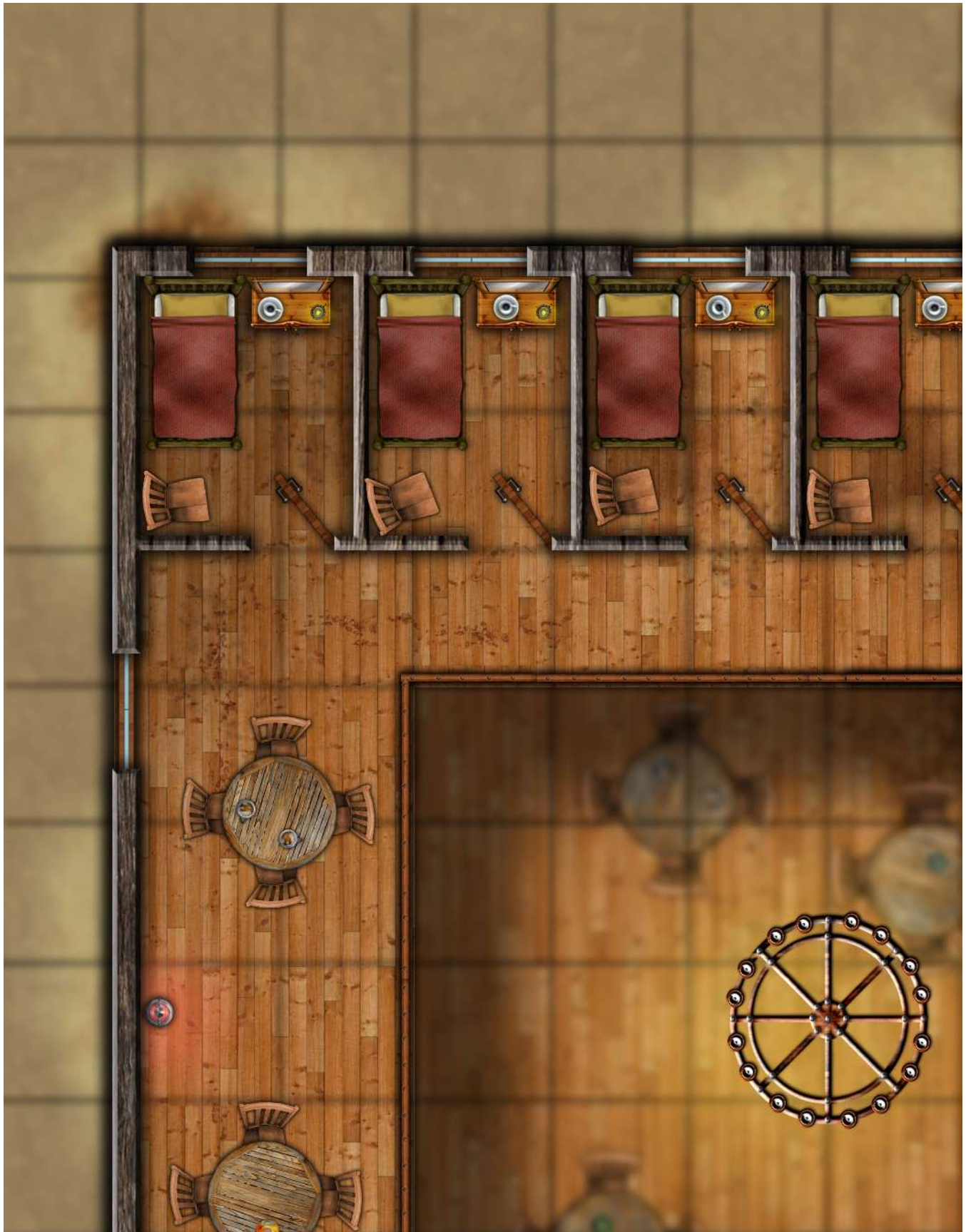

❧ BEEHIVE SALOON ❧

SECOND FLOOR



✂ BEEHIVE SALOON *✂*

SECOND FLOOR



~ BEEHIVE SALOON *~*

SECOND FLOOR



❧ DONEY'S SALOON ❧



FRONTIER HOUSE

FIRST FLOOR

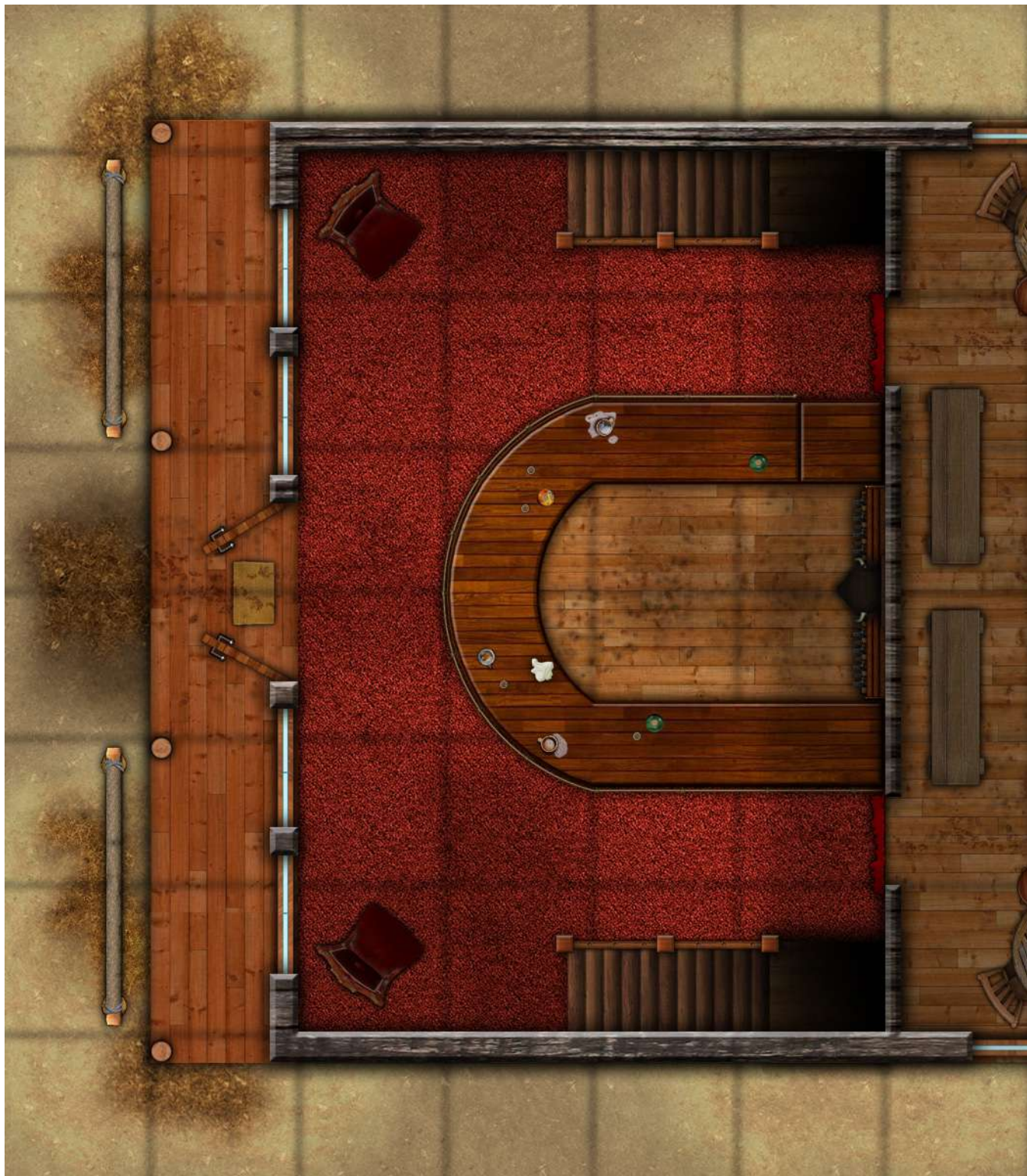

FRONTIER HOUSE

FIRST FLOOR

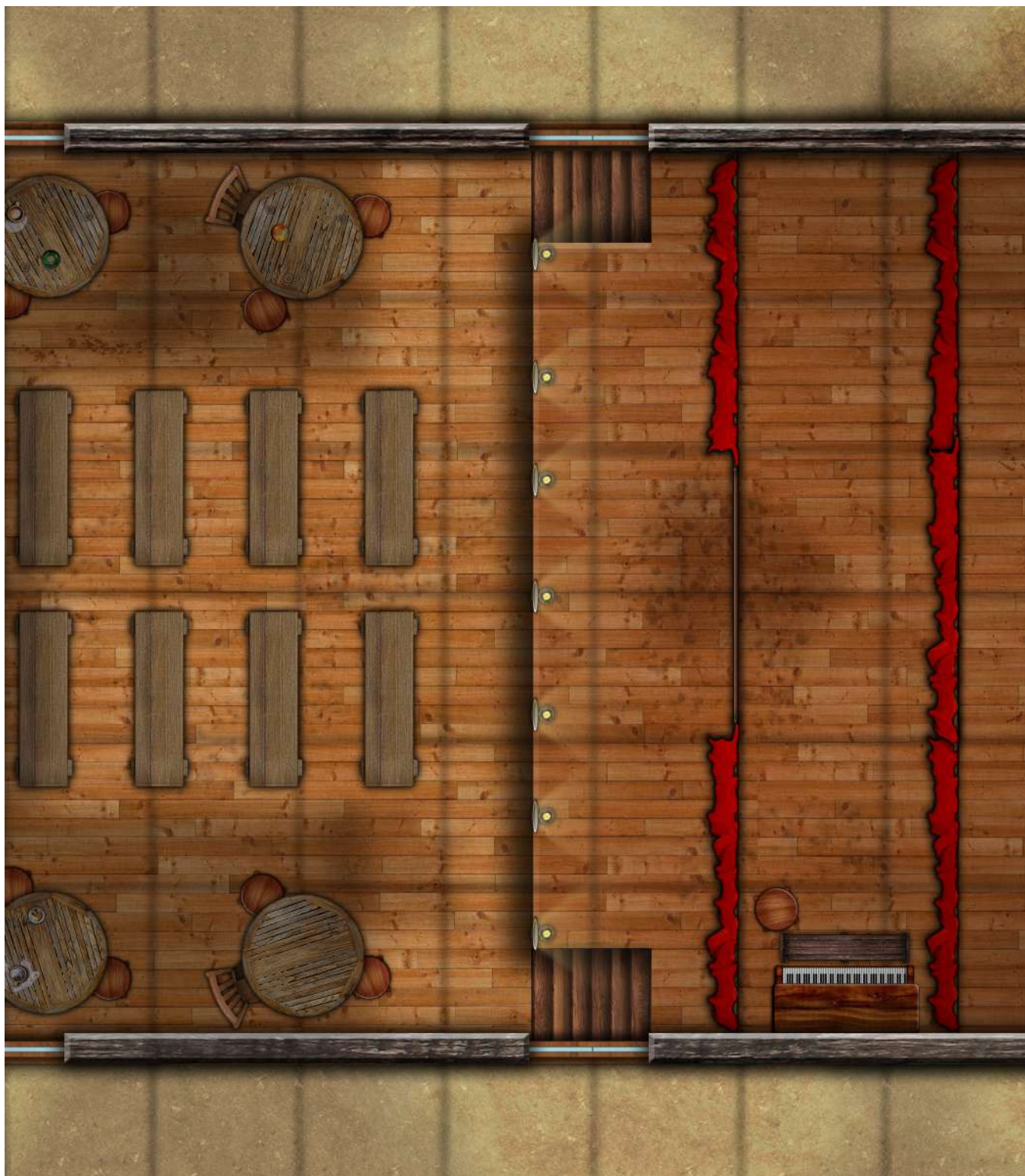

FRONTIER HOUSE

SECOND FLOOR

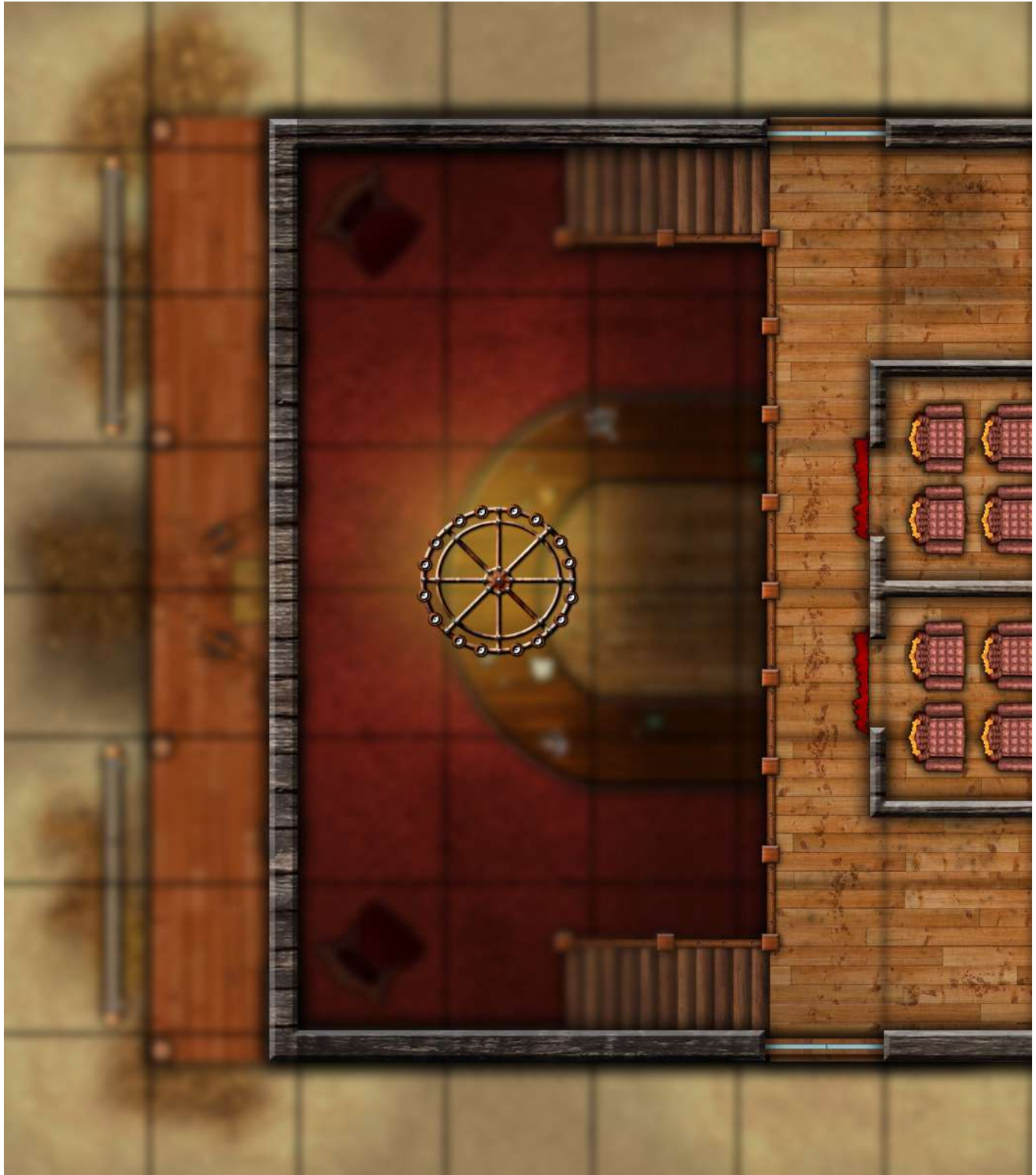

FRONTIER HOUSE

SECOND FLOOR

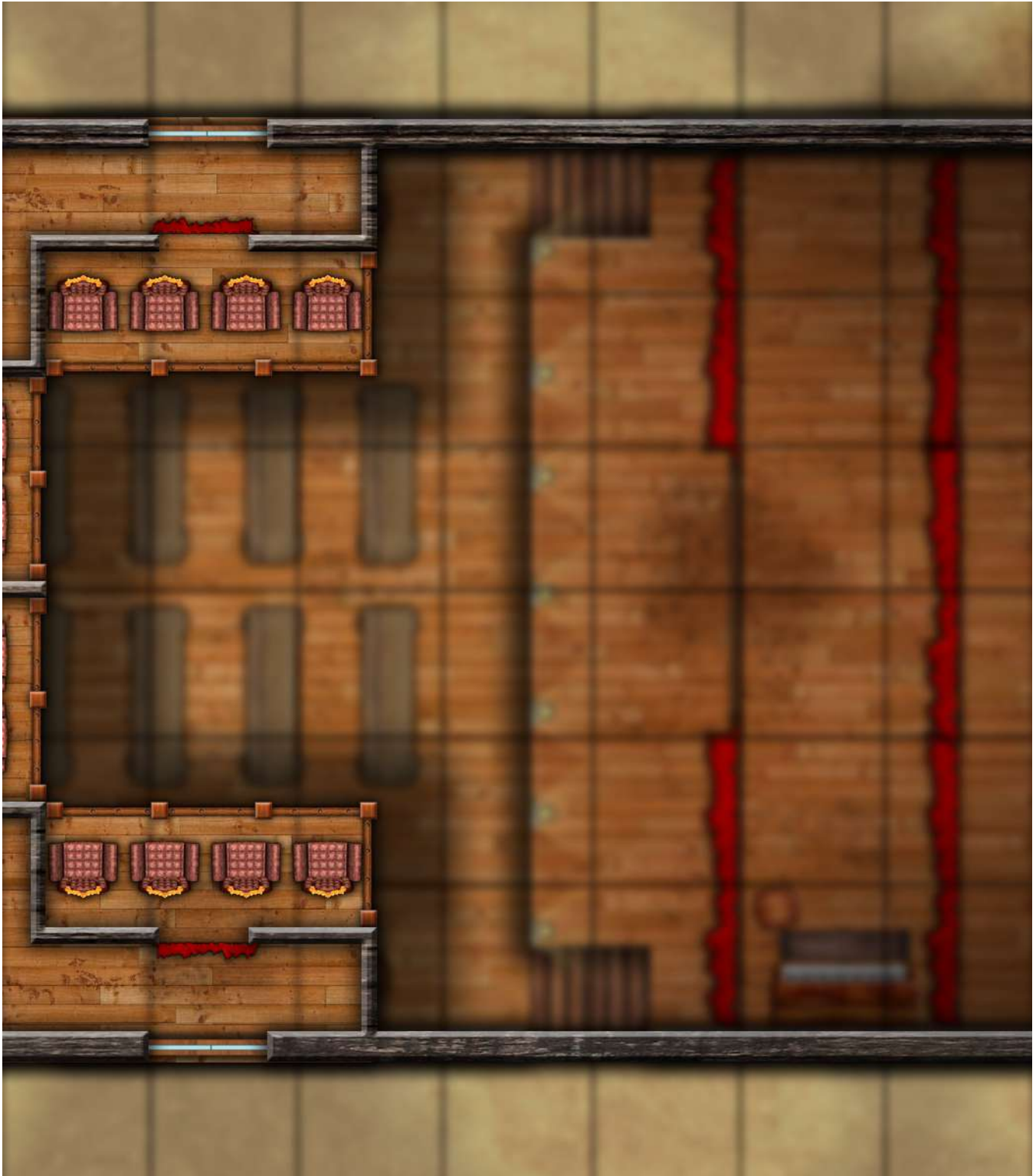

FRONTIER HOUSE

FIRST FLOOR & SECOND FLOOR

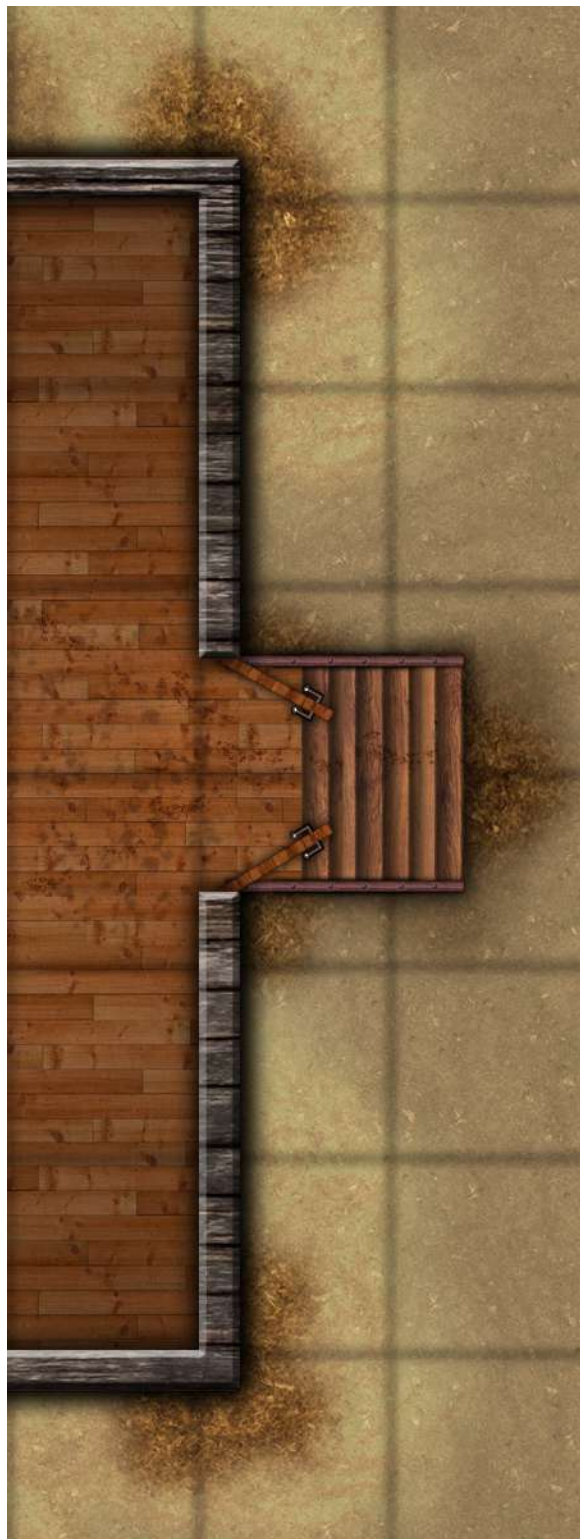

PLANTERS HOTEL

FIRST FLOOR

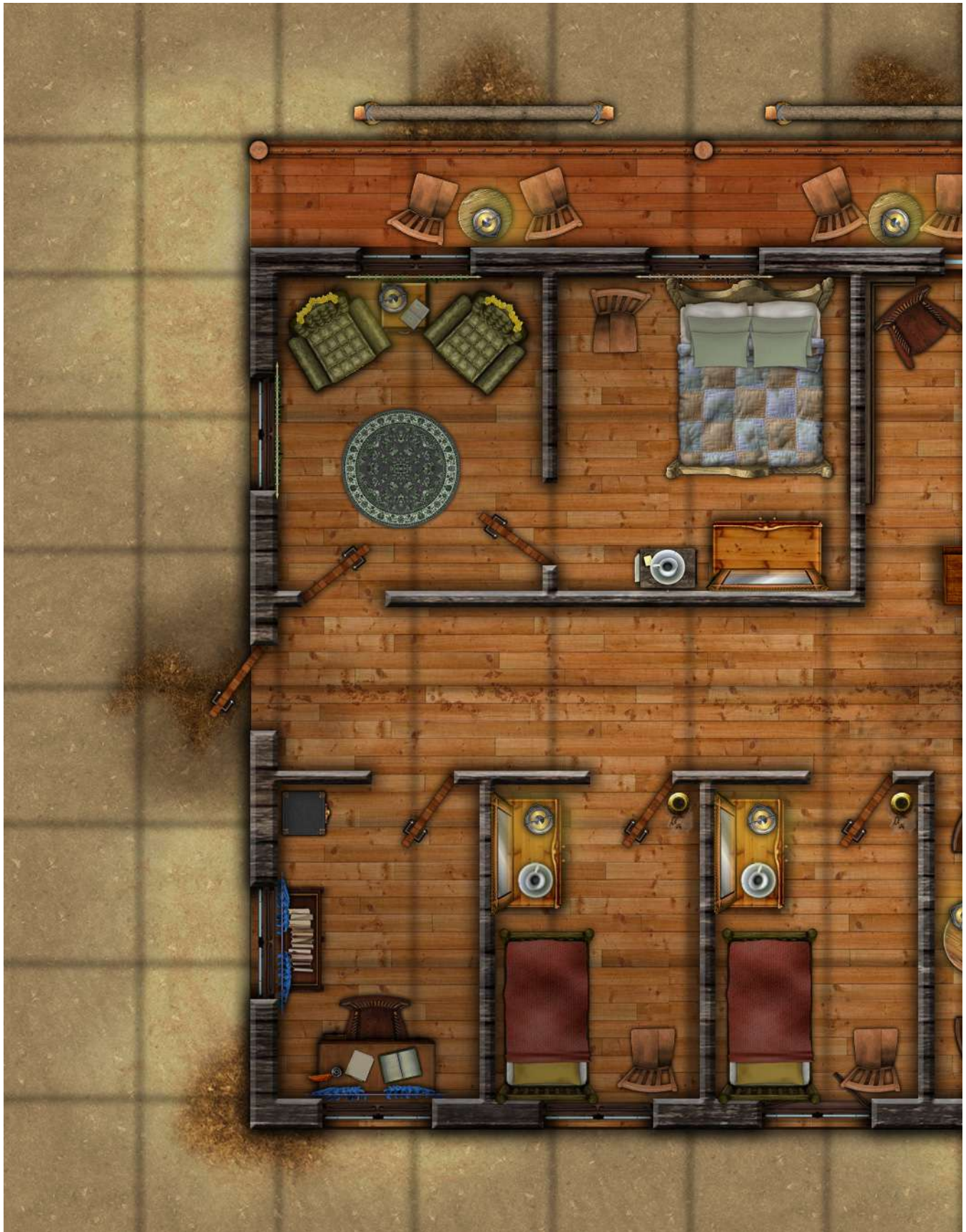

PLANTERS HOTEL

FIRST FLOOR

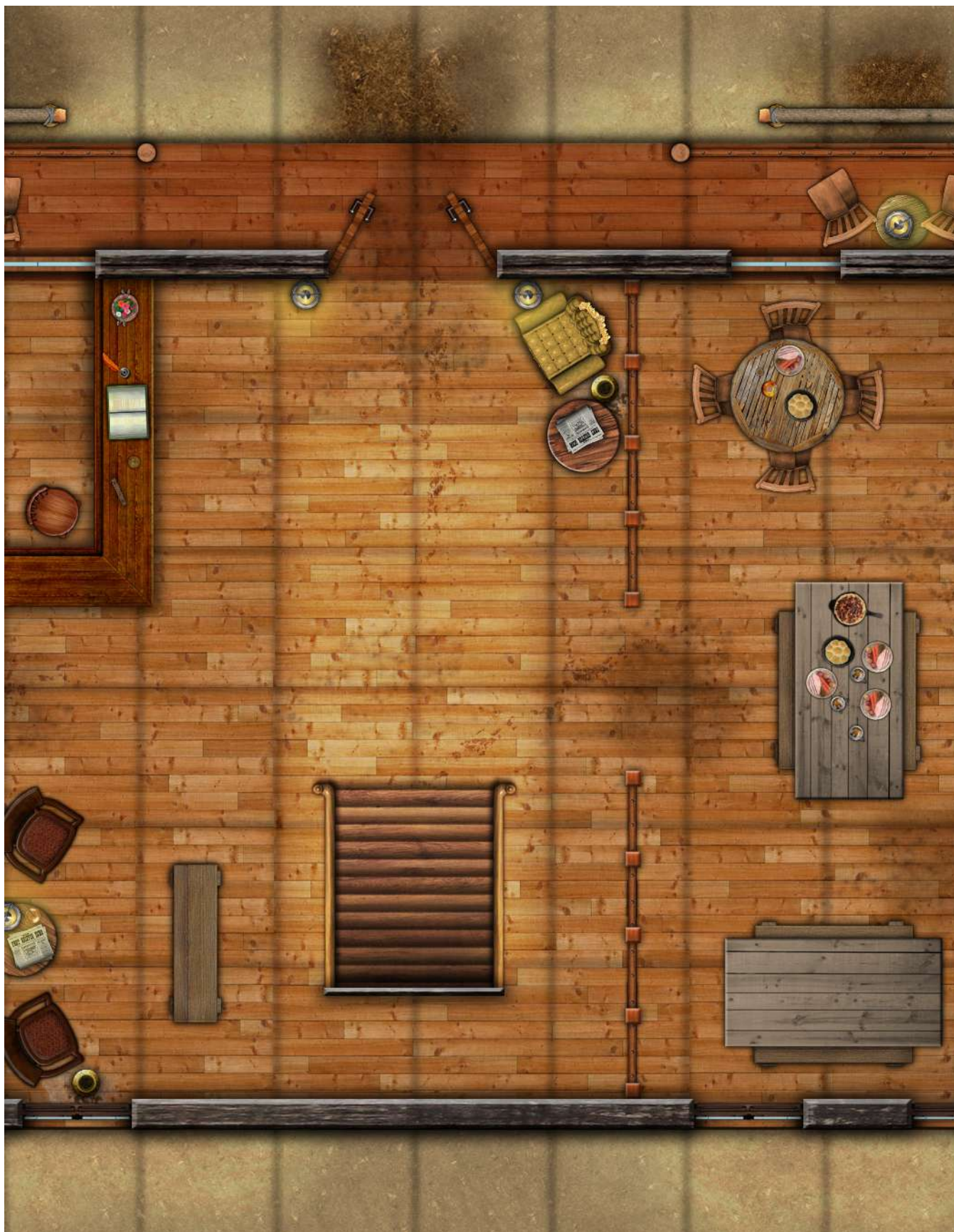

PLANTERS HOTEL

FIRST FLOOR

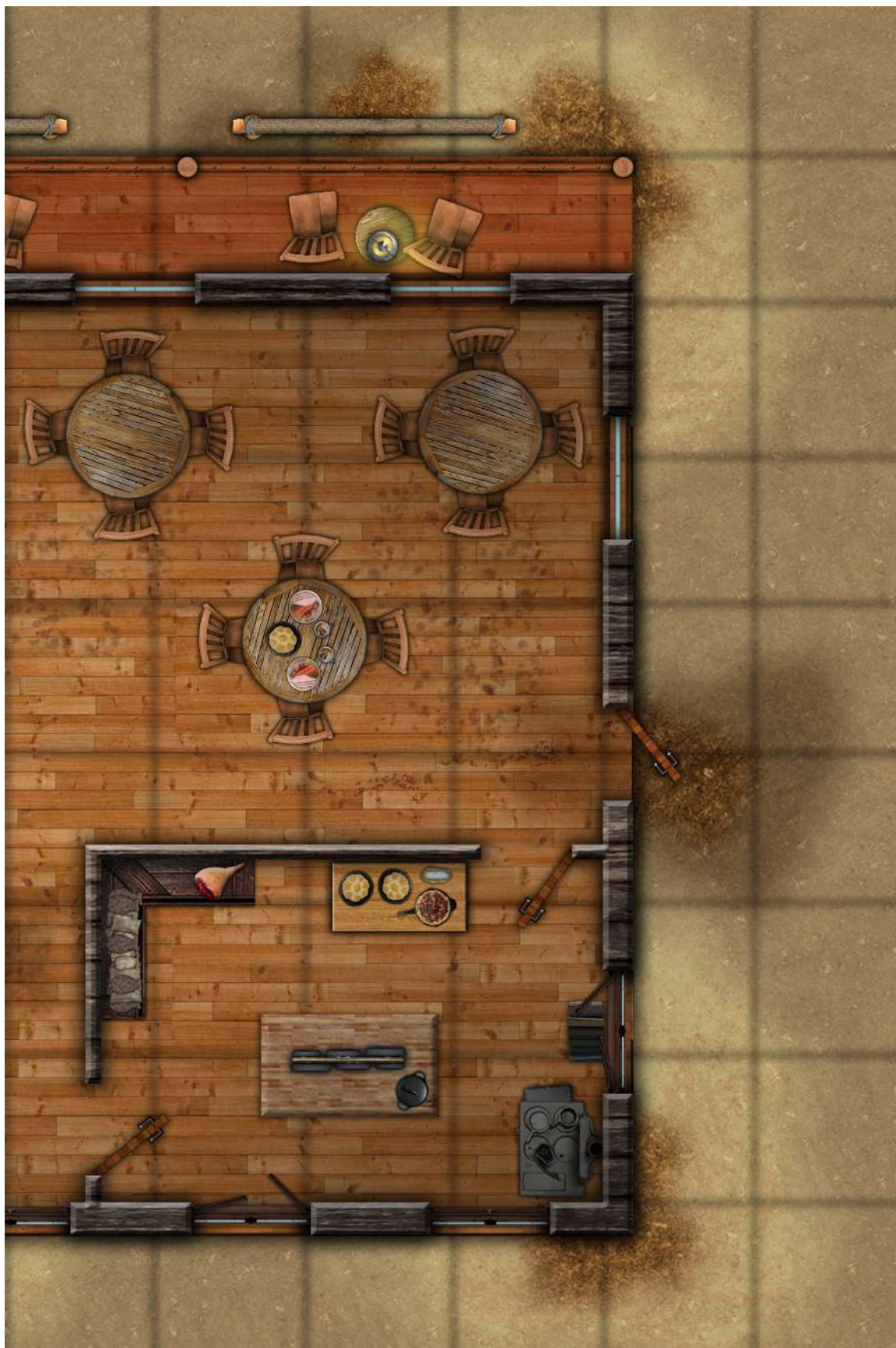

PLANTERS HOTEL

SECOND FLOOR



PLANTERS HOTEL

SECOND FLOOR



PLANTERS HOTEL

SECOND FLOOR







POST OFFICE AND DRUG STORE

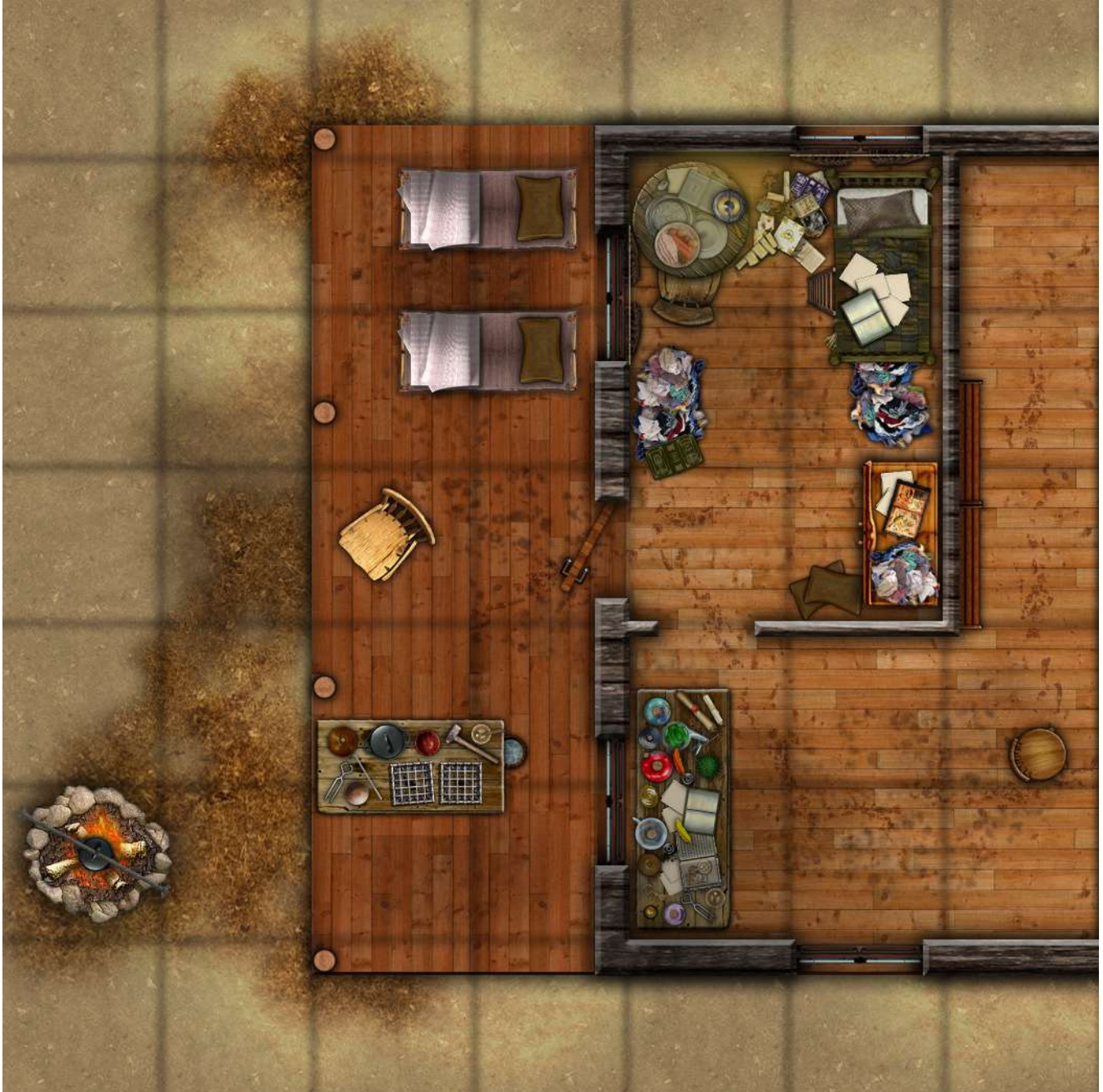

POST OFFICE AND DRUG STORE

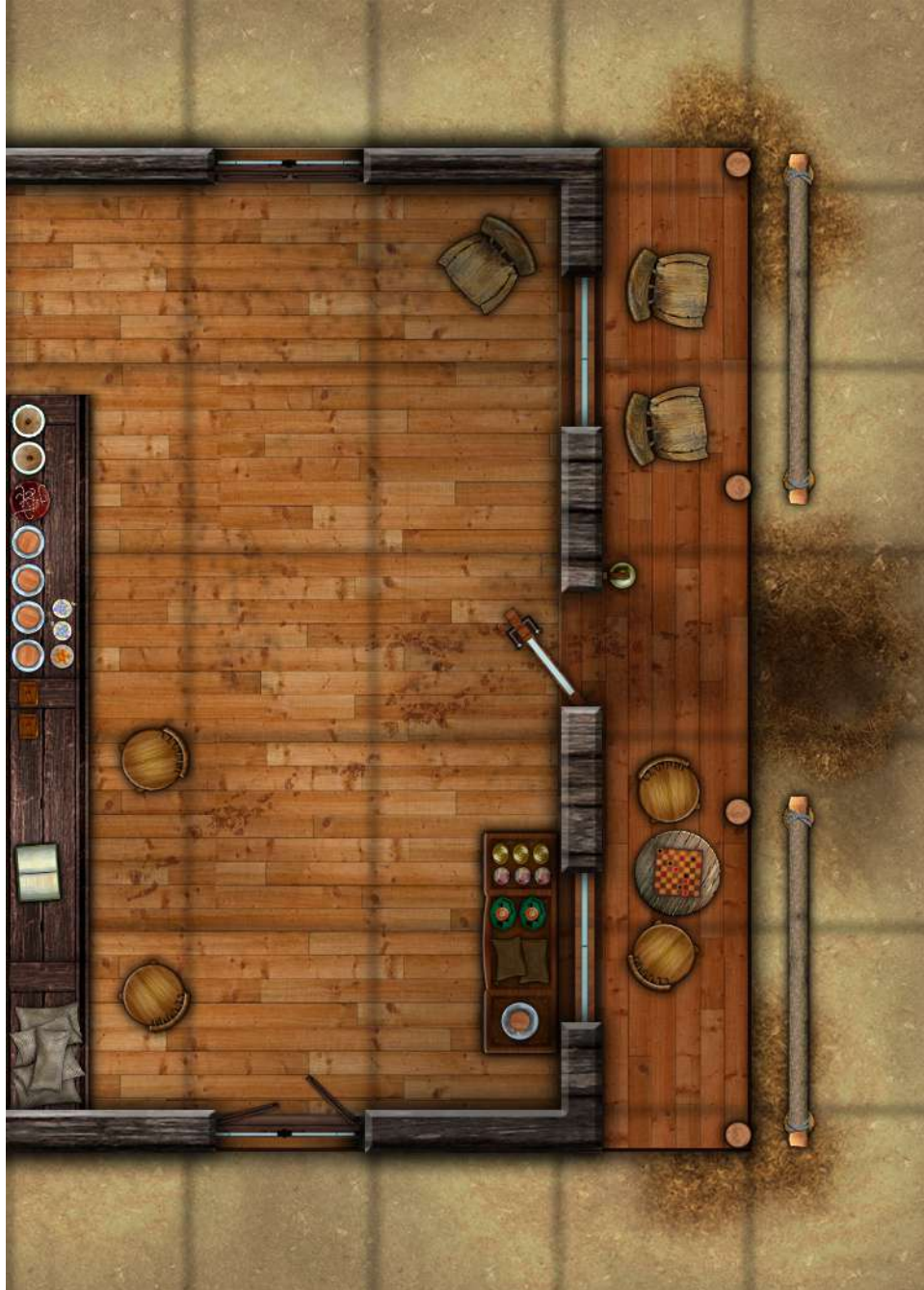

LOUIS WOOLFORM'S BAKERY



LOUIS WOOLFORM'S BAKERY



LOUIS WOOLFORM'S BAKERY

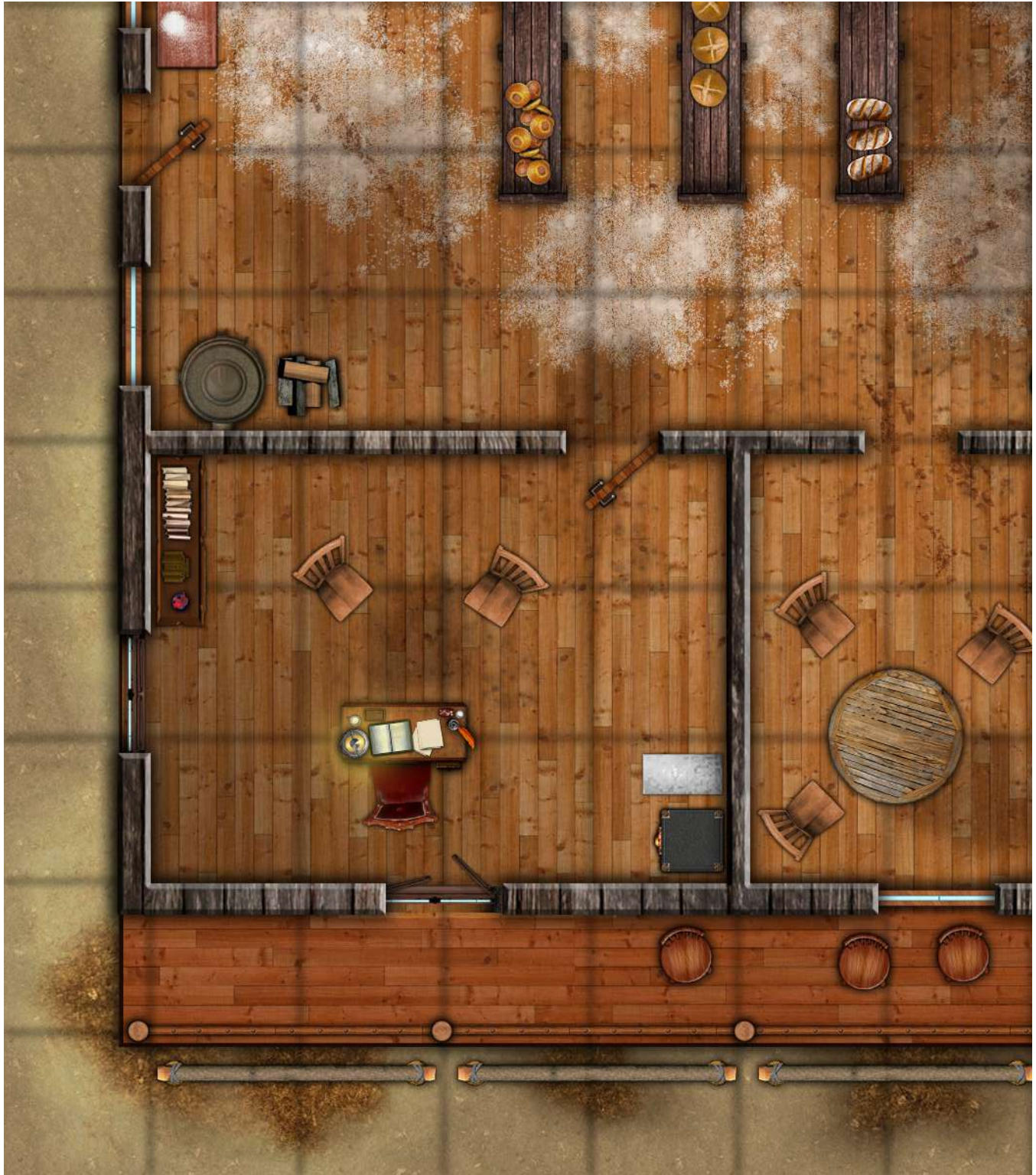

LOUIS WOOLFORM'S BAKERY

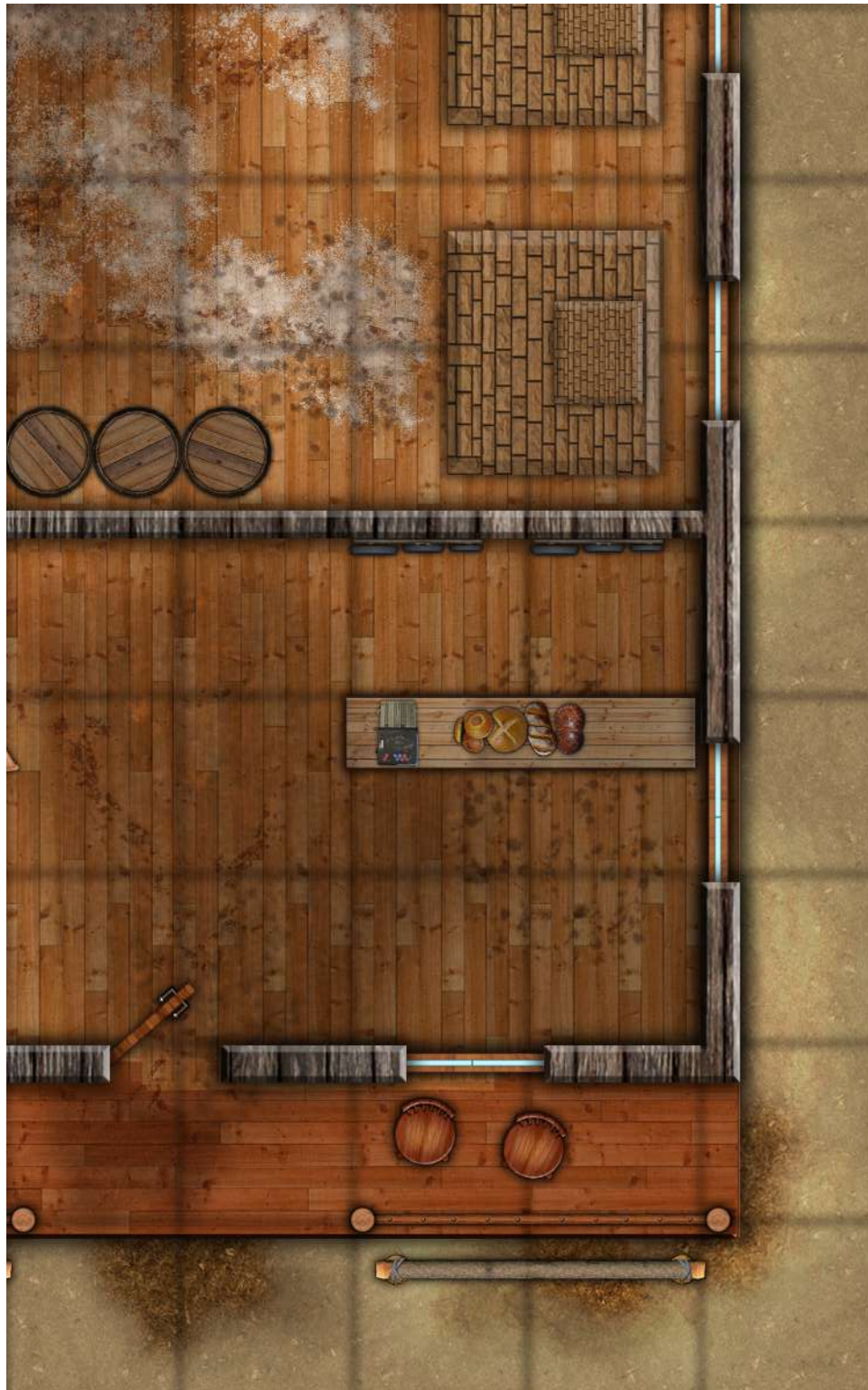

✧ P E T E H A V E R T Y ' S L I V E R Y ✧

F I R S T F L O O R

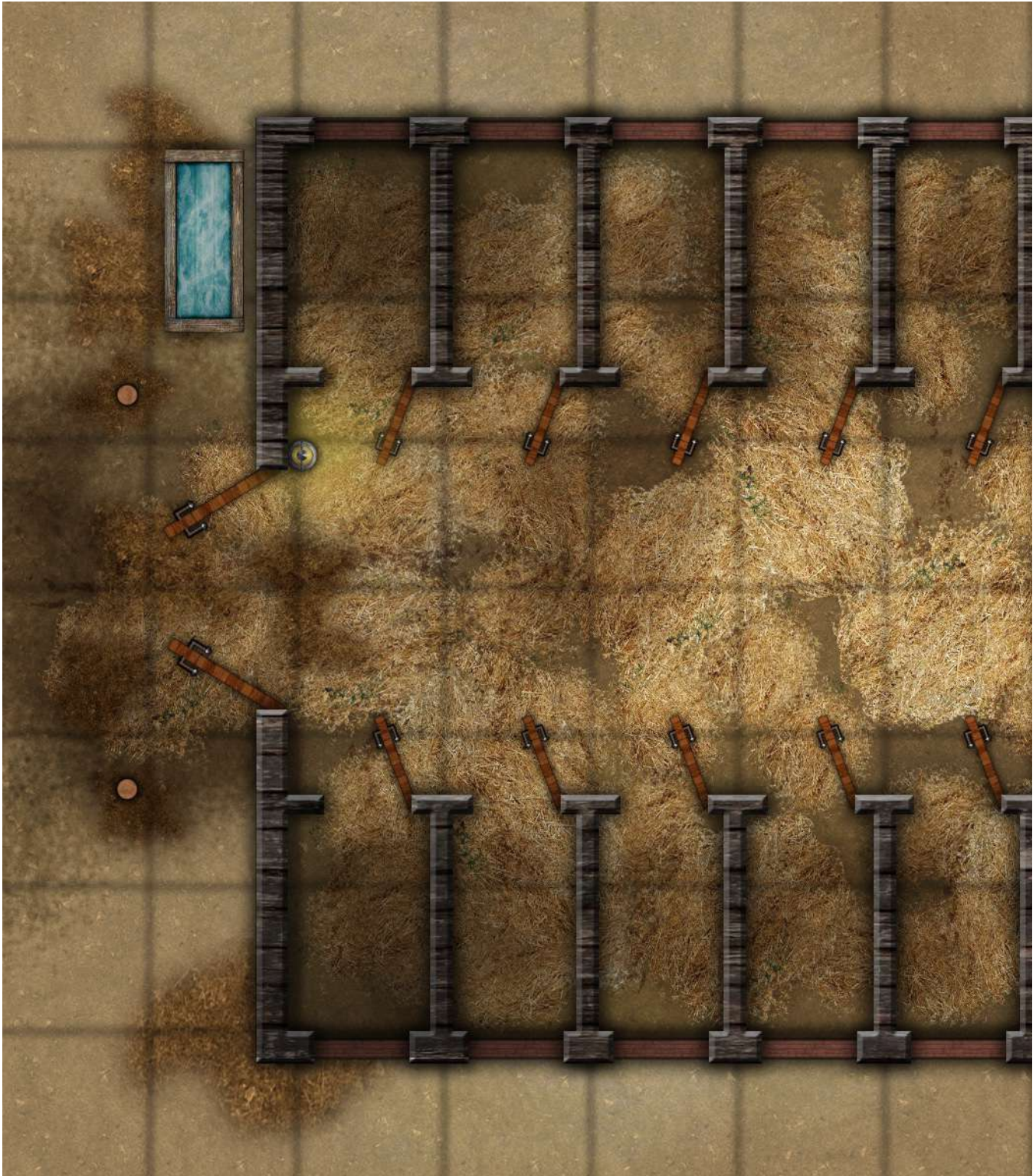

✂ PETE HAVERTY'S LIVERY ✂

FIRST FLOOR



✧ PETE HAVERTY'S LIVERY ✧

FIRST FLOOR

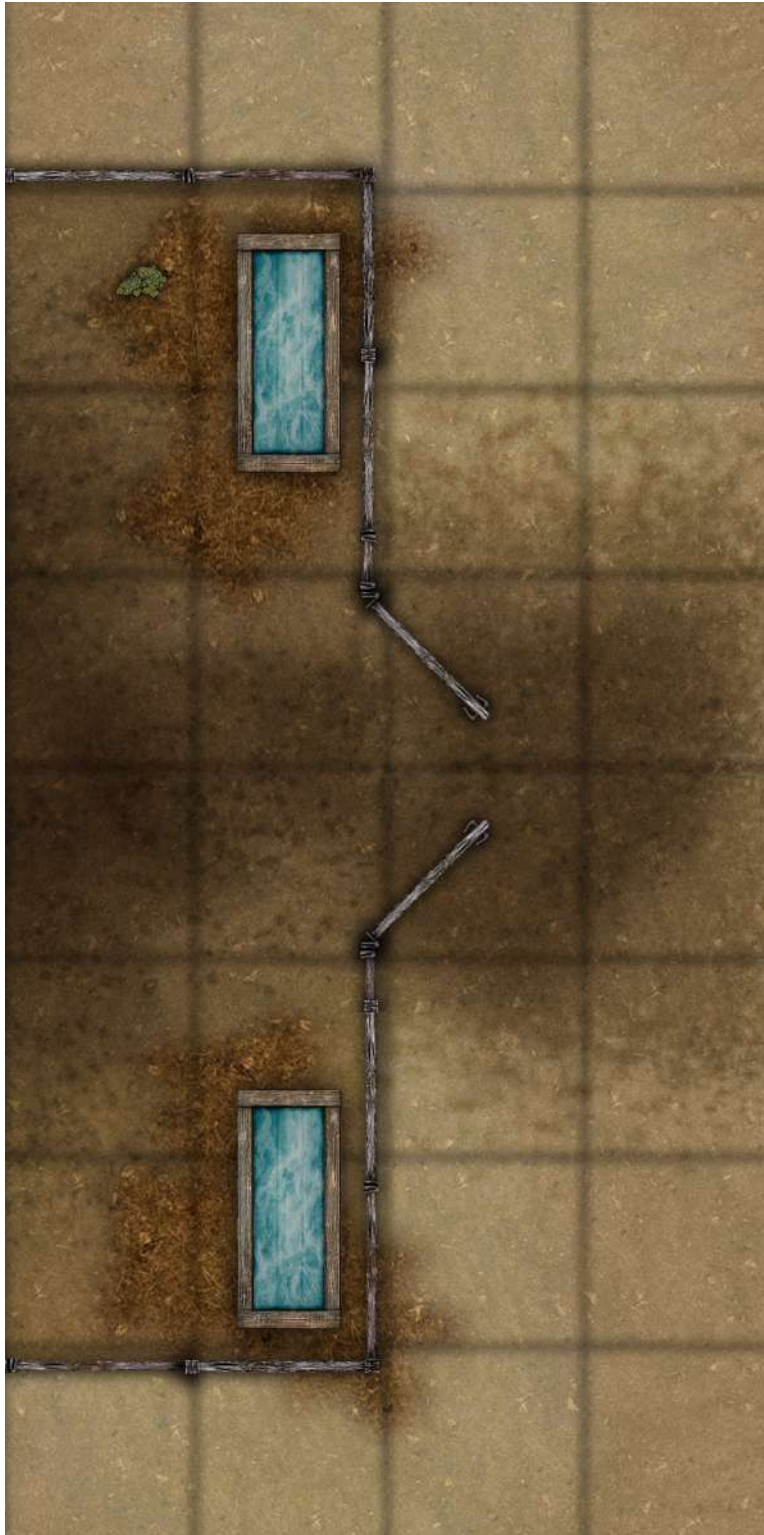

✂ PETE HAVERTY'S LIVERY ✂

SECOND FLOOR



P E T E H A V E R T Y ' S L I V E R Y

S E C O N D F L O O R



CHEN'S LAUNDRY

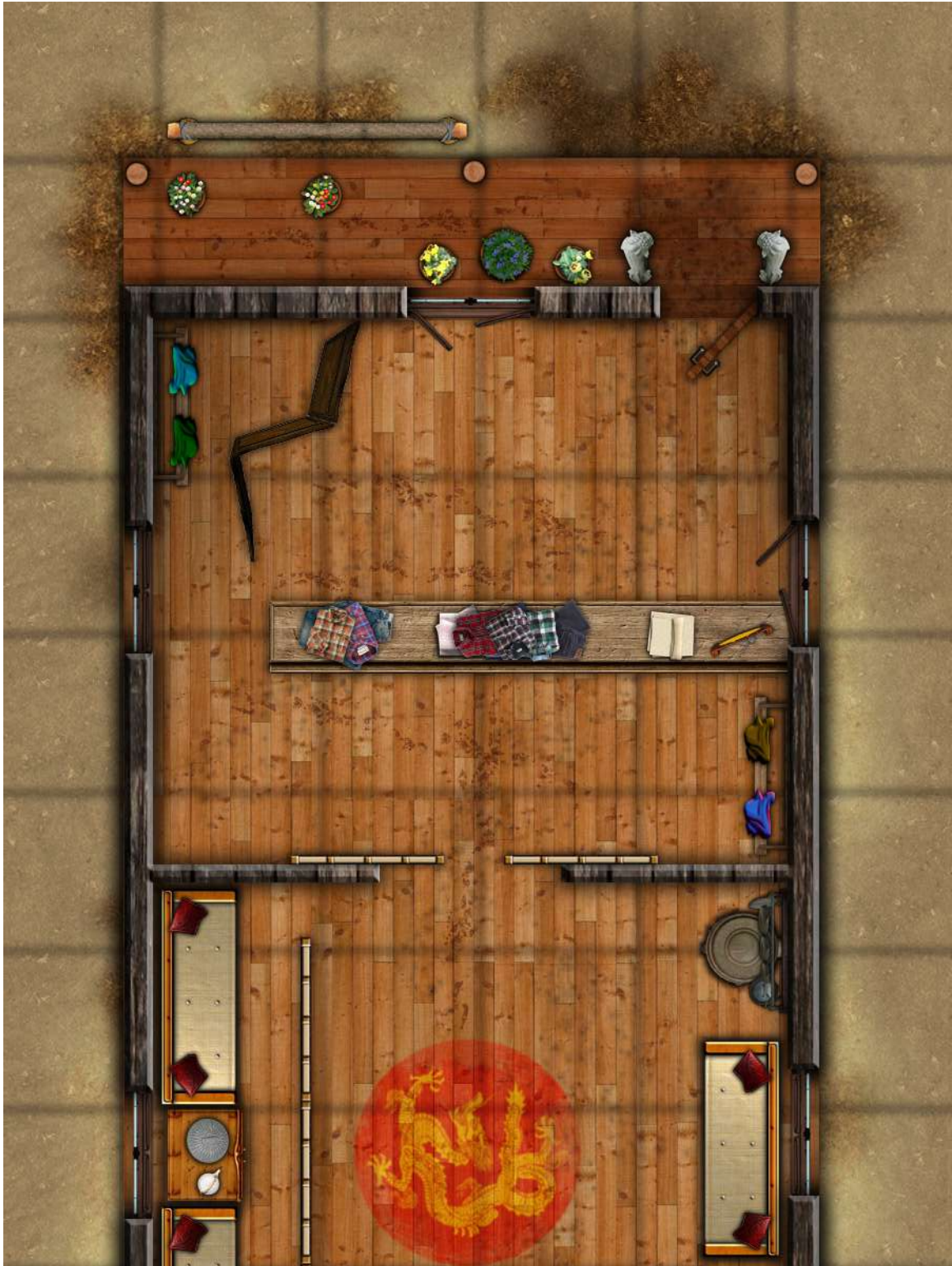

CHEN'S LAUNDRY



EARL'S SHAVE AND BATHE

FIRST FLOOR

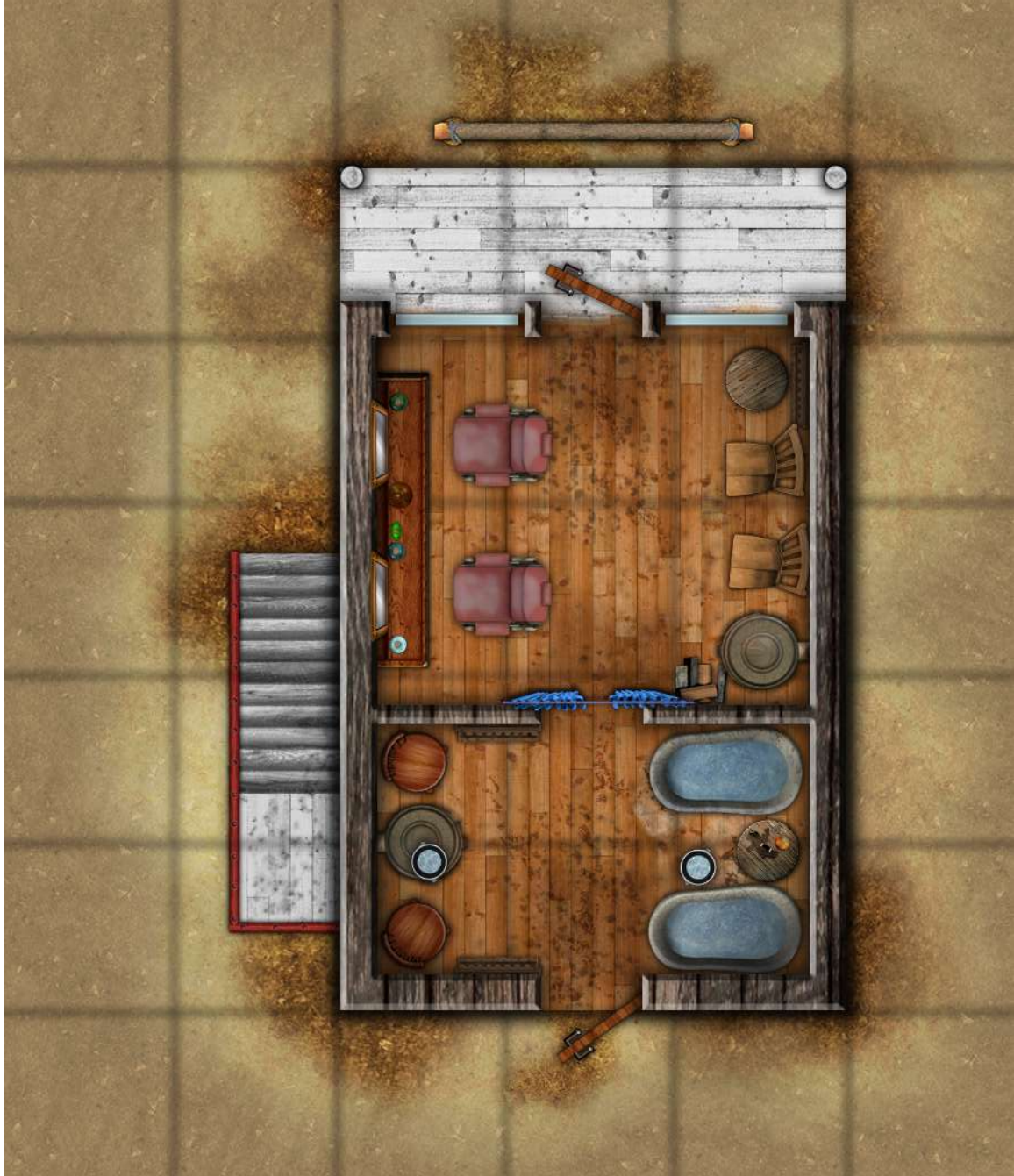

EARL'S SHAVE AND BATHE

SECOND FLOOR



CLAMPITT WAGON YARD

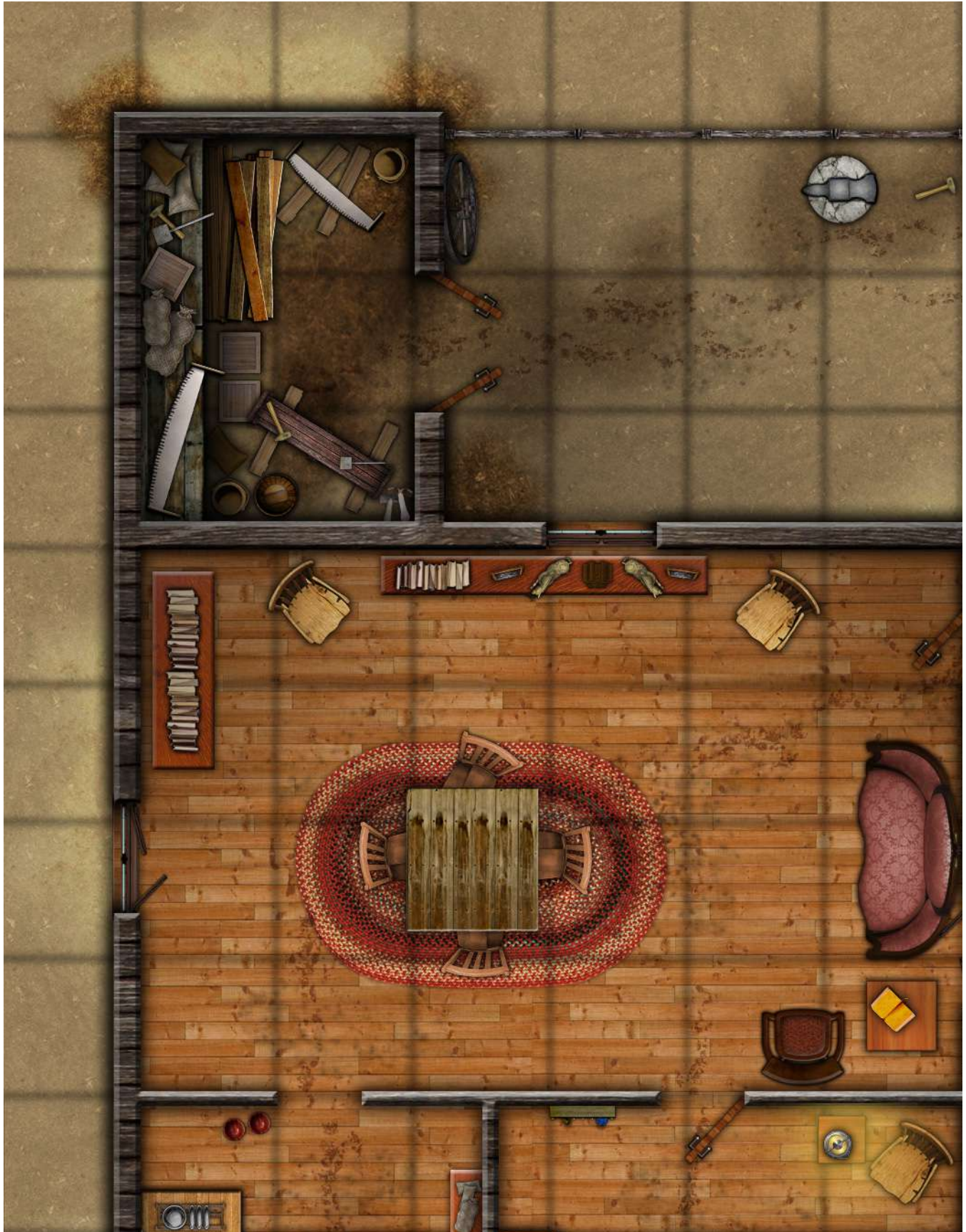

CLAMPITT WAGON YARD

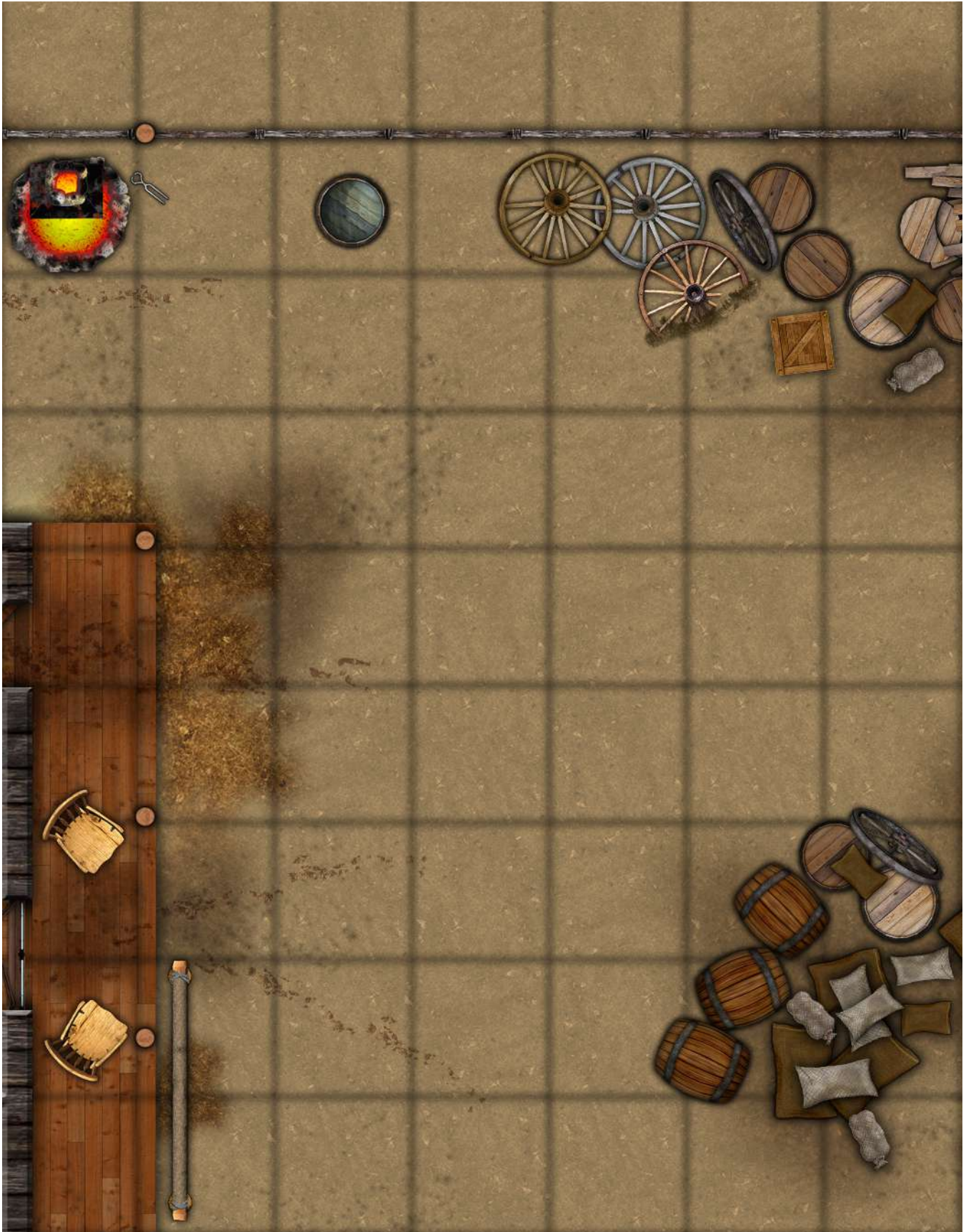

CLAMPITT WAGON YARD

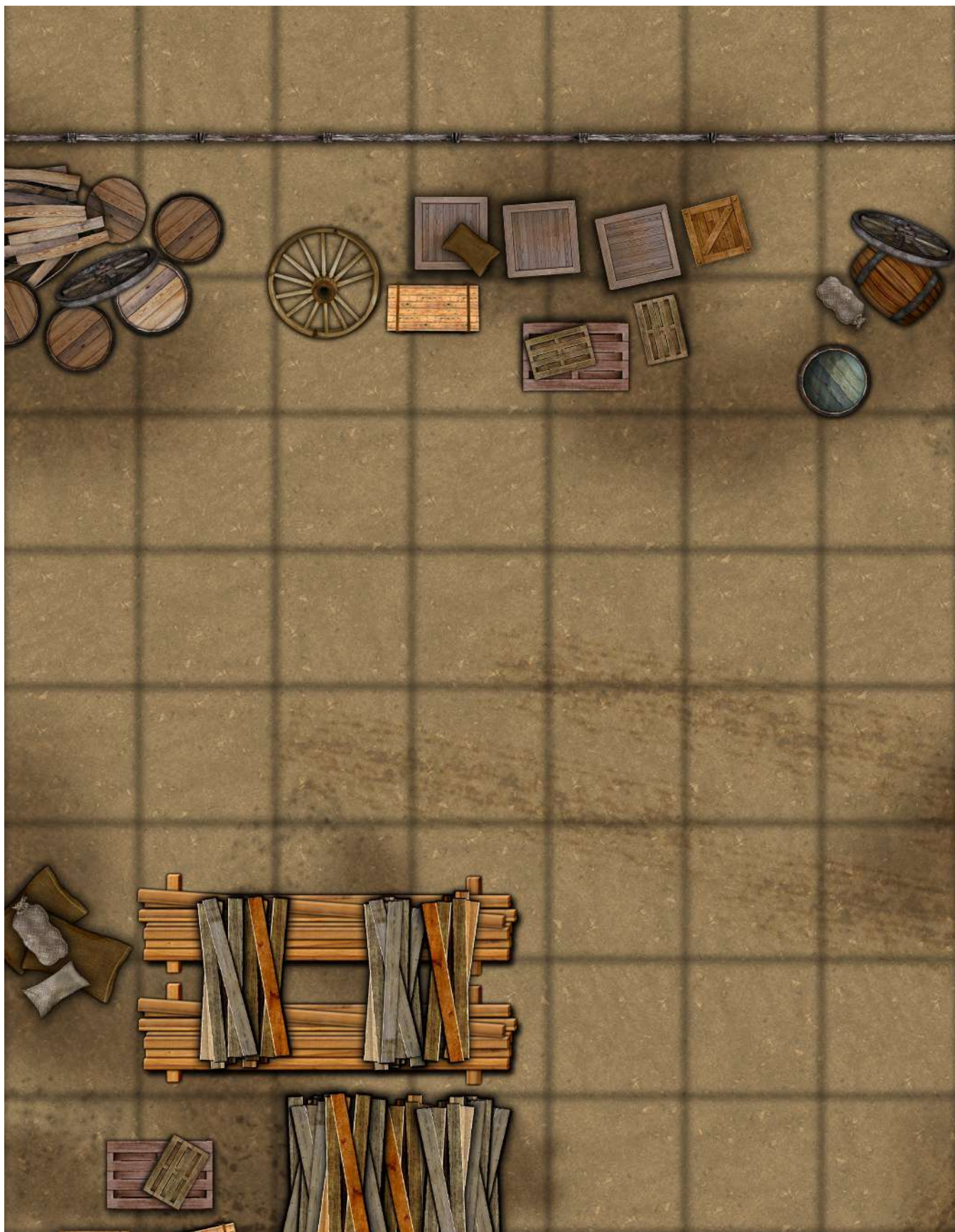

CLAMPITT WAGON YARD



CLAMPITT WAGON YARD



CLAMPITT WAGON YARD



CLAMPITT WAGON YARD



CLAMPITT WAGON YARD



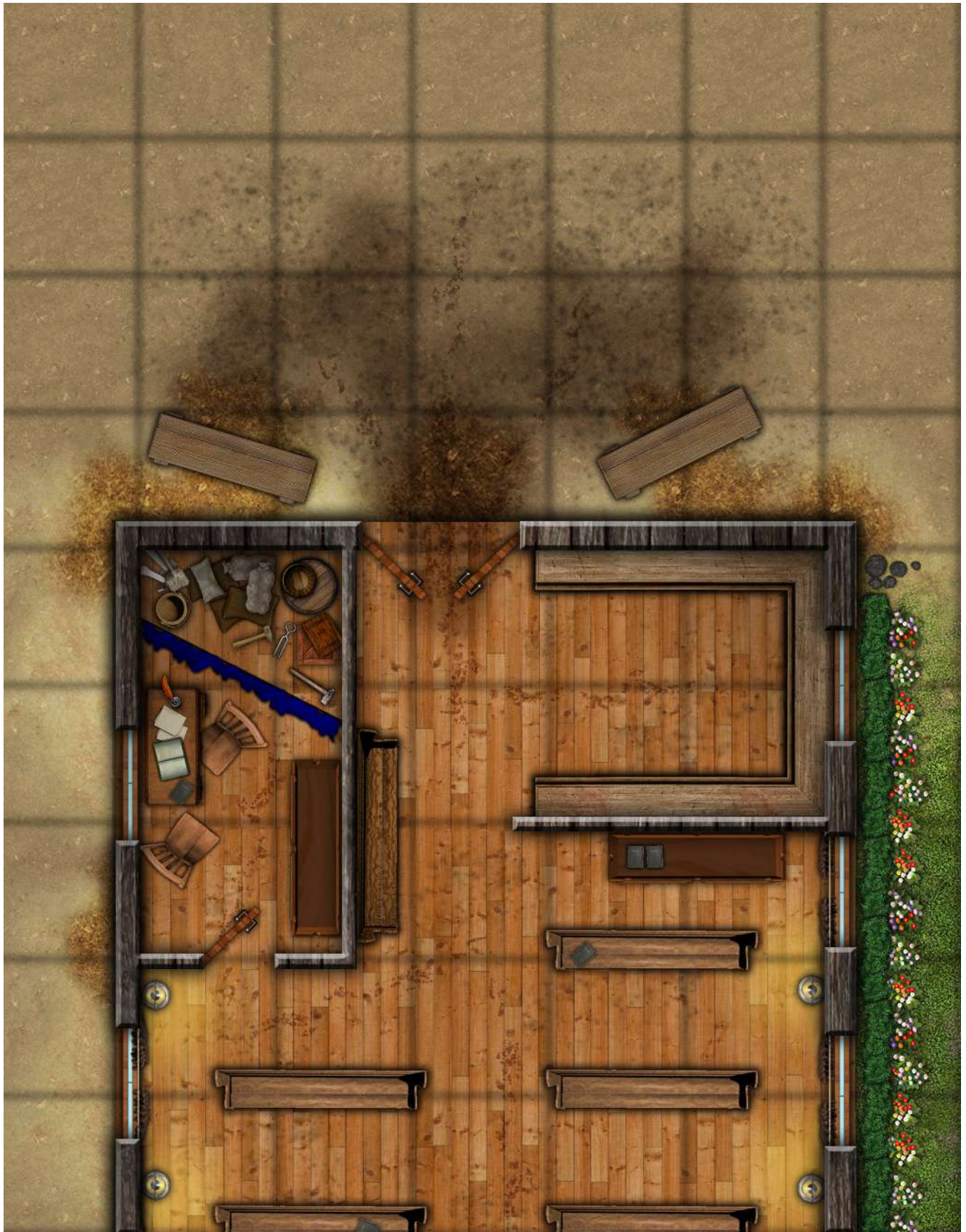

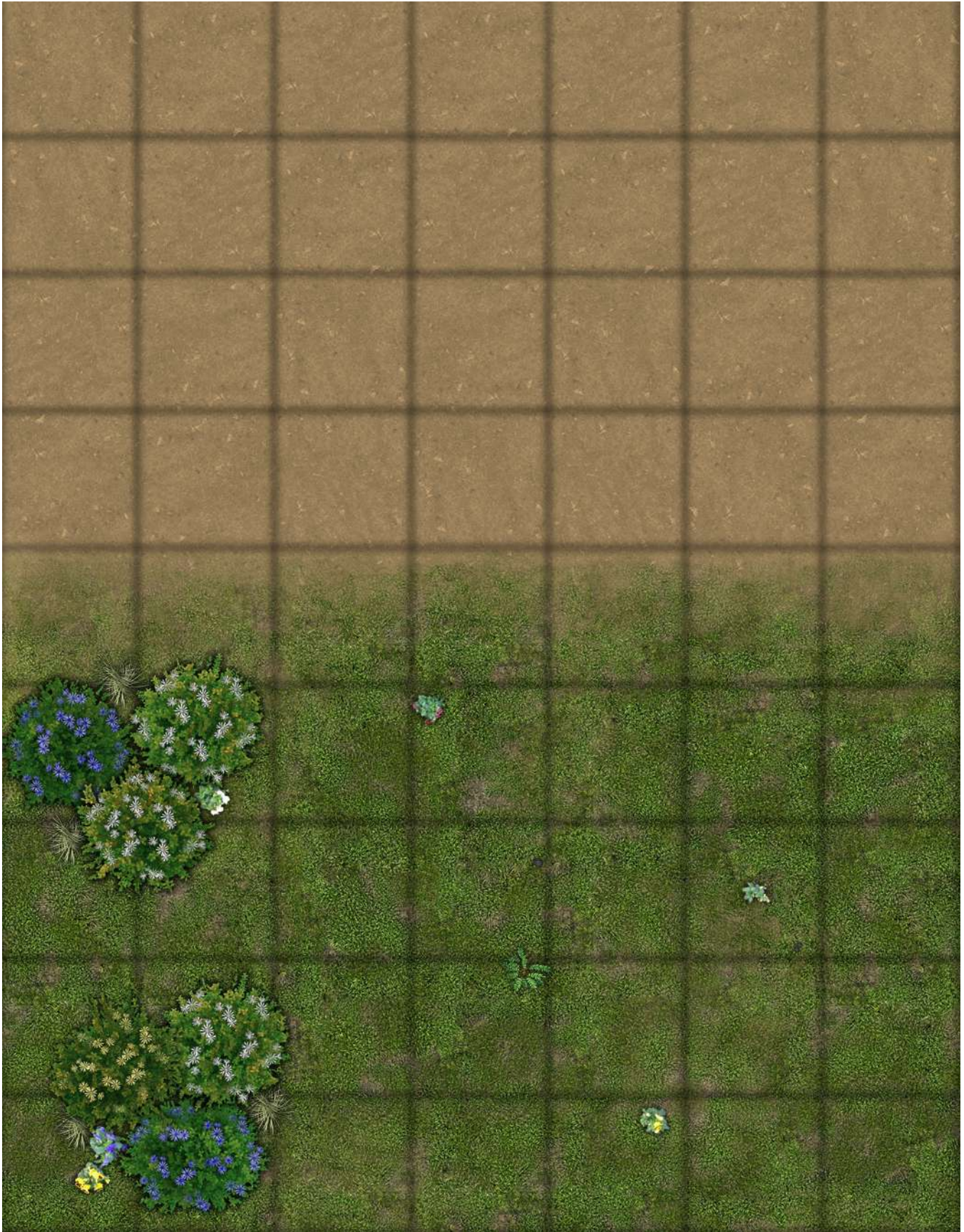





AFRICAN METHODIST EPISCOPAL CHURCH

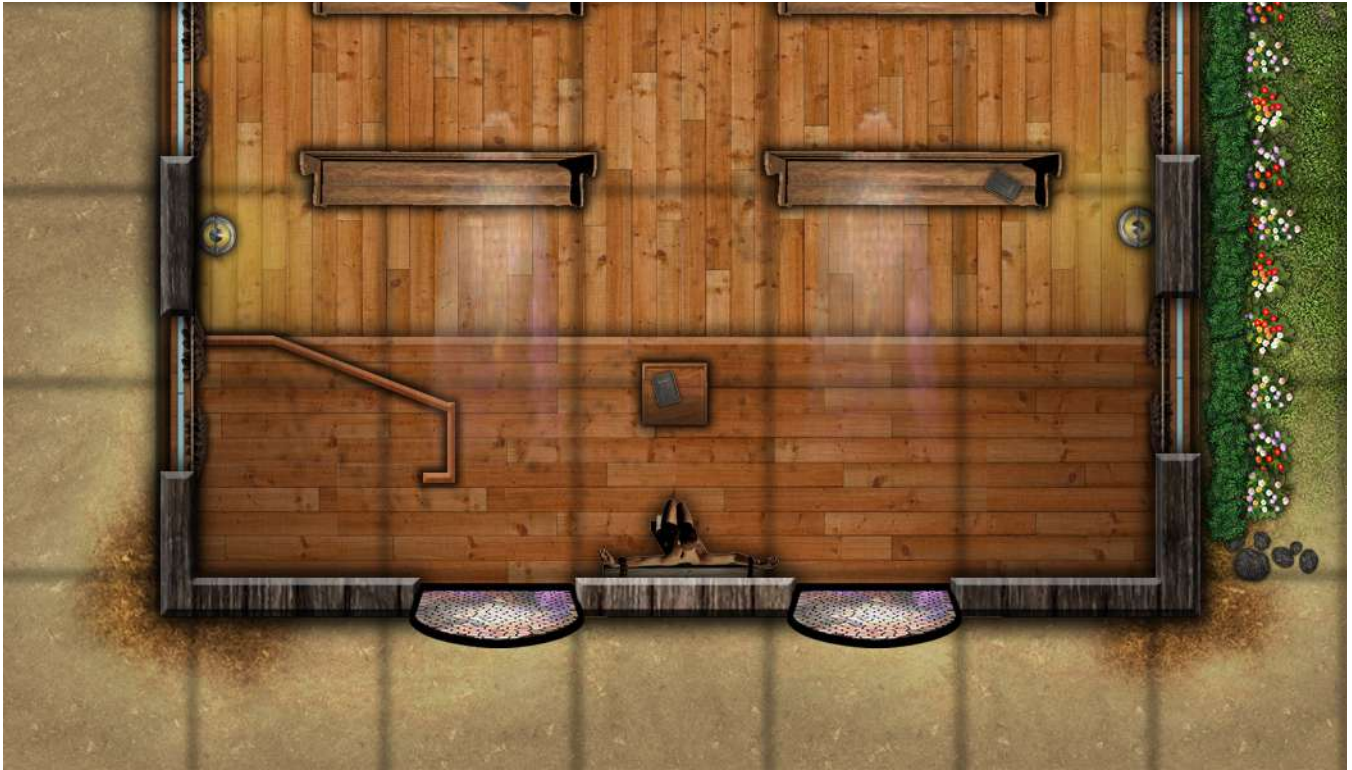



DOC CULVER'S

FIRST FLOOR



DOC CULVER'S

FIRST FLOOR

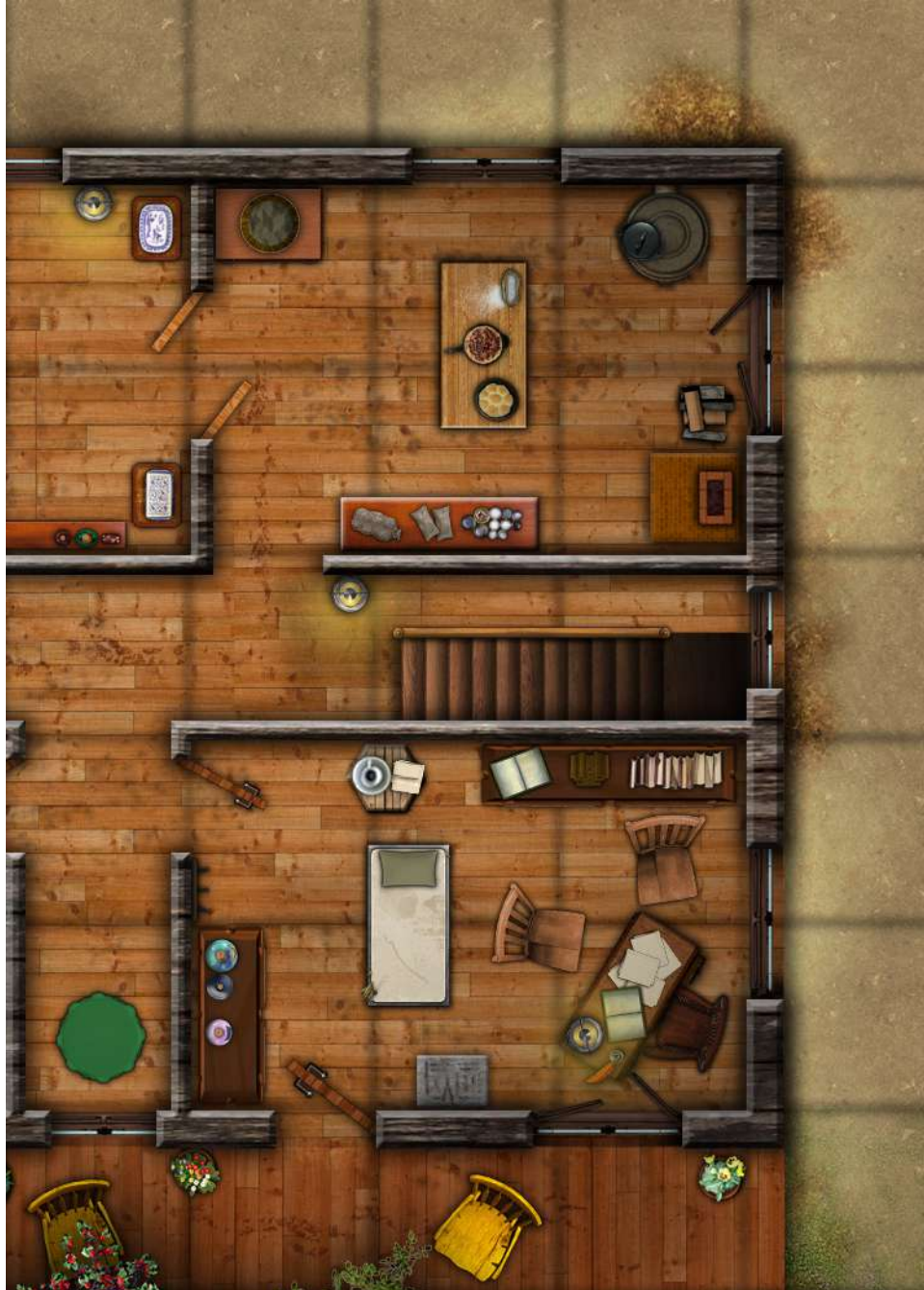

DOC CULVER'S

FIRST FLOOR



DOC CULVER'S

SECOND FLOOR



DOC CULVER'S

SECOND FLOOR



DOC CULVER'S

SECOND FLOOR

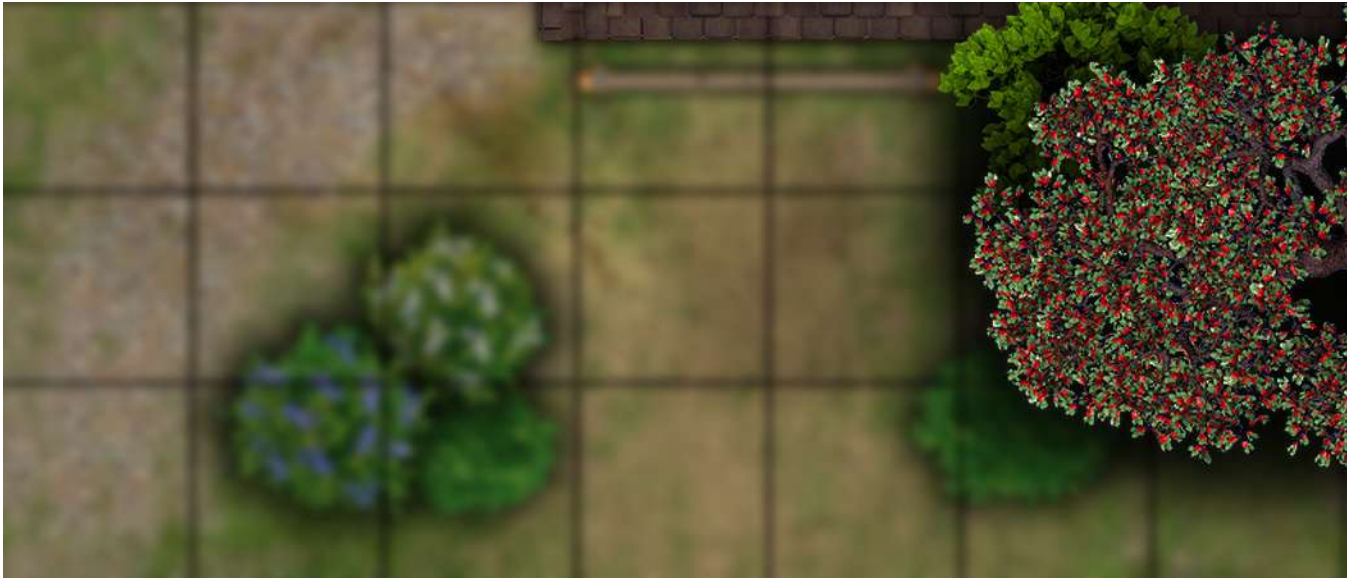

F. B. YORK'S BANK

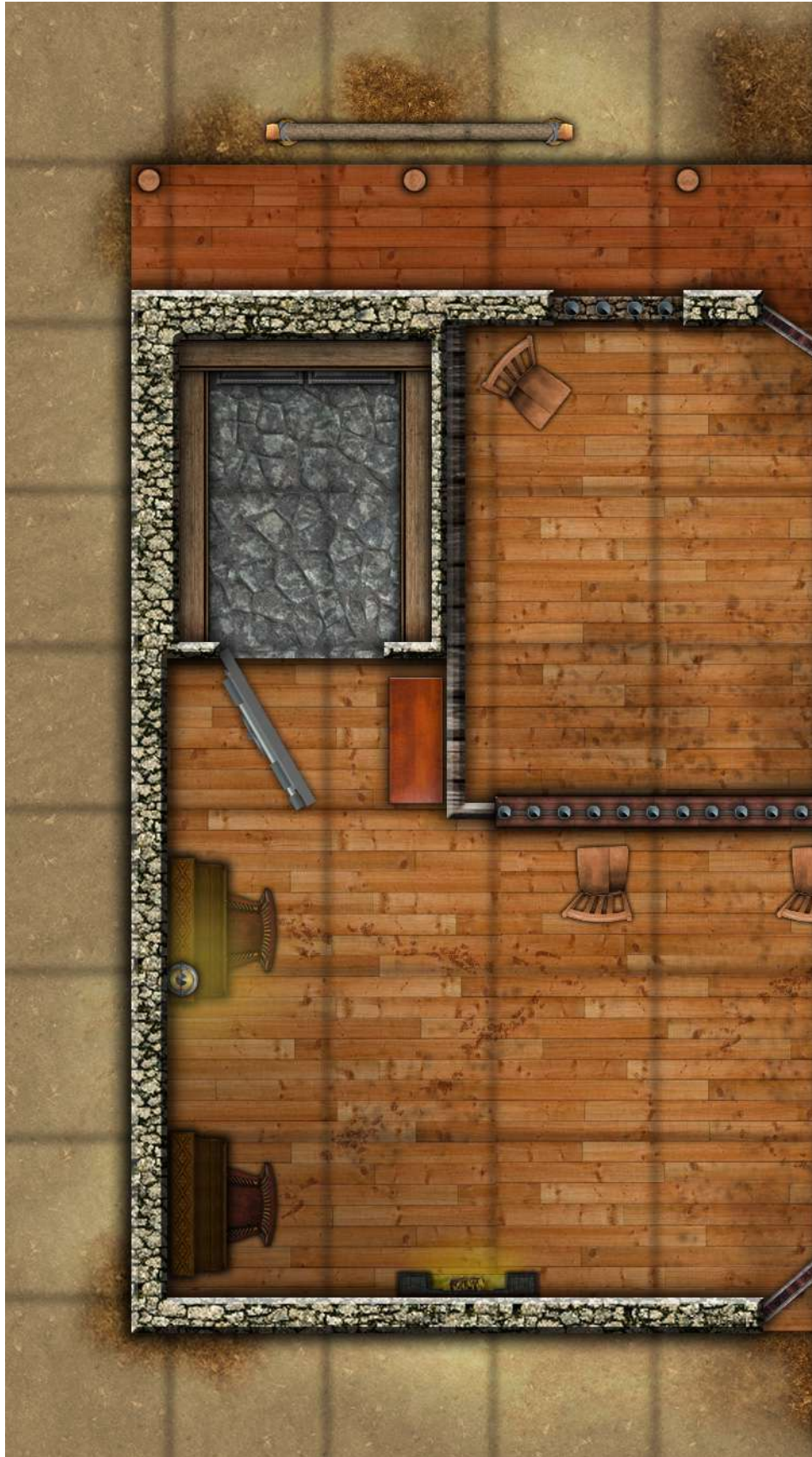

F. B. YORK'S BANK



THORP BLACKSMITH

FIRST FLOOR



THORP BLACKSMITH

FIRST FLOOR



THORP BLACKSMITH

FIRST FLOOR

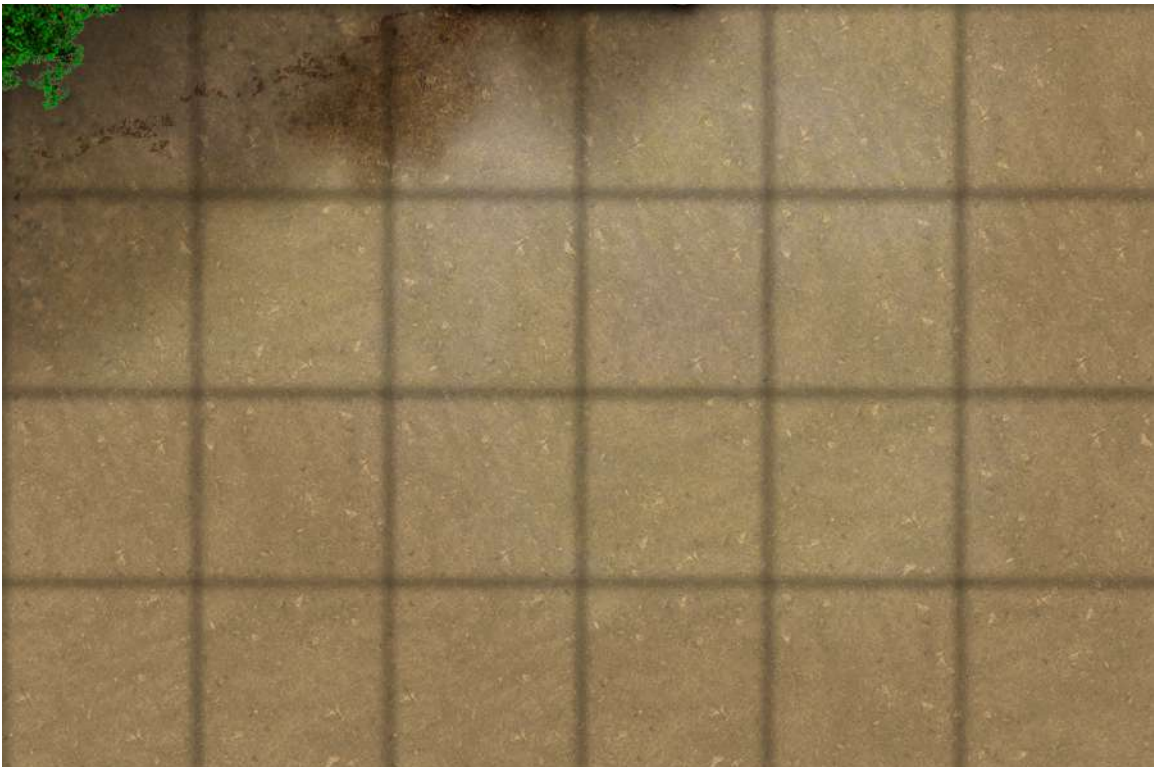

THORP BLACKSMITH

SECOND FLOOR



FORT GRIFFIN JAIL (PICKET JAIL)

