



Squares are 10'x10' unless noted.

DUNGEON SIDE VIEW

1" = 20'

W

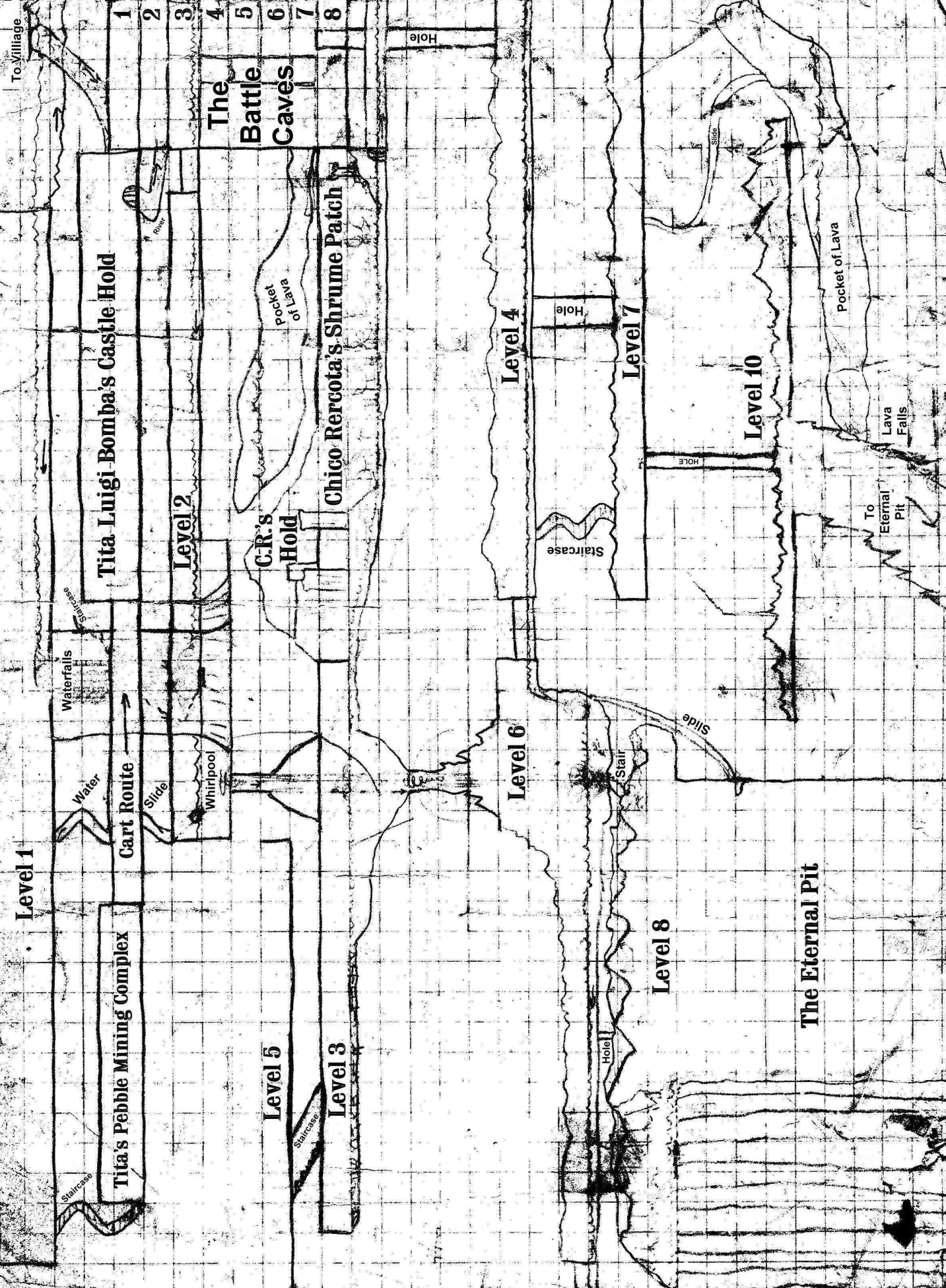

To Village

Tita Luigi Bomba's Castle Hold

Level 2

The Battle Caves

C.R.'s Hold

Chico Rercota's Shrumie Patch

Level 5

Level 3

Level 6

Level 4

Level 7

Level 8

Level 10

The Eternal Pit

Pocket of Lava

Lava Falls

To External Pit

Down to deeper mines

Up to riverbank
cave entrance
(winds 5 miles east)

Tita Luigi Bomba's Pebble Mining Complex

Up to
Level 1

1

3

2

4

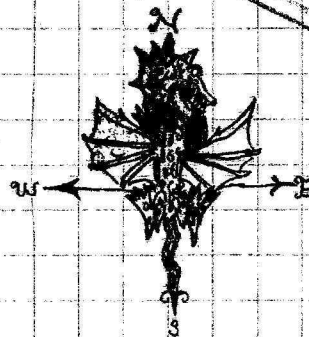

To Tita Luigi Bomba's Castle Hold →

To Tita Luigi
Bomba's Pebble
Mining Complex



Up to riverbank
cave entrance
(winds 5 miles east)

Caravan Branch

To Tita Luigi
Bomba's Pebble
Mining Complex

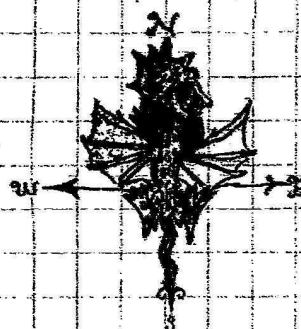

To Tita Luigi Bomba's Castle Hold →

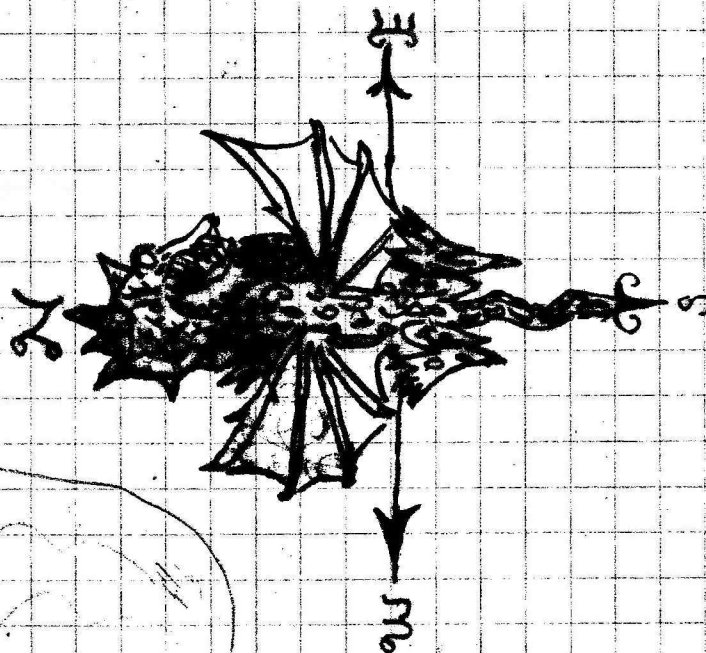

**Down to Tita Luigi Bomba's
Pebble Mining Complex**

(5 miles west, passage
bends westerly)

**Riverbank Entrance
to Tita Luigi Bomba's
Pebble Mining Complex**

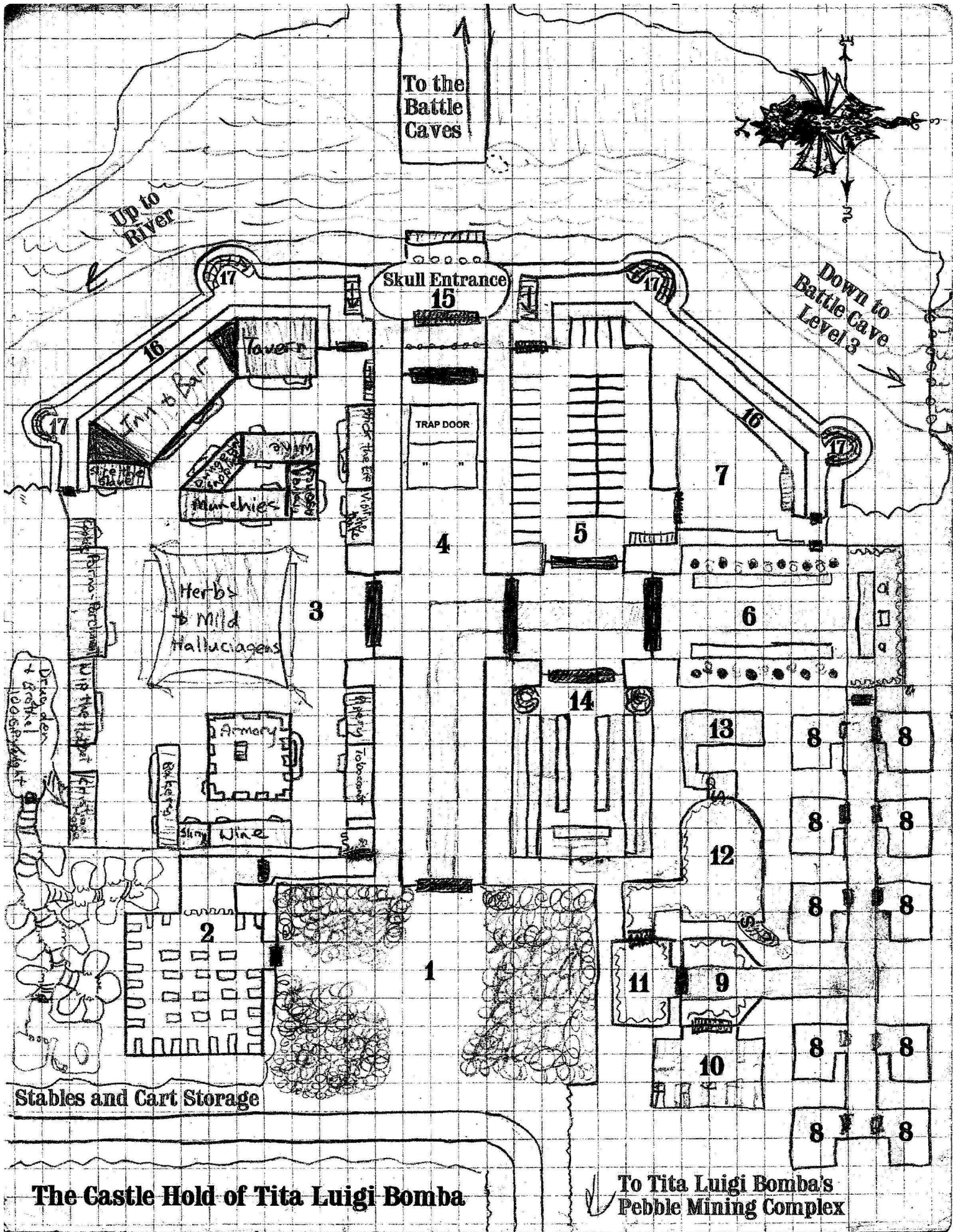

To the
Battle
Caves

Up to
River

Skull Entrance
15

Down to
Battle Cave
Level 3

TRAP DOOR

Herbs
to Mild
Hallucinations

Armory

Slimy Wine

Stables and Cart Storage

The Castle Hold of Tita Luigi Bomba

To Tita Luigi Bomba's
Pebble Mining Complex

THE BATTLE CAVES LEVELS 1, 2, 3, 4

(Dashed Lines " - - - " Indicate Up Direction)

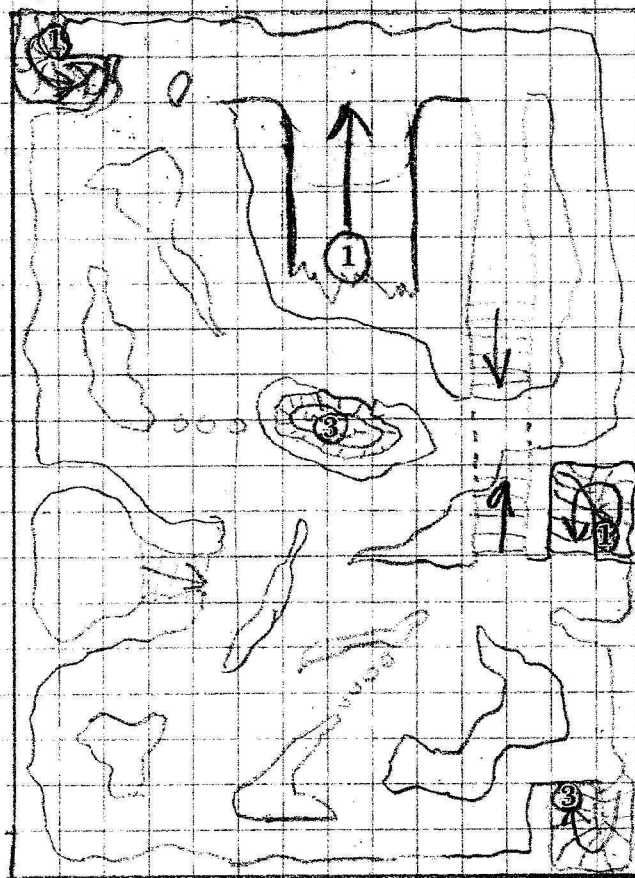

Battle Caves Lvl. 2

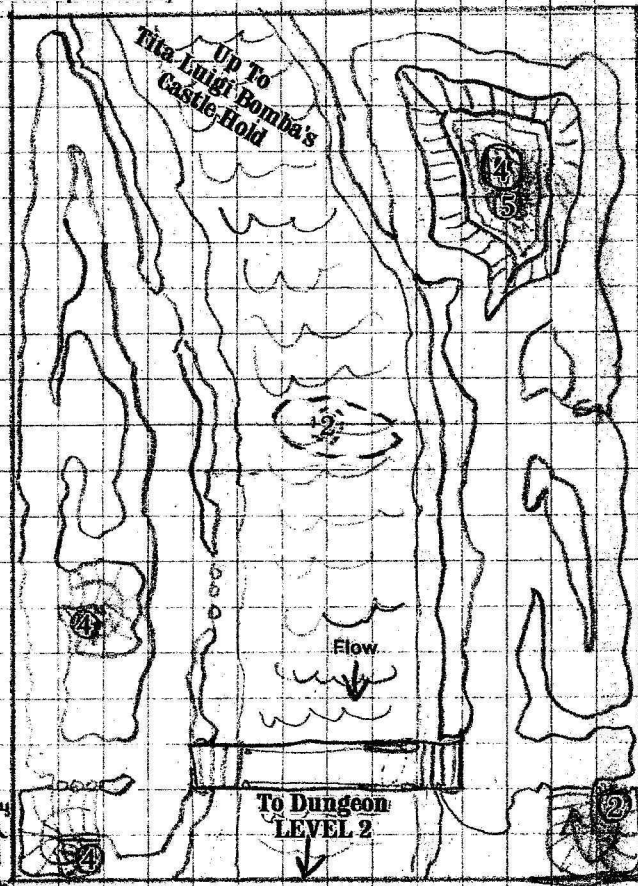

Battle Cave Lvl. 3

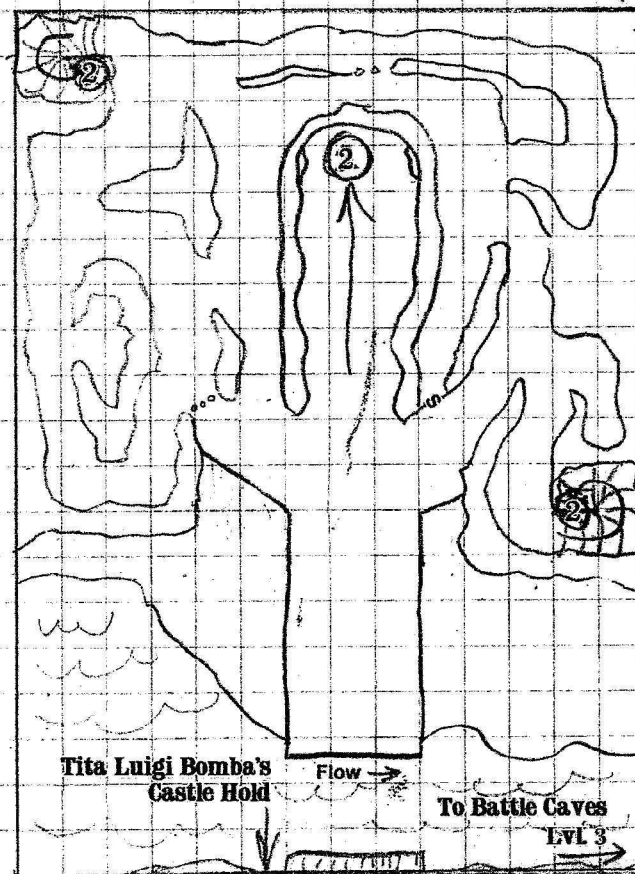

Battle Caves Lvl. 1

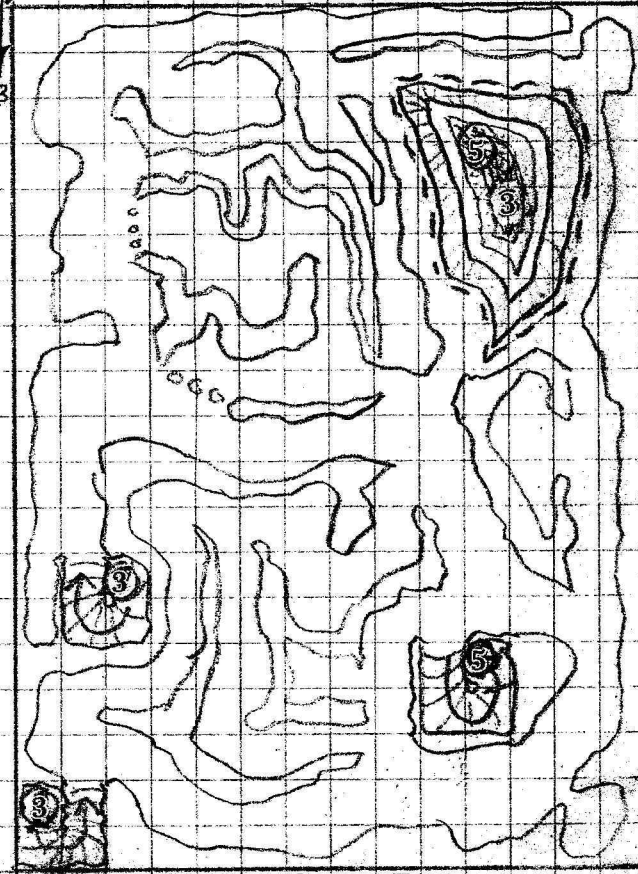

Battle Cave Lvl. 4

THE BATTLE CAVES LEVELS 5, 6, 7, 8

(Dashed Lines " - - - " Indicate Up Direction)

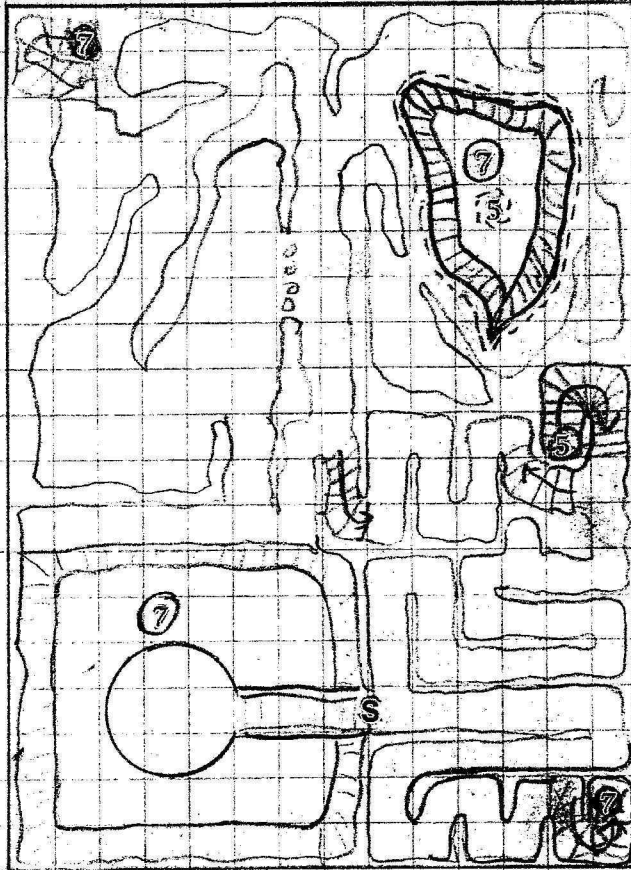

Battle Caves Lvl. 6

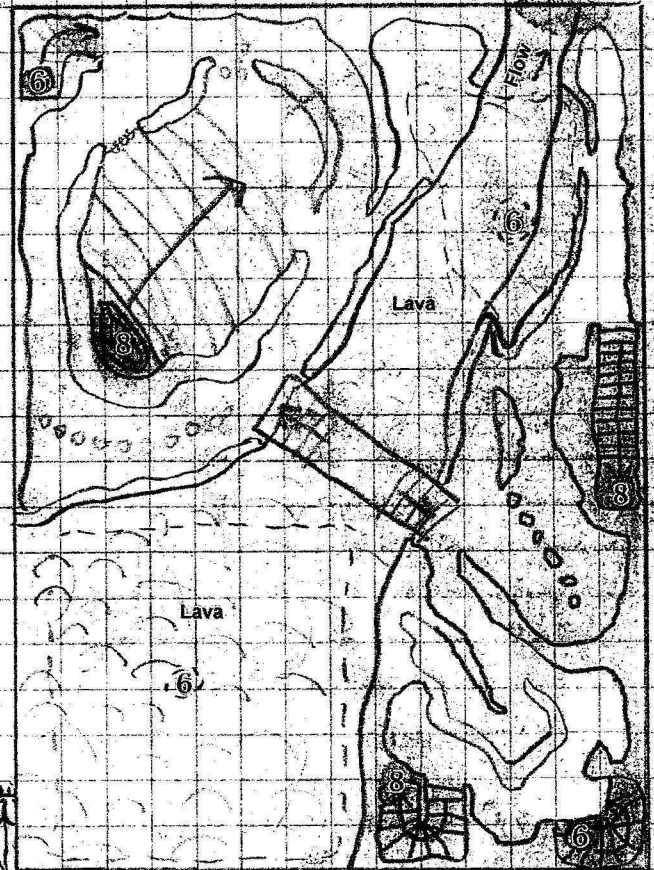

Battle Caves Lvl. 7

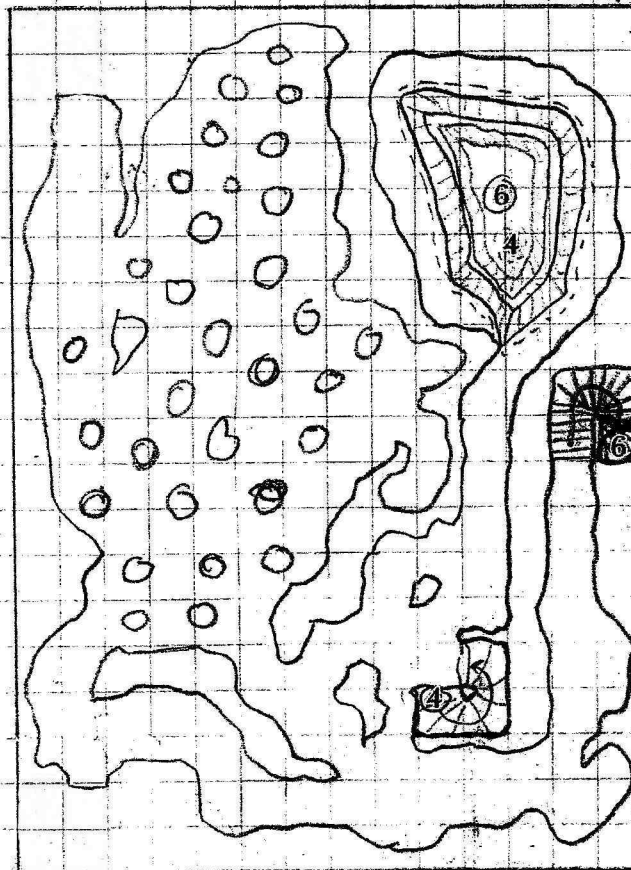

Battle Caves Lvl. 5

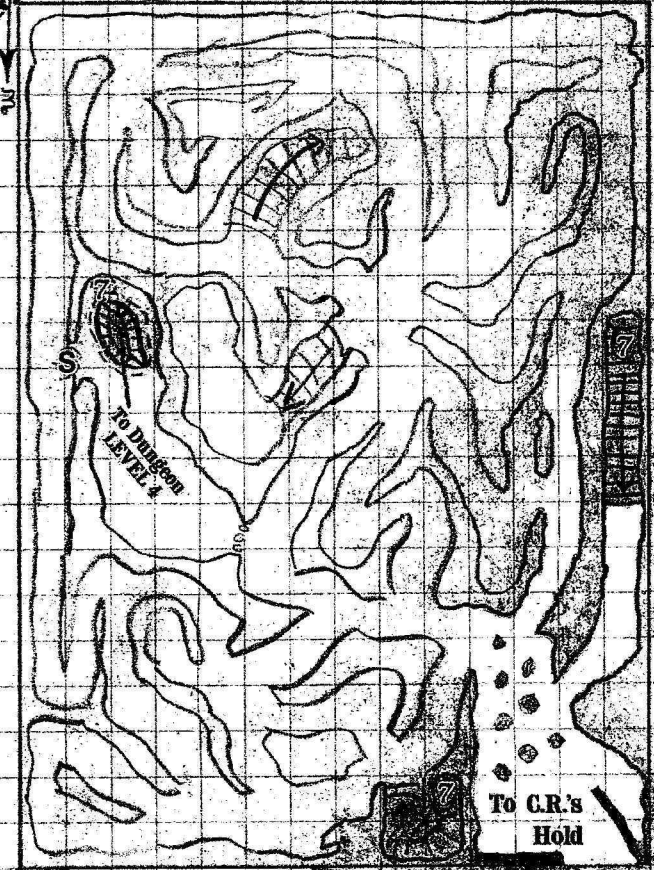

Battle Caves Lvl. 8

LEVEL 2

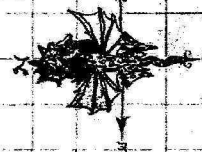

Up to Battle Caves
Level 3

12

1

5

6

7

2

3

4

16

13

9

9

10

9

9

14

20

21

22

23

17

18

19

Waterfall
Up to Dungeon
LEVEL 1

1' Drop
to water

20' Deep

5' Deep

20' Drop

20' Drop

5' Deep

25' Deep

Up

Waterslide to Dungeon LEVEL 1

Down to
LEVEL 3

Flow

Flow

To C.R.'s Hold

(Dashed Lines "- -" Indicate Up Direction)

LEVEL 3

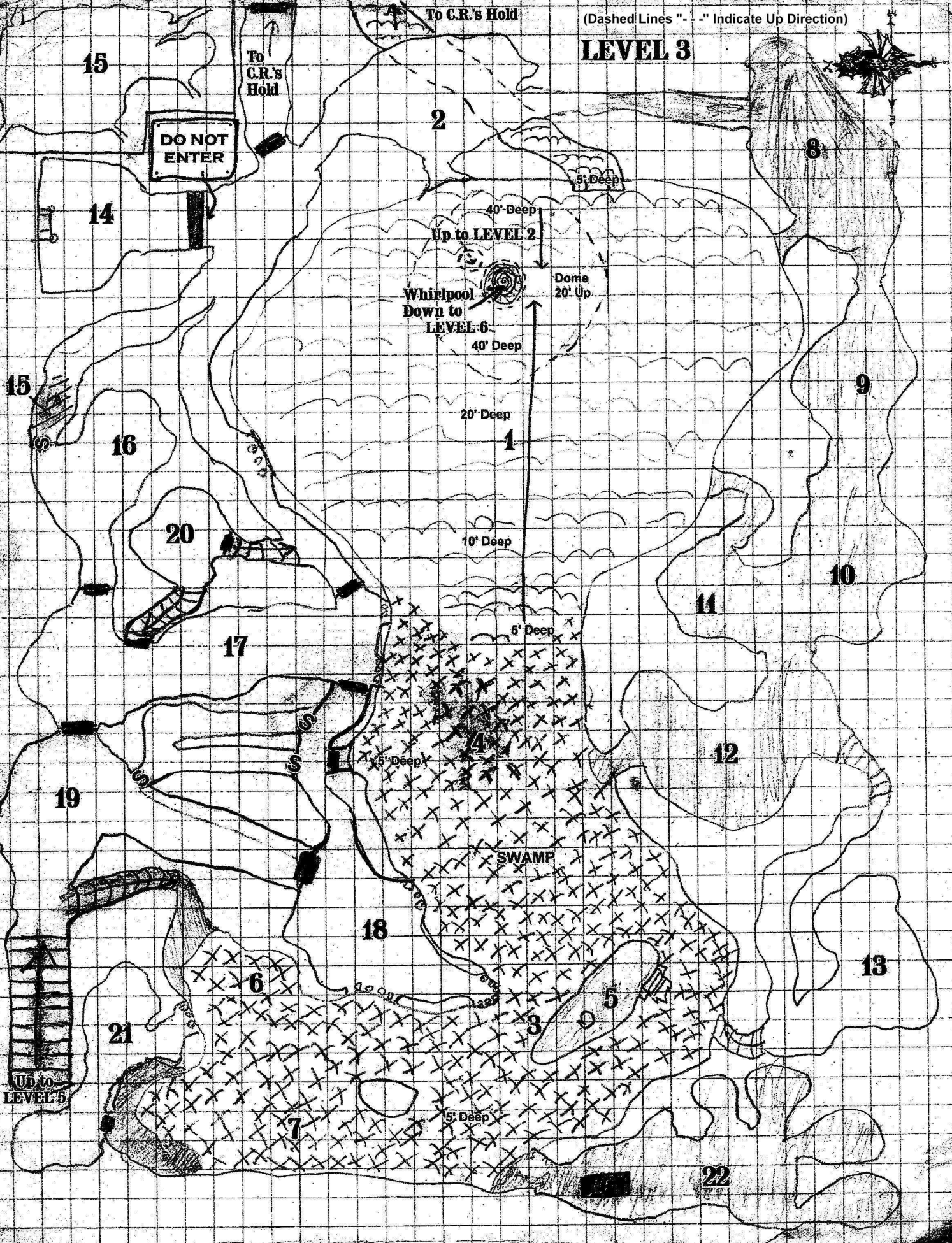

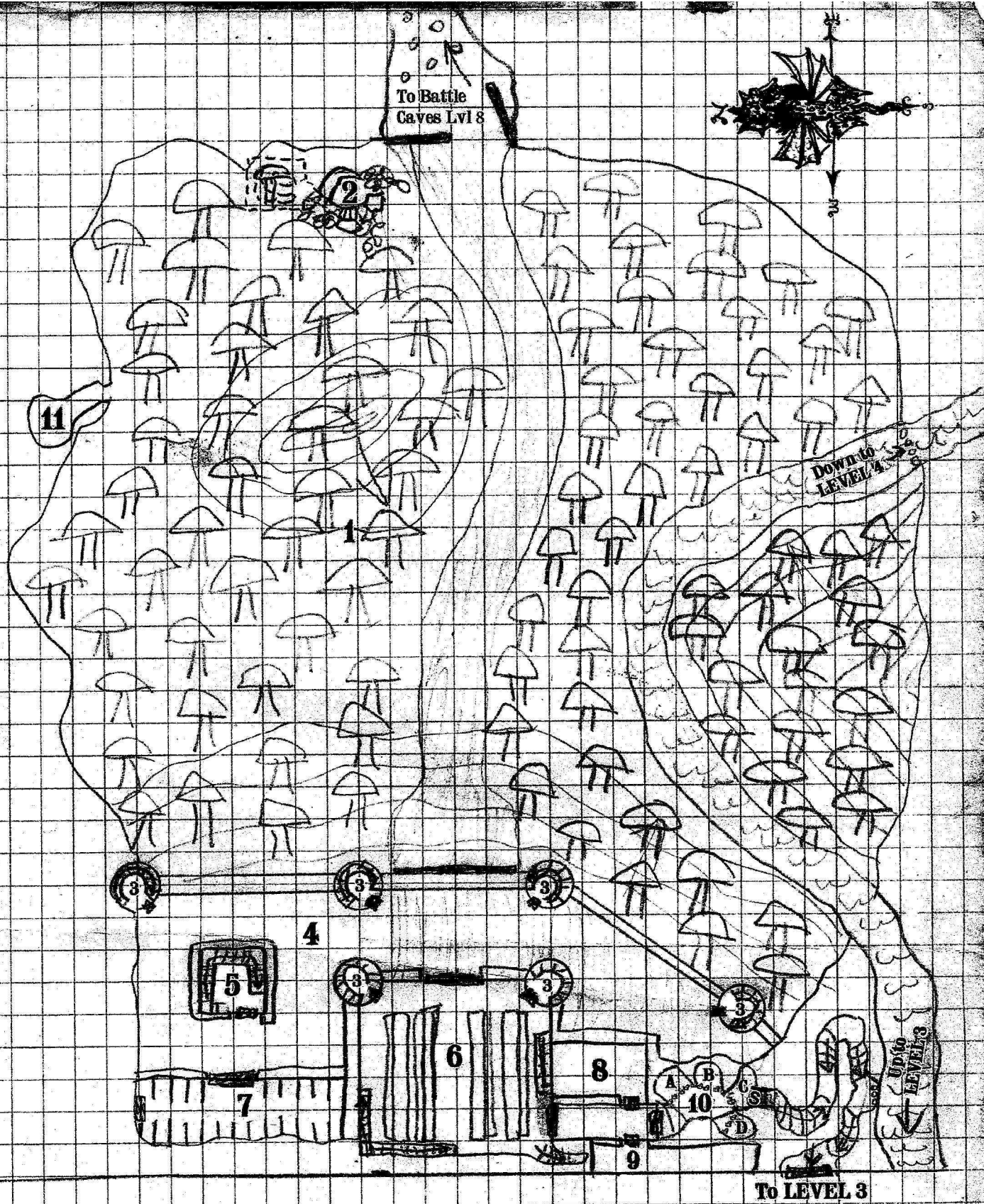

CHICO RERCOTA'S HOLD AND SHRUME PATCH

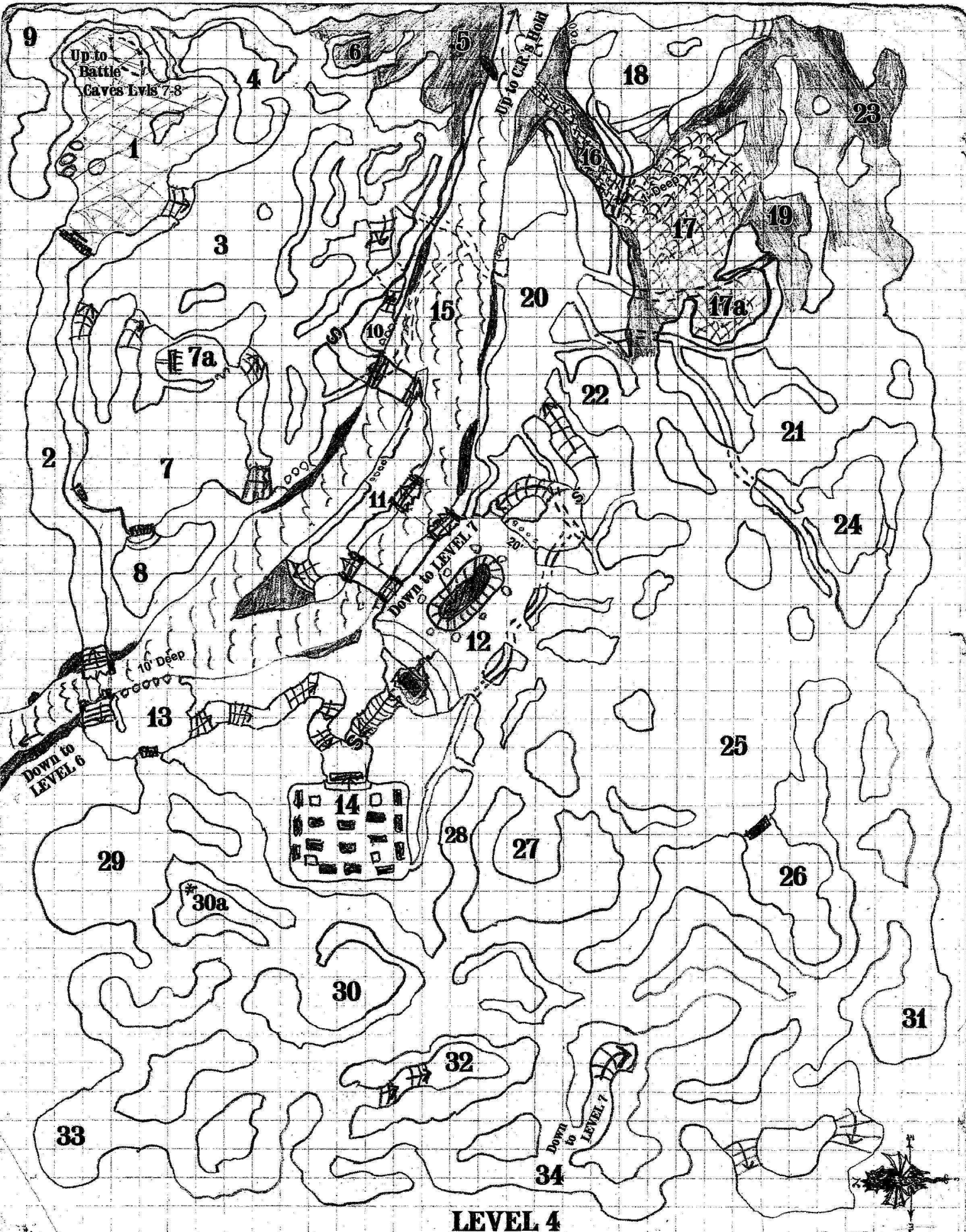

LEVEL 5

(1 square = 10'; except for sideview)

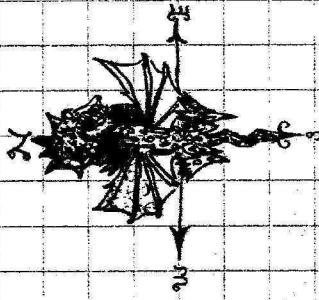

NOTE:
DOORS OPEN OUTWARD
IN THE DIRECTION OF
THE ARROW.

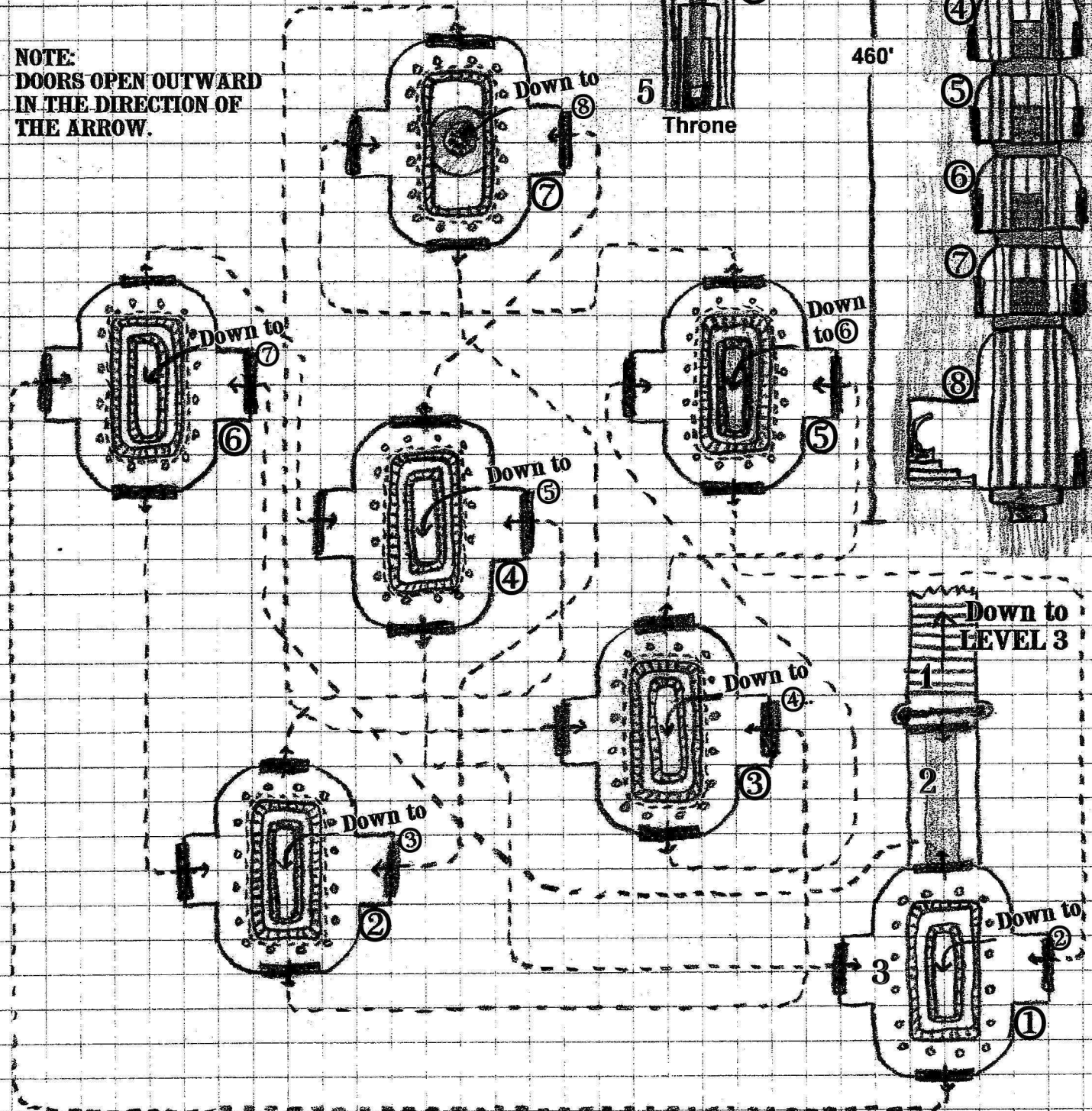
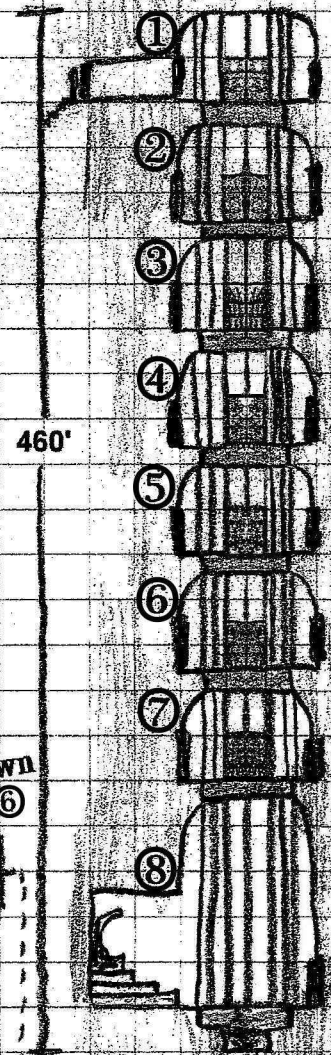
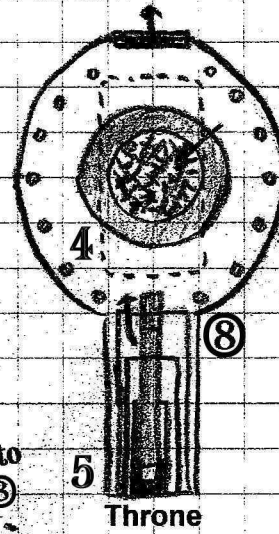

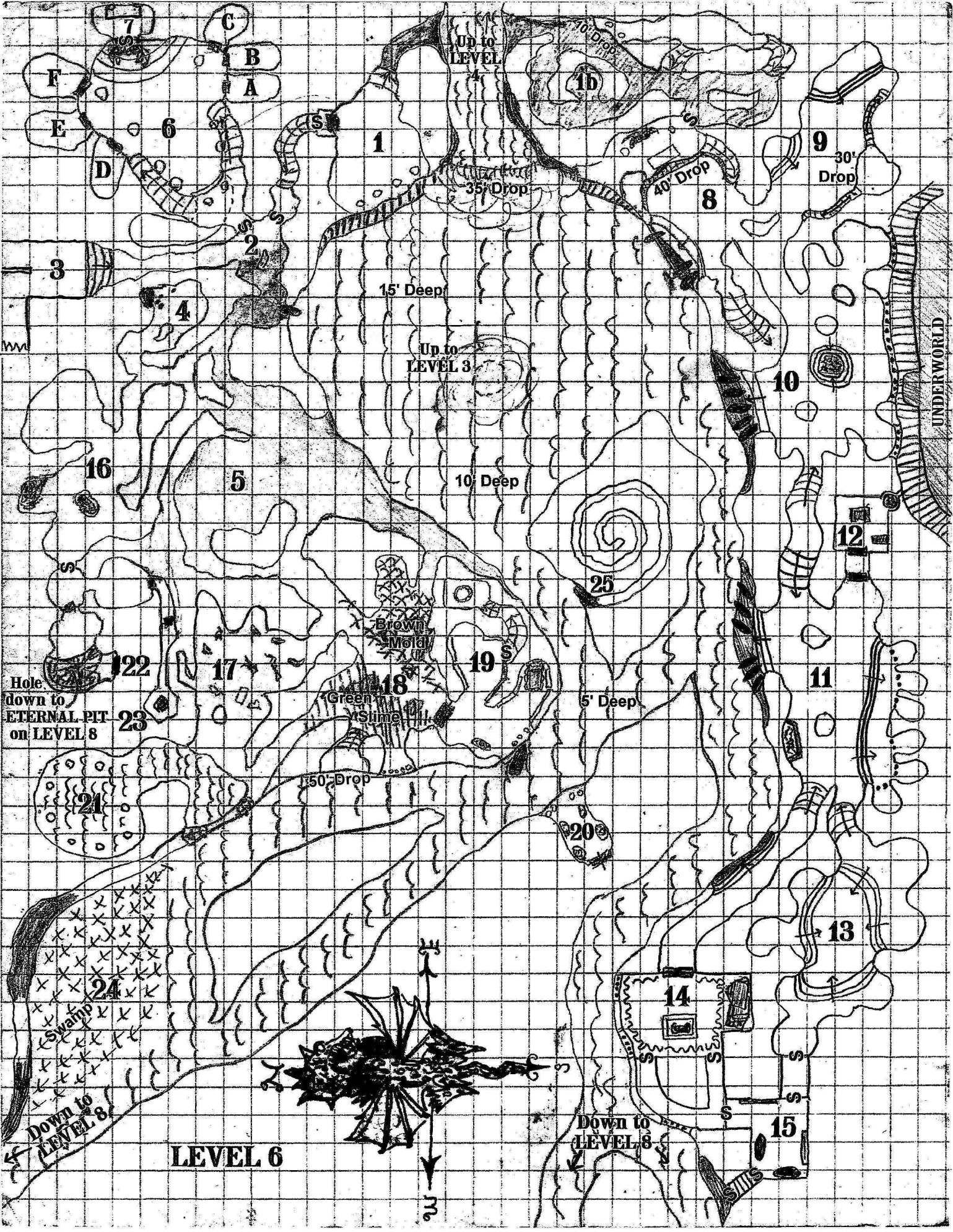

LEVEL 7

