

DUNGEON CRAWL CLASSICS

BRIDE OF THE BLACK MANSE

#82: A LEVEL 3 ADVENTURE

BY HARLEY STROH



Featuring the
groom, Mammon



The bride, Lady Ilse



And the Emerald Cobra
in a bonus adventure:
Blood for the Serpent King
by Edgar Johnson





BRIDE OF THE BLACK MANSE

A LEVEL 3 ADVENTURE

By Harley Stroh • Cover artist and cartographer: Doug Kovacs • Editor: Rev. Dak J. Ultimak • Interior artists: Fritz Haas, Doug Kovacs, Peter Mullen, Russ Nicholson, Stefan Poag • Art direction & layout: Joseph Goodman

Playtesters: Ron Kirkley, Jeremy Ligman, Erik Jensen, Caesar Bariccas, Ryan Moore, Patrick Seymour, Montana Sacóres, Charlie Sanders, Paul Apariao, Joan MacDonald, Ryan Simm, William "Stratochamp" Meinhardt, Mark Greenberg, Jon Hershberger, Matthias Weeks, Doug Keester, Connor Skach, Jim Skach, Haley Skach, Joe Connolly, Mike Daubenspeck, Branden Clark, Jobe Bittman, James Schweiss, Josh Dickey, Darik Rosser, Dave Rosser, Tresi Arvizo, Tom Lindgren, Camdon Wright, Daren Pocus, Wendy Reischl

DCC RPG and this adventure are copyright © 2014 Goodman Games. Dungeon Crawl Classics is a trademark of Goodman Games. DCC RPG is published under the Open Game License. Refer to the OGL in this work for additional information.

www.goodman-games.com



SBP

INTRODUCTION

Remember the good old days, when adventures were underground, NPCs were there to be killed, and the finale of every dungeon was the dragon on the 20th level? Those days are back. Dungeon Crawl Classics RPG adventures don't waste your time with long-winded speeches, weird campaign settings, or NPCs who aren't meant to be killed. Each adventure is 100% good, solid dungeon crawl, with the monsters you know, the traps you remember, and the secret doors you know are there somewhere.

A horror-murder mystery, the events of Black Manse take place in a single evening, and are designed to be played out in a single 4-hour session. It is unlikely that that PCs will have the time to investigate all of the locations within the Manse during a single session – indeed, entire levels of the manse may be left undiscovered. Choices as to how and where the PCs spend their time will prove crucial to their survival.

The adventure is designed for four to eight 3rd-level characters. Because much of the adventure can be resolved without combat, running the adventure for higher level PCs requires little work, though lower level adventurers may meet a grim end before the mystery can unfold.

The party can be composed of PCs of any class, while including at least one thief and one cleric. Clerics will find the adventure an interesting challenge, their abilities providing the difference between life and eternal damnation.

The adventure drew its inspiration from a variety of sources which the judge is encouraged to review prior to play. Works include Fritz Leiber's *The Howling Tower*, Edgar Allen Poe's *The Fall of the House of Usher*, and Stanley Kubrick's *The Shining*.



ADVENTURE BACKGROUND

While their specific crimes have been blotted from the scrolls of the Overking, the flight of mad House Liis is well-known to scholars of royal madness. Cast out from the court, the exiles sought refuge on the low, cold moors.

Without court intrigue to distract them, the family quickly fell into infighting. The death of their matriarch, Lady Baethor, brought this bitter rivalry to a head, with each of the family's scions striving to secure his or her own place as master of the manse.

Lady Ilse, oldest of the brood, saw herself as the rightful heir. However, rules of primogeniture assigned that place of honor to the eldest son, Jost.

Desperate, Ilse sought aid from beyond this world and foul Mammon answered her call. In exchange for the promise of Ilse's soul and a diabolic betrothal, Mammon tutored the young regent in a ritual of horrific proportions.

On the appointed eve, Ilse transformed the entire manse into a magic circle. The moors were rent asunder, brimstone flared in the night, and – come dawn – Ilse stood as sole remaining scion of House Liis.

Ilse, now taking the guise of a male (thereby the rightful heir) and styling herself the Mad Prince, ruled for another 50 years, subjecting the surrounding hamlets and villages to her growing madness. The triumph of her reign proved hollow, for every year on the eve of her fell covenant, she was beset by visions of Mammon and her foul promise.

No longer satisfied with mortal power, and seeking to save her immortal soul, the Mad Prince withdrew to her manor. There, surrounded by a court of specters – some real and some imagined – she sought ways to buy her soul free from Mammon's hellish grasp. Gold, incense, and jewels were offered up to foreign gods, and serfs were burned alive in gruesome sacrifices, but the devil could not be appeased.

Nearing the end of her mortal life and laden with the wages of decadence and sin, Ilse built a secret vault into the House of Liis. Laying wards and traps against both devils and men, Ilse and a cadre of trusted servants retired to her hidden sepulcher. And there, amid the glowing mists of weird incenses and with a dozen holy symbols clutched in her withered hands, Ilse bid her body wrapped in blessed linens and placed inside a rune-scored sarcophagus. Buried alive, the Mad Prince spent the last days of her life weeping in terror and fright.

The Prince's desperate wards and rites were not all for naught. They bought her soul a few score years, long enough for memories of the Mad Prince to fade into legends, and then mere stories, and for the abandoned manor-house to fall into ruin. But the specters of damned House Liis demand an accounting and a devil can afford to wait a very long time.

The anniversary of the Mad Prince's bargain is at hand,



Lost

Melancholic,
absolute, grim

Sabian

Indecisive,
lonely, cruel

Ursula

Friendly,
manipulative,
cunning

Kethe

Jealous,
foolish,
determined

Josef

Focused, proud,
disdainful

Demut

Fearful,
impulsive, distractible

Lady Baethor

**HOUSE LI'S
FAMILY TREE**

Ilse

Fiery, decisive,
hopeful against all odds

Matias

Gullible, mean-spirited,
defensive.

HANDOUT A

SUMMARY OF KEY PLOT ELEMENTS

This adventure includes a number of unique plot elements. They are summarized below with references to more detail within the text.

- Each PC is associated with a specific heir of House Liis (handout A, the family tree on page 3).
- Each heir is associated with a specific heir mask, which has special properties when worn by the assigned PC (Appendix B).
- The bell tolls four times during the adventure, with each bell toll corresponding to the actual passage of time (page 4, below). The first toll is 9 bells, followed by 10, 11, and 12 bells at one-hour intervals.
- At the tolling of 10 bells, the appearance of area A-5 changes (page 12).
- At the tolling of 10, 11, and 12 bells, the appearance of the manse progressively changes (Appendix A).

and – after so many years – the last of the wards have fallen. Lightning peals across the darkening sky and diabolic forms stir beneath the moors. The deceased Prince has one last gambit left to play, drawing a band of powerful adventurers into her haunted manse, in the hopes that the devil will settle for one – or all – of the heroes in her stead.

Fell Mammon will leave with a soul at the end of the night. The only question is: *Whose?*

ADVENTURE SUMMARY



The adventure is short, but dense, and the manse is a shifting, ghost-ridden place, playing a key role in the adventure. With this in mind, the adventure can be run with one of the following two premises: either the PCs are eternal warriors, the reincarnated spirits from the original outcast scions of House Liis; or that at the start of the adventure, all the PCs are chosen and then ridden by one of the original family's ghosts.

The result is the same: each PC is attached to a specific heir of House Liis. At area A-1, each PC is assigned to one of the heirs of House Liis. This can be done by randomly assigning each of the PCs to one of the heirs, or at the judge's discretion. Given the content of the adventure and its grim implications, some groups of players may need more consideration than others.

The adventure begins with the PCs entering the haunted manse, and encountering the Seneschal, a spectral manifestation of the manse's wickedness. Within the accursed manor, PCs discover any number of tormented spirits and specters. Few wish the PCs well, but all hold clues to the mystery of the black manse. Whether old lovers, rivals, forgotten servitors, or the house matriarch herself, all have their own vested interest in the night's outcome.

The haunted manor also contains ancient relics of foul disposition, which can be used by the PCs in their fight against the archdevil. The use of these magic items always come at a cost, and it is left to the PCs to determine the price they are willing to pay.

ONE MANOR, MANY VEILS



Through the course of the night, the spectral world creeps closer, lifting the veils to the material world, one by one, revealing the manse in all its psychic horror. Though the manse's belfry collapsed long ago, tonight the great bell sounds its slow, melancholic toll once more.

The bell sounds four times during the course of the night, with the following effects. A time tracker is included with the map to aid judges in marking the passage of the hours.

Note that, with the exception of the first bell, the tolling of the bells corresponds to the *actual passage of time at the game table*.

The first bell tolls when the adventure begins; the second bell tolls one hour into the session, and the third bell tolls two hours into the session. The last bell tolls three hours in, with a scant hour remaining for the PCs to solve the manse's mystery.

9 Bells: The bells toll at the start of the adventure, announcing the arrival of the PCs and summoning the material form of the manse, the Seneschal. The hauntings begin in earnest.

10 Bells: Upon the second sounding, a gray mist descends upon the manse. Any and all attempts to leave the manse fail. Departing PCs become lost, emerging from the mists at the moat house. Attempts to leave via magic misfire, and divine intervention offers no hope.

Spectral courtesans begin to flood the manor-house. Ladies in elaborate masks and diaphanous gowns are escorted through the dark halls by masked men in long coats and capes. Jesters tumble and prance all around, and spectral musicians strike up the band, all in preparation of the coming nuptials. At 10 bells the specters cannot yet perceive the PCs.

11 Bells: At the tolling of 11 bells, the ghastly menagerie is made flesh. Characters wearing heir masks are treated as part of the entourage, but those caught without masks are deemed intruders and offered up for sacrifice. ...

12 Bells: At 12 bells, foul Mammon himself appears, demanding his winsome bride. How the PCs answer decides whether they escape the manor-house with their souls intact, or are dragged into the pits of hell – brides to the archdevil.

Prior to running the adventure, the judge should review **Appendix A: The Devil's Masque** for specifics on the changing nature of the manse.

ENCOUNTER TABLE

Area	Type	Encounter
A-1	P	The Seneschal
A-2	C	The Gruesome Lover 5 men-at-arms
A-2a	P/T	Devil door
A-3a	T	Collapsing balcony
A-4b	C	3 spectral choristers
A-5	C	5 burned heretics
A-6	C	Lady Baethor
A-8	C	3 headless ladies 3 flying heads
B-1 / B-2	C	Thing of the Undercroft Skeletons
B-3	P/T	Thaumaturgic circle
C-1	T	Lesser charm spirit Greater charm spirit
C-1a	T	Greater charm spirit
C-2	T	Spear and poison trap
11 Bells		Host of devils
12 Bells		Mammon, Archduke of Hell



ADVENTURE HOOKS



The Bride of the Black Manse was originally conceived as a challenging convention adventure – with few heroes living to tell the tale. Those that survived did so with cunning, creative thinking, and no small portion of luck. In such settings adventure hooks are hardly necessary; there is adventure to be had and damn the consequences.

The same cannot always be said for home campaigns with characters carefully raised up from zero-level. If a PC is going to risk life and soul in the search of adventure, it better be for a reason.

Ideally, any campaign hooks should be tailored to a judge's own world. Generic hooks (god, gold and glory) prove toothless. With this in mind, consider the following when seeking inspiration for hooks specific to your home campaign.

- The PCs are awarded a manor-house as thanks for their service to the crown or church. The manor comes with a minor title and a small annual stipend; all that remains is for the PCs to claim their rightful place as masters of the manse.
- One of the PCs (preferably a noble or knight) receives a summons by a distant relative. The missive, pleading for the PCs' aid, is dated 500 years prior.
- When a PC dies in a previous adventure, he awakens before a dark throne, surrounded by flames. A towering figure leans down from the throne and whispers, "Not yet, you are promised to another." The flaming-regent presses its clawed thumb to the PC's forehead and the PCs awakens in the real world, with 1 hp and a pentagram seared into his forehead. From that day forward the PC is haunted by dreams and finds his steps turning inexorably towards the high moors ...

PLAYER START



The adventure begins with the PCs standing on a low ridge, looking down over the long black mere and the manor-house perched on its marshy shore. A hint of the night's coming chill hangs in the air.

Read or paraphrase the following:

Storm clouds darken overhead, limned red in the light of the dying sun. From atop the ridge you can see the manor-house, perched on the swamp's edge. The manse leans back, its vaulted windows and gaping portal the eyes and maw of a leering corpse.

Give players Handout B. Give each of the players a moment to study the handout, before:

A cold rain begins to fall, obscuring sight of the manse. Through the hiss of the driving rain comes the slow toll of a funerary bell.

This first tolling is 9 bells. Begin tracking time at the table; the next tolling – 10 bells – comes precisely one hour after the start of the game session.

LEVEL A: THE HOUSE ON THE MOORS



et on the shore of a lonesome mere, the manor-house is a foreboding sight. The entire castle appears ready to sink beneath the glassy waters, weighed down by the sins committed within its walls.

While crossing through the moat house is the most direct means of entering the manse, PCs are not obligated to “play along.” Determined PCs can swim across the moat (triggering the attack of the Gruesome Lover and its attendants, area A-2) to the manse. However, climbing from the moat and up the rain-slicked stone walls, in the dark, is difficult even for trained climbers (DC 23 Climb or Strength check).

Once atop the walls PCs can ready lines for their allies. From this vantage point PCs can descend into the manse via the courtyard (area A-6), the ruined bell tower (area A-5) or through the stained glass windows above area A-3. There is no means of access to the high halls (level C) from the slate roof; the windows are all blocked with stone and plaster, and the chimneys are barred and too narrow to permit passage by anything larger than a rat. Of course, if the PCs *do* find a way in despite the barriers, the chimneys open into the main hall, area A-7.

Except where noted, the interior manse is dark and damp. The walls are wet with rain seeping through the ruined roof, and there is no light, save for what the PCs carry. The stink of the swamp and moat – churned by the falling rain – fills the chill air. As a whole, the manse is grim and unwelcoming, making the shift to the Devil’s Masque all the more dramatic.

Finally, some of the manse’s doors open to blank stone. Attempts to destroy the stone or bypass the walls inevitably fail. Some of the manor-house’s secrets were never meant to be discovered.

Clerics: Upon entering the manse, priests of every faith immediately recognize the presence of restless spirits. Clerics can attempt to divine the nature of the haunting:

Spell Check Divination

1-4 The cleric is overwhelmed by the horror of the manse and must attempt a DC 20 Will save or fall victim to the manor’s madness. On a successful check the cleric merely takes 1d5 disapproval. On a failed check the cleric seems unaffected, but turns on his fellow PCs at a time of the manse’s choosing (as decided by the judge). The madness lasts for 1d5+2 rounds from the moment of betrayal.

5-9 The cleric angers the manse, which responds by lashing out at the caster with raw psychic fury. The cleric must attempt a DC 15 Will save. On a successful check, the cleric asserts mastery of his faith over the horror of the house, and is granted +5 to a single spell check of his choosing. On

a failed check, the caster is sent reeling, taking 1d12 damage and is unable to cast spells for 1d20 rounds.

10-14

Divinations confirm what the PCs must already suspect: the manor-house is weighted down from the sins of its past. The cleric has a vision of something moving amid murky waters, and a coffer – or coffin – hidden in the same.

15-19

The cleric receives indications that the PCs’ prior selves are responsible for the horrors of the manse, debts which have come due on this very night. The cleric hears a great bell tolling, and has a vision of a devil coming at midnight. The devil looks to the cleric and beckons him closer.

20+

As 15, but also that the devil is Mammon, and that a nuptial promise has been made by a member of the party. Finally, the cleric has a vision of a promise ring, long forgotten, hidden somewhere in a “high hall.”

Area A-1 – Moat House: *A short passageway runs through the crumbling moat house. The way is impeded by a rust-flaked portcullis – half raised – hanging in the darkness. Beyond, a stone bridge crosses the murky mere to the manor-house.*

A strange premonition hangs over you and your companions – the sense that you have been here before. Chill rain drums on the slate roof of the moat house, seeping into your clothes and pooling on the muddy ground.

Ask the PCs to make Luck checks, reporting the totals. From highest to lowest, assign the PCs to heirs of House Liis, as shown on Handout A (the family tree, page 3). For the remainder of the adventure, each PC will be tied to that specific personality.

As the PCs enter the moat house, they are hailed by a withered man garbed in a mold-blackened robe and a mantle bearing the sigil of House Liis. His robe is wet with marsh water and he leans heavily on a sodden walking stick.

The old man raises a crooked hand in a salute and calls out in a weak voice:

“An auspicious hunt, to be sure! Well done, masters, well done!”

The old man gestures behind the PCs – the body of an enormous stag lays on the floor where moments before there was naught but cold stones. Heat steams off of dozens of bloody wounds.

The Seneschal rubs his liver-spotted hands in delight.

“The beast will make a fine addition to tonight’s celebrations. But come, masters, you must be weary. Retire to your chambers, don your masks, and make ready for the fete.”

The old man gestures within the citadel, and then cranes his head towards the darkening skies. "You brought the storm with you, masters. Looks to be a wild night."

The strange, withered man is the embodied spirit of the manse – the psychic torment of the house made manifest in the flesh. Though appearing real for all intents, this is the spectral manifestation of the manse's wicked past: the Seneschal.

The Seneschal refers to each of the PCs by their former names (as keyed by the handout), and treats each with the utmost respect. If the PCs inquire about the nature of the fete, the Seneschal shares that it is a wedding, of course, and that all are excited, for tonight the manse's lord and lady are to ascend their thrones. He can share that the PCs have been gone "for far too long," and that it is grand that the PCs have returned home for the wedding. If asked who will be married, he responds, "The master, of course, and his long-promised bride!"

Pressed further he politely shakes his head, averring that his memory is not what it once was. If PCs ask questions about their former selves, the Seneschal assumes that his masters are teasing him, and waves aside their questions, saying that he is far too old for their silly jests on such an important night. In all interactions he treats the PCs with utmost respect, referring to them as the lords and ladies of the manse.

Important Note: The Seneschal refers to the PCs by the gender of their associated heir; thus male PCs may be referred to as Ladies, and female PCs associated with male heirs, called Lords. Astute players may quickly realize that – even among the manor's ghosts – not all is as it seems.

Pressed or attacked, the phantom vanishes from sight, along with the bloody stag. If turned by a cleric, the Seneschal smiles as he fades from sight, whispering, "As you wish."

Area A-2 – The Mere Bridge: *A slick stone bridge crosses the span to the manor-house. Below, the moat is slowly being reclaimed by the swamp: tall reeds bend in the driving wind as beds of black algae are churned by the driving rain.*

Though aged, the fixed stone bridge retains all its former strength. The stone surface is slick due to rain and debris; any melee fumbles atop the bridge send the character spilling into the water, 10' below. The mere is roughly 15' deep, with a muddy bed.

Lady Ursula, her lover, and their men-at-arms were murdered here, drowned in the mere. Despite the passage of years, the Lover yet yearns for Ursula's embrace.

As the first PCs reach the center point of the bridge, the storm increases in magnitude; sheets of icy rain hammer the PCs, and the buffeting wind threatens to hurl the PCs from the bridge. The howl is nearly deafening, but Ursula's PC hears their name repeated again and again on the wind.

The Lover pulls itself out of the muck and mire beneath the

mere bridge. A towering, rangy man in life, in death the Lover is a gaunt, troll-like fiend, his mere-blackened skin clinging to his long bones. His long arms hang nearly to the ground, his legs and spine are twisted and rotten, and haunted eyes threaten to pop from the drawn face.

The Lover is attended by five men-at-arms, all matching the grim appearance of their master. Their once-handsome locks are strung with reeds, and algae hangs about their bodies like filthy tabards.

Dripping with mud, the Lover begins combat by attempting to surprise the party from beneath the mere-bridge. His goal is to close with Ursula's PC; on a successful attack, he hugs the PC to his icy chest and plunges into the water. Drowning creatures take 1d6 points of Stamina damage per round and die when Stamina reaches 0; lost Stamina is restored immediately if they are removed from the morass.

The men-at-arms focus their attacks on distracting the party, permitting their master to capture his lost love. They carry a length of rope and several anchor stones in leather bags. On a successful attack the attendants loop the noose around their target. To escape the PCs must deal 10 hp to the rope or succeed on a DC 15 Strength check. Once noosed, the men-at-arms hurl the satchel of stones into the mere, dragging the PC under (DC 20 Strength check to resist). On a failed check the PC is hauled underwater and begins to drown.

The bog creatures pursue the PCs until the party is safely inside the manse. The creatures can be turned by Lawful clerics, and by clerics whose faith opposes un-dead.

The Lion Mask: Ursula's heir mask is hidden in the brackish waters. Anytime a PC falls into the mere or spends a round in the water, make a secret DC 15 Luck check. On a successful check the PC brushes against a black iron strongbox – "something hard and angular in the water." Thorough characters opting to search the muddy mere discover the strongbox on a DC 5 Luck check.

The coffer is filled with water and covered in dead reeds and muck. Hauling it from the mire requires the efforts of two or more PCs or a DC 20 Strength check.

The strongbox's lock is fouled with mere-slime, making it difficult to pick (DC 15 Pick lock check). Alternately, the coffer may be struck open by a single blow inflicting 5 or more points of damage.

The coffer isn't trapped, however with a DC 10 Find traps check the thief notices vibrations emanating from within. Further examination reveals a muffled buzzing sound, like that of a hive. Former beekeepers (and their peers) confirm this suspicion: a swarm of insects resides within the coffer.

The instant the coffer is unlocked, the lid cracks open, releasing a flood of vermin: clicking roaches, spiders, biting flies, stinging insects, and strange, crawling larvae never before seen outside the confines of Hell. The buzzing, clicking swarm attacks any character within 10' of the coffer. Characters beating a 10 initiative can easily flee the swarm,

but those failing the initiative check (or those simply failing to retreat from the swarm) are overrun by the dispersing swarm. The vermin force their way into the PC (mouth, nostrils, ears, eyes – any exposed orifice will do); infected PCs take 1d5 Stamina points of damage, per round, as the vermin worm their way into the target's body. The vermin continue until the PC is slain, the target is healed by a cleric's lay on hands, or the target succeeds on two DC 10 Fort saves. The target may make one save per round. The temporary Stamina damage is healed back at the rate of 1 point per hour.

Within the coffer, atop a bed vermin husks, is a leonine mask decorated with thick bristling hairs, a rich mane, and a convincing snout and pearly teeth. Worn by Ursula, the **Lion Mask** grants +3 to all saving throws and +d10 hp. See Appendix B for additional abilities of the Lion Mask and the other heir masks.

The Gruesome Lover: Init +2; Atk crushing hug +3 melee (1d7); AC 12; HD 5d6; hp 18; MV 35'; Act 1d20; SP un-dead; SA drown; SV Fort +5, Ref +0, Will +2; AL C.

Men-at-Arms (5): Init +1; Atk blow +1 melee (1d4); AC 9; HD 3d6; hp 10 each; MV 30'; Act 1d20; SP un-dead; SA drown; SV Fort +4, Ref -2, Will +2; AL C.

Area A-2a – The Great Doors: *A pair of towering bronze doors bars your way. The paired portals are cast with depictions of a single figure, surrounded by seven impaled bodies. Above, a corpulent devil leers from atop a mighty throne.*

Adventurers closely inspecting the casting can determine that the figure wears a crown and the ceremonial robes of a summoner. Inquisitive PCs can discern the summoner's gender as female, but little else. Clerics, wizards, elves, and their ilk readily recognize the devil as Mammon.

As the PCs approach the doors they hear a voice booming from above: *Who would enter?*

If the PCs reply, "The masters / lords / ladies of the manse," or the rough equivalent, the doors unlock and swing wide. After the last PC passes, the wind gently closes the doors.

If the PCs answer otherwise or refuse to answer, the doors must be picked (DC 10 Pick lock check) and then forcibly hauled open with a successful DC 15 Strength check, or by three or more PCs simultaneously forcing the door. Unless propped open, or specifically held by PCs (DC 15 Strength check) a blast of howling wind hurls the doors closed as the last of the PCs enters the manse. Characters can dart out of the way with a DC 15 Ref save, but on a failed check the PC is caught and crushed between the doors for 1d7 damage.

Until the storm abates at 10 bells, it requires the collective efforts of four characters or a DC 25 Strength check to force the portal back open.

Area A-3 – Illuminated Hall: *The arched, vaulted dome is shrouded in shadow. Dark tapestries hang from the walls like dripping entrails.*

High above, rain courses in dark rivulets down the stained glass

windows circling the dome. In the crash of the lightning, the stained glass casts the chamber in flashes of red and violet.

Paired doors stand to your left and right. Across the hall, twin wooden staircases rise to a balcony.

Show the players Handout C. There is one tapestry for each PC, though it is left to the players to make this connection. All depict the members of the House of Liis, with one stylized figure per tapestry. A PC touching his keyed tapestry immediately feels a warm familiarity, like the recollection of a long-forgotten dream.

The tapestries were once richly woven arras, depicting scenes illuminated with silver, gold and copper threads. Worn thin by the passage of time, devoured by moths, and blackened with rot, all that remains of each arras is the top portion: some 2' wide and 6' in length.

There is a single, "master" tapestry, hanging from the balcony. Unlike the others, it shows no hint of wear or aging. The master tapestry depicts three scenes, transpiring in chronological order:

- A woman in a white gown with flowers in her hair. Around her lie seven corpses.
- An enormous fiery-form, composed entirely of black flames, offering the woman a fiery ring.
- The woman vanishing into a crown of seven others. The demonic form, enraged.

Following are descriptions of the tapestries keyed to individual heirs:

Ilse's Tapestry: The arras depicts a tall warrior with shining golden hair. Arrayed in white armor, the warrior is armed with a short sword. (Players must make their own assumptions of the warrior's gender, as the tapestry does not allow for enough detail to discern her sex.) Curiously, the tapestry is dry to the touch.

Ursula's Tapestry: The arras depicts a small, golden-haired girl accompanied by a handsome prince and five men-at-arms.

Jost's Tapestry: The arras depicts a golden haired figure with a sweeping mustache. The figure holds a mace in one fist and a massive tome in the other.

Sabian's Tapestry: The figure appears as the inverse of Ilse's. The tapestry depicts a warrior in black armor, with black hair, and holding a spear. To either side are stylized wolves.

Kethe's Tapestry: The tapestry shows a red-haired woman in a long black dress. On one hand perches a raven or black-hawk.

Josef's Tapestry: The arras portrays a tall, dark-haired warrior in a white tabard and armed with a bow.

Demut's Tapestry: The dun-haired woman is depicted in a white dress. She clutches a serpent in one fist and a dagger in the other.



Matias' Tapestry: The tapestry shows a young, golden-haired child arrayed in a white tabard. Red lines snake from the child's wrists.

If the PCs attempt to remove or harm any of the tapestries, the storm redoubles its ferocity. Read or paraphrase the following:

A stained window explodes above you, as the full fury of the storm pours into the hall, tearing the tapestries from your grasp! Sheets of glass rain down, exploding as they strike the floor. A raven, cast inside by wind, flops weakly on the floor, its blood mingling with the shards of wet glass.

The shrieking wind continues, but determined PCs can easily tear the flapping tapestries from the walls.

Area A-3a – High Balcony: *The staircases rise to a high balcony overlooking the hall. Supported by wooden beams, the ancient balcony creaks with every step.*

A set of wooden double doors stands at the rear of the balcony. Stylized vultures, illuminated in gold flake and dark stain, emblazon each door.

The doors once opened to the master's wing on the second floor, but Ilse had the corridor filled – floor to ceiling – with stone and earth. Thieves investigating the doors (DC 10 Find traps), and those tapping on the doors, determine that the space behind the doors does not seem hollow. The doors open out, onto the balcony and are not locked.

If the doors are opened the compacted earth spills out onto the balcony. The balcony collapses, falling 30' back to the floor of the hall. This, in turn causes the *hall* floor to collapse, spilling PCs in a shower of wooden beams, flagstones and earth into the pooled water in area B-2.

Characters beginning on the balcony must make DC 15 Ref saves or take 3d5 damage as they pitch into the inky darkness below.

Characters in the hall (area A-3) must make DC 10 Ref saves to avoid falling through to area B-2 below. Those succeeding on the save, manage to cling to beams and flagstones as the floor collapses beneath them. Character failing the Ref save fall into the waters below, and must attempt a DC 10 Fort save, or take 2d5 damage.

In the aftermath of the collapse, nothing is left of the balcony save a few rotten timbers extending from the wall. The northern half of area A-3 is collapsed, leaving a pit 20' across. Crossing the pit requires inching along the remaining slip of a ledge (DC 5 Climb walls check or DC 10 Agility check), magic, or cunning. Those reaching the opened doors can shimmy over the remaining mound of stone into area C-1.

Area A-4 – Oratory: *The simple wooden doors open into a narrow stone chapel. Rotten pews lay cast about like playthings. The walls and ceiling are hung with moldering violet draperies; once rich, the cloth is now ratty and torn.*

At the head of the chapel is a trio of toppled altars on a dais of

black stone. Garlands of rotting flowers droop from the walls and adorn the toppled altars.

Dedicated to Mammon and his dukes, Abbadon and Belphegor, the oratory was formerly the private chapel of House Liis. Following the fall of the House, Ilse desecrated the chapel in hopes of ending her contract with Mammon. This, like all of her various efforts, was doomed to failure. Clerics, bards and their ilk quickly recognize that the chapel is decorated for a wedding.

All three of the toppled altars are cracked and broken, retaining none of their original power. Clerics, sages and diabolists inspecting the altars readily identify the unholy trinity. The largest altar is fashioned of red and black marble, and was dedicated to Mammon. The first of the smaller altars is pure black, and sacred to Abbadon. The second of the smaller altars is red, flecked with black, and dedicated to Belphegor.

Ruined unholy implements litter the dais. Characters investigating the rubble discover six violet candlesticks, a trio of shattered cruets, and a blood-stained antependium lying about the floor. A shallow, empty pool is set into the dais.

Hidden amongst the rubble are three glass globes, each the size of a large fist. Within the globes are strange white pellets. Within each globe is also a second globe containing a reddish fluid. These globes contain sage's soda (known in our world as sodium hydroxide) and dyed water, respectively; when mixed – usually by crushing the inner and outer globes – the caustic solution dissolves flesh and muscle, leaving only brittle bone in its wake, causing 1d4 damage per round until washed clean with sufficient amounts of water, or healed via a cleric's lay on hands. Washing sage's soda clean is its own hazard; the exothermic reaction inflicts an additional 1d4 damage, and sets flammable objects alight. The fragile globes were used by worshipers to dispose of corpses, dissolving the bodies of the sacrificed in the pool set in the dais.

Characters righting, moving or searching the ruined altars discover a large iron ring set into the floor. Pulling on the ring raises the flagstone, revealing a stone stairway down into darkness (area B-1). The cool air below is moist, and stinks of mud and rot.

Astute characters note that there is a second floor to the chapel: a choir loft hidden in the darkness above. A circular staircase (area A-4a) rising to the loft is hidden behind the moldering tapestry hanging on the west wall. Alternately, trained climbers can scale the walls and moldering tapestries with a DC 10 Climb or Strength check. (On a roll of 1-5, the rotting tapestries tear out from the wall, pitching the PC to the stone floor for 1d6 damage.)

Area A-4a – Staircase: *Behind the moldering tapestry, the walls open to a narrow staircase that spirals up into darkness. Set into the wall of the staircase is a shallow alcove containing a curious bladed device and a rune-scribed crucible atop a brazier. To the right of the brazier are a handful of unburned coals.*

Above, in the darkness, you hear the sound of hushed whispers and shuffling feet, then silence.

The stairs rise to area A-4b. The sound originated with the phantom choristers (see area A-4b) in the choir loft. After the initial noise they are perfectly silent.

The bladed lever is bulky, but portable. By passing his forearm beneath the blade, grasping the handle, and forcing down on the lever, a single user can neatly sever his own hand at the wrist. The blade is crusted with blood.

The crucible is capped with a strip of dried leather. The crucible is filled to the brim with hardened beeswax. Inspection of the beeswax shows that it is flecked with bits of metal, identifiable by dwarves as lead, gold, and iron.

With a freshly severed hand, the collection of items provides all the necessary materials to create a *Hand of Glory*. The rite only works with the hand of a living humanoid, though the victim need not be willing. The victim can die afterwards, but must be alive for the completion of the ritual.

If the brazier is heated, and a severed hand dipped into the melted wax, the wax moves of its own volition, covering the hand in a thin coat of beeswax. Once the beeswax has cooled into a hardened shell, the fingers can be lit like candles, invoking the powers of the *Hand of Glory*. The brazier contains sufficient beeswax to coat a total of three hands.

Lit, the *Hand* casts a 30' diameter sphere of murky, red light. While within the light cast by the *Hand*, the bearer and his allies enjoy its powers. Each *Hand* takes on different qualities, depending on the alignment of its original owner:

Lawful: *Invisible* to extra-planar creatures (including demons and devils); +3 to turn unholy and lay on hands checks.

Neutral: +3 to saving throws; all illusions and disguises (including the false-visions of the Devil's Masque) are dispelled within the radius of the light.

Chaotic: *Paralysis* (DC 15 Will save to avoid) of living creatures (not devils, demons, or un-dead) within a cone extending before the bearer (15' long and wide at its furthest reach); secret and concealed doors are revealed by the cone, limned in a faint red light.

A *Hand* burns a total of 5d5 rounds, and may be extinguished between uses.

Area A-4b – Choir Loft: *The dark loft overlooks the ruined chapel below. A blue phantasm of a woman kneels on the floor of the loft. One of her arms has been severed at the elbow and lies on the floor beside her. The severed arm seems to be covered in wax. Flint, steel and tinder lie scattered on the floor before her; she is trying – and failing – to start a fire, one handed.*

The phantasm looks to the PCs with wild, terrified eyes. "Help! They're coming! Can't you hear?"

The ghost is attempting to light her wax-covered hand. She

is referring to the approach of three choir boys. Give the PCs one round to act. If any PCs offer a torch or lit candle, she eagerly picks up her severed hand and thrusts it into the flame, setting it alight.

At the end of the round, three choir boys pass through the wall. Young men with bright eyes and curly locks, they look to the one-armed ghost with innocent smiles.

The one-armed ghost is speechless, pleading silently with the PCs.

If at any point (either now, or later) the PCs set the severed arm alight, all four ghosts are dismissed. The arm remains, burning for another 3d5 rounds, before vanishing from existence. If used against others, treat the arm as if it were taken from a Lawful PC (see area A-4a for details on the arm's powers).

However, should the PCs fail to light the arm, call for initiative. Characters that beat the choristers are permitted one action: plugging their ears, fleeing the chapel, attacking the choristers or the like. Attempts can be made to turn the ghosts.

On the choristers' turn, they break into a cacophonous three-part chant exalting the virtues of Mammon. The chant builds over the course of four rounds, and repeats until the choristers are dismissed with a turn unholy check, the arm is lit, or the source of the haunting is disrupted (see below). Holy men, nuns, and those with a background in music are able to anticipate the break in the music during round 3.

Round 1: The shrieking chant drowns out all speech and levies a -5 penalty on spell casting attempts (including turn unholy). Judges are within their rights to instruct players not to speak with one another. All PCs within earshot feel a piercing pain in their temples, and must make DC 5 Fort saves or suffer 1d3 damage. The one-armed ghost screams in agony and slowly fades from existence. Her severed arm remains.

Round 2: The hellish chanting swells in volume. All PCs within earshot begin to bleed from their ears and eyes, and must make DC 10 Fort saves or take 1d6 damage.

Round 3: The choristers pause for an instant, permitting spell casting, turn attempts and speech. Characters failing to beat the choristers' initiative are drowned out as they resume their chants on ...

Round 4: The chants reach a deafening crescendo, drowning out all speech and spell casting. The pitched shriek shatters any glass objects held by the PCs (including globes lifted from the chapel, below). Additionally, PCs within earshot are deafened for 1d10 rounds (or until divinely healed), and take 1d10 damage as blood gouts from their eyes, ears, noses and mouths (DC 15 Fort save to avoid).

Future Rounds: The choristers begin the cycle anew, starting with round 1.

Characters protecting their ears, or finding ways to otherwise silence the area are protected from the choristers' chants.

The choristers are immune to physical attacks by either mundane or magical weapons, and take no damage from spells. Clerics immediately know (but may not be able to convey) that there are three principle ways of defeating the phantoms: either by a successful turn unholy, by disturbing the specters' remains, or by lighting the phantasmal *hand of glory*.

Their remains – a trio of skulls and a single arm – are hidden in a crawlspace in the ceiling at the rear of the loft.

Spectral Choristers (3): Init +2; Atk special (see above); AC 10; HD 2d12; hp 12; MV 0'; Act 1d20; SP un-dead, immune to non-magical weapons, immune to magical weapons, take no damage from spells; SV Fort +2, Ref +4, Will +6; AL C.

Area A-5 – Bell Tower: *The floor of this tower is littered with rubble: enormous stone blocks, blackened beams, cracked plaster, and bits of broken slate lie scattered about. A crumbling staircase climbs a wall of the tower, rising towards a second story that no longer exists.*

The storm rages above, driving icy rain down through the skeleton of timber and slate.

Searching through the rubble reveals the ancient bronze bell, cracked and tarnished with weather and the passage of time. The bell tower was struck by lightning and destroyed the night the Mad Prince swore her soul to Mammon.

Those uncovering the bell find that it is still hot to the touch and stinks of brimstone.

Careful investigation of the floor reveals five separate flagstones, each scored with a blackened pentagram and concealing an alcove in the floor. If the flagstones are pried loose the PCs discover a skeleton buried beneath each of the five flagstones. The five skeletons radiate a burning heat and bear the mark of heresy emblazoned on their skulls, but pose no threat to the PCs.

10 Bells: Upon the tolling of the tenth hour the tower returns to its un-ruined state: an intact three-story bell tower. A great pull rope, braided from human hair, hangs down the center of the tower. The body of a masked, robed figure hangs by its neck from the rope 10' off the ground.

The mask is fashioned from hammered copper and gives the figure the appearance of a leering horned fiend.

Unless the PCs take special pains, removing the body (either by pulling it down to ground level, or cutting the body free) causes the bell to toll. The sonorous tone sounds throughout the manse, shaking the floor of the bell tower, and causes the skeletons of five heretics to rise from beneath the flagstones. Each of the skeletons is wreathed in blue flames and appears bound to a stake, though this in no way impedes their ability to move or attack.

The flaming skeletons – enemies of House Liis that were burned alive at the stake – watch on in silence, unless one of the PCs is wearing one of the heir masks (including the horned mask found on the corpse of the priest).

If none of the PCs is wearing an heir mask, the flaming skeletons plead with the party, "Free us, free us all," before vanishing back into the floor.

However, if any one of the PCs is wearing one of the heir masks, the flaming skeletons howl in agony, tear free from their phantasmal stakes, and attack.

The flaming skeletons attack the mask-wearer and anyone that defends the PC. They hammer at their foes with flaming limbs; on a successful attack a target is also set aflame, taking additional 1d6 damage per round until the flames are extinguished. On a critical hit, a cloud of smoke envelops the skeleton and the PC; when the smoke clears the following round, the heretic skeleton is gone, but the PC is trapped in place, bound to a flaming phantasmal pyre. The PC (and any other character coming within 5') takes 1d16 damage per round from the phantasmal fire until freed (a move action by another PC) or breaking free of the ghostly bonds (DC 15 Will save). One attempt at the Will save can be made per round.

The **Horned Mask** is decorated with hammered copper scales atop a molded leather mask with red silk ties, and is one of the house's masks. Worn by Jost, the mask grants the character the 1d14 ability to lay on hands per the cleric ability. If that PC is also a cleric, it instead adds a +1d7 bonus to the cleric's lay on hands. This power is granted by the haunted manse, and quite removed from the real world; wounds healed in this manner will forever bear jagged, discolored scars. See Appendix B for details on the heir mask's shared powers.

Burned Heretics (5): Init +2; Atk flame fist +2 melee (1d5 + flame); AC 10; HD 2d12; hp 12 each; MV fly 30'; Act 1d20; SP un-dead; SA crit on 19-20, pyre burn; SV Fort +2, Ref +4, Will +6; AL C.

Area A-6 – Hanging Gardens: *Icy rain pelts the open courtyard, pooling in the gloom. Sprawling greenery hangs from stone terraces arrayed about the gardens. In the flash of lightning you spy a marble statue, pale and pearly in the gloom.*

The terraced gardens are overgrown with thick, ropery vines and thorny hedges. A moldering carpet of rotting leaves litter the flagstones, and the disease-wracked trees have the impression of skeletal hands clawing free of the earth.

The statuary is set atop a dais in the center of the courtyard and depicts a mother surrounded by adoring children. The number of children matches the number of PCs. All but one of the marble children is defaced, their faces smashed and cracked. Close inspection of the surviving form reveals that it depicts a female, and is the tallest of the brood. A clever investigator may (rightly) guess that the surviving statue depicts the oldest of the children.

The statue is a cenotaph, marking the burial place of the matriarch of House Liis, Lady Baethor. Her body lies in a shallow tomb concealed beneath the statue. There is no sign of the tomb from above, or apparent portal to open, but passing dwarves will smell gold below. Opening the

tomb requires removing the statuary. It can be tipped over with herculean effort (DC 25 Strength check), or toppled with the aid of rope or poles.

The storm grows in intensity as the PCs work on the statue. As the statue topples, there is a harrowing crack from above and a thunderbolt strikes the falling statue. Any character within 10' of the statue (or connected to it, via a wet, conductive, rope) is hurled 1d10' feet by the blast and must make a DC 15 Fort save or take 1d12 points of damage.

In the aftermath of the lightning bolt, PCs find a small nook beneath where the statue once stood. There, placed in a vertical hole, is an iron sarcophagus, chased with silver and gold. Hoisting the coffin free of the rotting earth, PCs discover that the cover of the sarcophagus once depicted a lovely woman with silver hair; the hammered silver and gold is worth 170 gp to any grave robber miserly enough to chip and pry it free.

The sarcophagus is secured with three simple locks (DC 10 Pick lock check). Inside is the desiccated body of Baethor Liis, wrapped in swaths of stained cotton. The shrunken body is dried and rigid, but if cut, bleeds a thick black ichor. Very careful examination of the body (nearly impossible outside, in the storm) reveals the faintest of heartbeats. Driven by the love of her children, the matriarch of house Liis is returning to life.

With but a single hit point, Lady Baethor is easily killed. Staking, beheading, or setting fire to the comatose body slays the matriarch once and for all. However, if left to her own devices, she returns to full power within an hour and begins to stalk the PCs through the manse. Her aim is to reclaim (kill) all her children (the PCs) before they fall prey to Mammon.

Lady Baethor travels primarily along the walls and ceiling. On a successful attack she hoists her target from the floor, and presses her foul lips to theirs, exhaling a gout of diseased miasma into the target's lungs; the PC must attempt a DC 15 Fort save. On a successful save the PC is left stunned, coughing the miasma from his lungs for 1d3 rounds. However on a failed save, the character collapses to the ground, only to rise 1d3 rounds later – a zombie under the matriarch's command. If the matriarch is slain, the zombie regains its freedom, but remains an un-dead. Un-dead characters are immune to cold, electricity, and mind-affecting attacks, but may be turned, damaged, or killed as un-dead of the same HD.

Should the matriarch catch up with the PCs after 12 bells, she hurls herself at the archdevil, shrieking that he cannot have her little ones. Mammon destroys her in battle, but her sacrifice buys the PCs 1d3 rounds of action.

Lady Baethor Liis: Init +2; Atk kiss +4 melee (1d3 + miasma); AC 13; HD 4d12; hp 1 (24); MV climb 40'; Act 1d20; SP un-dead; SA miasma kiss; SV Fort +2, Ref +4, Will +6; AL C.

Area A-7 – Great Hall: *A vaulted hall stretches before you, anchored by a great stone fireplace on one end and a wall of towering bronze plates on the other. Between them are three long tables, capable of seating an entire company. The tables are set for a grand feast, laden with wooden bowls, drinking horns, and knives – all draped with cobwebs and the dust of centuries.*

The walls are hung with flower garlands, long since wilted and dead.

Judge's note: This area is also the site of the adventure's conclusion – a dramatically different sight. See Appendix A for the changes wrought in the hall come midnight.

Prior to **10 bells**, the hall is disarmingly mundane. The walls are hung with trophies from the family's storied history: sundered shields emblazoned with the heraldry of a dozen city-states; captured swords, lances and spears from exotic lands; moth eaten war-standards and battle signs; and the bronze-dipped skulls of fallen foes. The fireplace is cold, the last fire having burnt out centuries ago. All are covered in dust and cobwebs and haven't been disturbed in one hundred years or more.

The tables and the settings are perfectly normal, save for one. At the head of the tables is an oversized throne, capable of seating a 14' tall giant. The massive chair is carved in the likeness of hellfire, the flames composed of leering imps, howling skulls, and bodies writhing in torment.

At the right hand of the giant's throne is a similar chair, with identical carvings, but human-sized. The smaller chair is hung with a dusty, lace wedding veil.

As the manse sinks closer to hell through the course of the night, the appearance of the hall changes, as follows:

After 9 Bells: Upon the sounding, the faintest wisp of smoke drifts from the fireplace. Quiet groups can hear the clatter of crockery and faint laughter, and detect the smell of roasting meat.

10 Bells: Traceries of phantasmal courtiers, bedecked in grand costumes and elaborate masks, enter from the halls. Nearly transparent, the visions are best seen out of the corner of one's eyes, though if the lights were lowered, the visions seems clearer and more real. The courtiers seem unable to see, hear, or interact with the PCs. The sole exception is if one or more of the PCs is wearing a house mask. Seen through the masks, the courtiers are fully real, and can interact with the PCs as per the Devil's Masque.

The flowers hung from the walls begin to recover, slowly returning to bloom. The petals remain black, and drip a shiny ichor that pools on the floor.

11 Bells: The phantom courtiers are rendered flesh and blood, the tables are set with rich food and drink, and cacophonous music fills the air. The wedding flowers return to full bloom.

12 Bells: The archdevil Mammon arrives, bringing the adventure to a conclusion. See Appendix A for the adventure's finale.

The Hidden Level: The hall is vaulted, the ceiling rising some 30' from the floor. Thorough explorers will note a series of low, narrow windows set 20' above the floor in the south and east walls of the hall. These should open to the hallway or area A-8 but quick exploration of those areas reveals low-ceilinged chambers, with no corresponding apertures.

Skilled climbers can easily reach the window (DC 10 Climb walls check), but the narrow embrasure restricts passage. Elves and halflings can climb up the narrow stone chute with little difficulty, but humans and dwarves must first divest themselves of armor and backpacks before ascending into area C-1.

Area A-8 – The Bower: *The doors open to a low-ceilinged chamber appointed with a profusion of pillows, embroidered mats, fur rugs, and rich tapestries. Across the chamber is an enormous wardrobe of dark polished wood.*

Three veiled women in gossamer dresses rise from the pillows, crossing towards you with otherworldly grace.

The ladies-in-waiting were once attendants of Lady Ilse. The Mad Prince had them beheaded and their heads secreted away. For long years the spirits sought out their missing heads; now that they have been found all that remains is for the heads to be freed and placed on new hosts.

The ladies usher any PCs into the bower, divesting them of armor and arms. The ladies offer up ancient regalia – moth-eaten, dusty, cobwebbed rags of lace, velvet, and silk. If the PCs play along, the lissome maids insist that no lord or lady could possibly attend the fete without a mask. The ladies-in-waiting present three rosewood boxes to the PCs. Roughly one foot in length on each side, each box is secured with a delicate silver clasp and inscribed with the PC's name. The names are accented with a dull gray metal, readily identified as lead.

Characters opening the boxes discover severed heads adorned with delicate masks. The flying heads hiss and launch themselves at the PCs. At the same time, the ladies-in-waiting lunge forward, attempting to restrain the PCs. Tearing away the veils reveals that the ladies-in-waiting are headless; it is the ladies' own heads trapped within the wooden boxes.

Combat: The heads' aim is to attach to the PCs with the highest Personality, preferring elves over humans, and humans over dwarves or halflings.

The headless maids grapple with the PCs. On a successful attack roll the PC is held in place, suffering -2 to AC and Ref saves.

The flying heads direct their attacks at held (or unconscious) PCs; on a successful attack roll, the head's spiked spinal column bores into the PC, inflicting 1d4 damage.

Escaping from either the grapple or the head requires a move action, and a DC 10 Fort save or Strength check for each attempt. Held PCs must escape the grapple before attempting to tear free the flying heads.

If a head remains attached for 3 rounds it fuses bodily with

the PC, tying into arteries, nerves, bones and muscle. The PC now has two heads. Thereafter any damage done to a head is also suffered by the host PC. *Example: If an attached head is dealt 3 points of damage, the host PC also takes 3 points.* Once a head is fused to a PC's body, the freshly two-headed PC must make a DC 5 Will save each round or be forced to take the head's course of action – usually aiding attacks on the party. In general, the head aims to cause evil, but its first goal is survival.

Attached heads can be slain and then cut off (a gruesome process) or exorcised from the body with a DC 25 lay on hands check. Desperate characters are sure to come up with even more clever and terrifying solutions.

Heir Masks: The three flying heads all wear heir masks. In addition to the shared powers detailed in Appendix B, each mask displays special powers when worn by its rightful owner:

- **Wolf:** Long-nosed, and molded with thick, velveteen hair, when worn by Sabian the Wolf Mask grants a +3 to attack and damage rolls. Additionally the mask grants the wearer critical hits on a 19 or better. If the wearer is already a warrior or dwarf, his crit range increases by 1.
- **Medusa:** The Medusa Mask is decorated with a dozen emerald snakes. When worn by Demut, the mask grants the 1d14 ability to cast the following spells: *shield, magic missile, color spray*. The spells are lost per the arcane spellcasting rules, and not regained. The wearer can spellburn per the wizard and elf rules.
- **Crow:** Decorated with iridescent black feathers and a long, arcing beak, the mask stinks of blood. When worn by Kethe, the mask grants the wearer the ability to burn luck as per the halfling class rules. Spent Luck is regained per the same rules, even after the mask is defunct.

The Servant's Passage: Characters taking the time to explore the chamber's back wall discover a simple wooden door hidden beneath the layers of silk tapestries. Short, narrow, and secured with a simple lock (DC 10 Pick lock check) the door was once used by the servants of the manse to access the high halls (level C). Ignorant of the passage, the Mad Prince failed to have the passage blocked. The door leads to a narrow stone stairway that rises to area C-1.

Headless Ladies (3): Init -2; Atk strike +3 melee (1d5); AC 11; HD 3d6; hp 10 each; MV 30'; Act 1d20; SP un-dead; SV Fort +4, Ref -2, Will +2; AL C.

Flying Heads (3): Init +3; Atk spinal bore +3 melee (1d4); AC 15; HD 2d8; hp 8 each; MV fly 40'; Act 1d20; SP un-dead; SA spinal tap; SV Fort +4, Ref +1, Will +2; AL C.



LEVEL B: THE CATACOMBS



Hidden beneath the manse, the catacombs were once the final resting place of House Liis and its servants. Over the decades the manse has slowly slipped into the swamp, and the mere water has begun to fill the catacombs. The murky water is preternaturally cold, and a 5-inch layer of muck covers the original stone floor, sucking at the PCs' boots with every step.

The chambers are all carved from rock. Arching columns support the ceiling, decorated with the perverse iconography of House Liis (demons, hellish sacrifices, and diabolic couplings). The ceiling, some 20' high in most places, is similarly decorated with flaking murals and worn carvings. Climbing the pillars and walls is a simple task (DC 10 Climb check).

Except where noted there is no light in the catacombs. The chill air is wet and still, and stinks of decay.

Area B-1 – Undercroft: *Wide stone steps, slick with mold and slime, curl down into what was once a vaulted chamber. Now a black lake occupies the chamber, creeping up the steps, concealing the chamber floor. Tall columns, some canted at odd angles, support the crumbling ceiling.*

A quiet melancholy hangs heavy over the waters.

Black with marsh-soil, the water is 3' deep in most spots. The water conceals hundreds of skeletons – victims of the Mad Prince. Careful prodding reveals the thousands of bones; nearly all were once humans, though the skeletons of war dogs and horses also lie amidst the carnage.

All of the skeletons are the remnants of single mass sacrifice – the Mad Prince's attempt to stave off her devil's bargain. The offering failed and their souls remain trapped within the vile manse.

The skeletons animate when the first PC comes into contact with the water. They rise, dripping, from the murky waters, gazing towards the PCs with eye sockets that glow like dying embers; there are 50+5d20 skeletons in all. All stand silently and point towards area B-3: the source of the foul magics binding their souls to the manse.

The skeletons pose no threat to the PCs, unless the characters attempt to leave without stealing Mammon's *soul stone*. If the PCs break the circle in area B-3, all the skeletons collapse into the water, their souls freed from bondage.

However, if the PCs try to leave the undercroft without the *soul stone*, they are faced with a far different challenge. Terrified at the thought of being left for all eternity, the skeletons attack. The party can retreat back into area B-3, but if they attempt to press forward, they are set upon by the bone horde.

The skeletons aim to overbear the PCs, drowning them beneath the murky waters. On a successful attack, a skeleton does no damage, but instead clings to the target. At the end of each round, a held PC must make a DC 5 Fort save, or be dragged beneath the waters. Each additional skeleton in-

creases the save DC by +5 and reduces the PC's movement by -10. At the start of each round, submerged characters can attempt to stand free of the water (but remain trapped by the skeletons) with a successful Fort save.

Breaking free of a single skeleton requires a DC 10 Strength check, or slaying the un-dead.

Slain or turned skeletons collapse into the water. However, their spirits retain much of their power. Track the skeletons as they are destroyed: once ten are slain, they rise up as towering thing of bone, lashing out in fury at the PCs with spiked limbs formed of shattered bones. The more skeletons the PCs destroy, the more powerful the Thing becomes:

Slain Skeletons	HD	Ttl hp	Action Dice	Dmg	Save Bonus
10	4d8	15	1d16	1d6	+0
20	6d8	30	1d20	1d8	+3
30	8d8	45	1d20/1d16	1d10	+5
40	10d8	60	1d20/1d16/1d14	1d12	+7
50+	12d8	75	1d24/1d20/1d16/1d14	1d14	+9

Protected by the combined horror of its collective soul, the conglomeration of bones cannot be turned or destroyed by a cleric's faith; a turn unholy check sufficient to turn or destroy, collapses the Thing back into the inky waters for 1d3 rounds.

The Thing is too large to pursue PCs outside of the catacombs, or further than area B-3.

Thing of the Undercroft (bone golem): Init -2; Atk spiked bone +0 melee (variable); AC 10; HD variable; hp variable; MV 45'; Act variable; SP un-dead, half damage from piercing and slashing weapons; SV Fort +3, Ref +0, Will +1; AL C.

Skeletons: Init +0; Atk claw +0 melee (1d3); AC 9; HD 1d6; MV 30'; Act 1d20; SP un-dead, half damage from piercing and slashing weapons; SV Fort +0, Ref +0, Will +0; AL C.

Area B-2 – Water: If the PCs fall into the cave from area A-3a, mundane light sources are extinguished as they strike the water.

Though the PCs' entrance can be dramatically different, this area is functionally identical to area B-1. The skeletons do their best to ensure that PCs failing to destroy the magic circle don't leave the catacombs alive. See area B-1, above, for details.

Area B-3 – The Gate: *The narrow cave grows warmer, leaving the chill of the icy water behind. The passageway opens to a small cave, some five paces across. Burned candles – some little more than pools of hardened wax – are set about the stone floor according to some curious pattern.*

A dull violet glow and the stench of sulfur emanate from a rough-hewn pit in the center of the rocky chamber.

The candles mark the points of a thaumaturgic circle. As the PCs approach, the candles sputter back to life, spitting sickly yellow smoke, choking the air. Moments later the smoke forms into spectral traceries of hundreds of figures – the men, women and children sacrificed in the summoning of Mammon. The forms look on in silence, refusing to take action.

The pit is roughly 10' across, and of inestimable depth. Mammon's *soul stone*, the reliquary of the arch-devil's true-name, hovers some 15' down the pit. Six inches in diameter and cut with 414 facets, the dark gemstone pulses with malevolent violet light. Employed by Lady Ilse to summon the archfiend, the stone can also lend the PCs a degree of mastery over Mammon.

Characters attempting to cross into the circle (as circumscribed by the candles) encounter an invisible resistance, and hear demonic voices whisper: "We shall know our masters by their actions." The resistance equals the force of the PC attempting to enter; a PC can press 3 to 4 inches inside the circle, but is always rebuked.

Characters pausing to inspect the circumference of the circle discover three distinct pools of blood, a clue to one means of passage into the circle.

There are three means of entering the circle, though clever players are sure to attempt others. Judges are – of course – welcome to adjudicate unusual, thematically appropriate means as they see fit.

- **We Shall Know Them By Their Actions:** Even among the fiends of the lower planes, the sons and daughters of House Liis are infamous for their backstabbing ways. A PC that spills the blood of another PC while in the room is able to cross the circle.
- **Holy Passage:** A cleric successfully calling for divine aid (DC 10 or higher) drops the magic circle, dismissing the circle and its demonic forces. A lay on hands (DC 20 or higher) drops the circle for 1d12 rounds. At the end of this time, the cleric must make a second DC 20 spell check, or all the characters within the circle are violently expelled, taking 1d5 damage.
- **Sword Magic:** For reasons unknown to scholars, demonic circles can be dismissed by the blow of a magical sword wielded by the sure of heart. Only magical swords function in this way – other weapons are insufficient, regardless of enchantment. Upon striking the circle with a magical sword, the PC must make a DC 15 Will save. On a successful save, the circle is dismissed. On a failed save, the circle flashes violet, and lashes out at the PC, for 1d5 damage.

To those remaining outside the circle, PCs passing through appear as their former selves: the sons and daughters of House Liis. Characters that have studied the tapestries in area A-3 can readily identify the PCs' associated personas.

Once inside, PCs note twinkling crimson motes drifting from the pit. The lip and walls of the pit are worn and rough; the *soul stone* has been literally eating its way to hell, consuming all material and boring out the pit. If anyone falls into the pit, on this night of nights, the character falls 500' before passing through to Mammon's lair. At the discretion of judge, the PC





can return (horribly transfigured and transformed) with Mammon at the tolling of 12 bells.

The *soul stone* hovers in the air, 15' below the lip of the pit. Descending to the stone is easy (DC 10 Climb or Strength check), and the gem is readily snatched from the air. Any time a character possesses the stone he must succeed on a DC 15 Will save or be overtaken by megalomania, becoming utterly and absolutely convinced that he is the only one worthy of leading the party. If the stone is handed off, the mania passes after 1d5 minutes, but the PC will hunger for possession of the stone for as long as he lives. Given an opportunity to steal back the stone, the afflicted PC must make a DC 10 Will save or succumb to the temptation.

The *soul stone* carries Mammon's true name. Clever PCs can use the stone to bargain with the devil, while more daring (or foolhardy) characters can attempt to use the stone to achieve actual mastery over the archfiend.

Exiting the Catacombs Level: As the PCs exit the catacombs (with or without the *soul stone*), read or paraphrase the following:

Two phantoms appear before you. Rich robes, cloaks and scarves hang from their bodies, heavy with water. They watch you silently from behind elaborately carved masks.

The phantoms watch the PCs for a long moment. If the PCs react with violence – attacking the phantoms, or attempting to turn unholy – they vanish in an instant, leaving only pooled mere-water in their place.

However, if the PCs are restrained, if even for a moment, the phantoms act:

The phantoms take a slow, deliberate step forward. One by one they remove their masks, revealing bloody skulls infested with worms.

They both speak at the same time: the first, "Save us," and the second, "Save yourselves."

The phantoms slowly fade from sight, leaving two masks in a pool of icy water.

These phantoms are the spirits of Josef and Matias sacrificed by Lady Ilse on the night of the great summoning. They bear the following heir masks:

- **Three-Faced Mask:** The mask is crafted to resemble three faces merged into one. Facing left, the mask is screaming. Facing right, it seems to laugh macabrely. Facing forward the mask appears devoid of emotion. When worn by Josef, the wearer seems to shift between multiple positions, granting a +3 AC bonus. The wearer also gains the 1d14 ability to Sneak Silently and Hide in Shadows (the rolls are modified by Agility and armor as the thief skills).
- **Iron Mask:** The mask is nearly featureless, and consists of a thin sheet of iron over cotton padding. When worn by Matias, it grants the wearer the chance to shrug off physical damage. Any round the PC takes damage from a physical attack (mundane or magical) the PC is granted a Will save vs. DC 10 + the amount of damage. If the Will save is successful, the target takes no damage at all.

See Appendix B for additional shared powers of the heir masks.

LEVEL C: THE HIGH HALLS



he upper floor of the manse once housed the chambers of the masters of House Liis. Lady Ilse hid or blocked all the common means of egress to the upper floors of the manse. The only ways of accessing the high halls are via the blocked doors at A-3a, the forgotten stairway at the back of A-8, or by shimmying through the embrasures in area A-7.

Like the rest of the manse the high halls are sodden, cold and lightless. An air of disrepair and melancholia hangs among the peeling walls and fallen tiles. Mirrors hang on all the walls, or lie shattered on the floor. These, along with the pools of water, cast strange reflections in the darkness.

Area C-1 – Mezzanine: *Fallen bits of plaster and broken clay tiles litter the floor of the hall, interspersed with dark puddles fed from the dripping ceiling. The walls and ceiling are hung with strange tangles of prayer beads, dyed silks, solemn idols, icon-laden tapestries, holy chalices, squat clay gods and the like – religious trappings from the far flung edges of the world.*

Characters can access the high hall through the hidden stairs (area A-8), by climbing over the debris blocking the collapsing balcony (area A-3a), or by crawling through the narrow apertures in the great hall (area A-7).

The hall is decorated with prayers to – practically – every god of every pantheon, pleading prayers to rescue Ilse's soul from Mammon's dread grasp. All have failed, but they are still potent in their own right, and present a threat to PCs.

With a careful search, PCs can discover trappings of their own faiths, permitting the characters to accurately "translate" the meaning of at least a handful of the offerings. Seeing the prayer repeated one or more times may clue the PCs into the understanding that all the idols, beads, shrines and the like are pleading for one thing: *Save this repentant soul from the hoary grasp of her betrothed, Mammon.*

None of the myriad of prayers has freed Ilse from her promise. However, the religious implements retain all of their potency. They present no threat to the PCs, so long as they aren't disturbed, a fact that clerics and their ilk are quick to aver.

If these lesser charms are disturbed by a character of another faith, the character must attempt a DC 10 Will save. On a failed save the spirit of the charm comes alive, attacking the PC (and only the PC). The spirit is visible only to the PC; however, if other PCs disturb the same charm, they too are able to see and interact with the spirit. The spirits can either be defeated in combat by those that disturbed the charm, or turned by clerics with a successful turn unholy check.

The form of the lesser spirit is largely irrelevant; the judge should choose a form fitting the specific mythos or roll on the following table. The base form should have other features (for instance a human face, wings, tentacles, multiple heads and limbs) as suits the whim of the judge.

Roll 1d14

- 1
- 2
- 3
- 4
- 5
- 6
- 7
- 8
- 9
- 10
- 11
- 12
- 13
- 14

Base Form

- Monkey
- Insect
- Elephant
- Octopus
- Lion
- Human
- Fungoid
- Dragon
- Devil / Demon
- Sphere of nothingness
- Star traveller
- Snake
- Fish
- Ooze

Once a charm's spirit has been defeated, the spirit can never be called again.

Decorated with precious metals, gems and rare woods, any one of the charms is worth 1d5 x 10 gp. There are over 100 charms ringing the hall, but all are tied to spirits that must be defeated before the charm can be claimed.

Lesser Charm Spirit: Init +2; Atk strike +0 (1d5); AC 10; HD 2d12; hp 12; MV fly 40'; Act 1d20; SP un-dead, immune to non-magical weapons; SV Fort +2, Ref +4, Will +6; AL C.

Area C-1a – Vault Doors: Characters discovering the entrance to the vault (area C-2) find that it is also hung with religious artifacts from a score of esoteric cults. Read or paraphrase the following:

A pair of hammered copper doors bars your way. The doors are festooned like the rest of the hall, with weird artifacts: prayer beads in the shape of skulls, strange idols threaded on leather straps, hammered copper pentacles and several other holy symbols.

The spirits assigned to the charms hung from the doors are far more powerful than their kin hung along the walls. If disturbed, the holy symbols release a greater spirit (whose form can be determined as with the lesser spirits, see area C-1 above).

Bypassing the door requires caution and courage. There are a total of seven symbols affixed to the door. A thief can safely remove a symbol with a DC 20 Disable trap or Pick pockets check, but must succeed seven times. Alternately, a cleric performing a DC 20 turn unholy check can "disable" the charms for 1 round, permitting other characters to remove the holy symbols. One character can remove two symbols in a round this way; with teamwork seven PCs can remove all the symbols in a single round.

If the charms are disturbed (the thief or cleric failing a check, or a character simply batting them aside) a greater charm spirit materializes. Like the lesser spirits, the greater spirit is invisible and immaterial to anyone that hasn't disturbed the same charm. It attacks the offending PC; on a successful strike, it inflicts damage and hurls the PC into

the nearest wall – triggering 1d3 lesser spirits (see above).

Greater Charm Spirit: Init +4; Atk strike +3 (1d10); AC 13; HD 4d12; hp 24; MV fly 40'; Act 1d20; SP un-dead, immune to non-magical weapons, attack hurls target 20'; SV Fort +3, Ref +4, Will +6; AL C.

Area C-2 – Vault of Ilse the Damned:

The gray, dusty walls and floor give way before a bed hung with silk, lace, and nuptial flowers. In sharp contrast to the remainder of the manse, the air is stale and dry. Motes float and hang in the air, buoyed by the shifting air.

Characters drawing aside the silks and lace veils discover that the bed has no mattress. Instead a copper sarcophagus rests atop a low stone bier. The sarcophagus depicts a woman, her arms crossed before her, clutching a rosary.

The sarcophagus is secured with four locks, one on each side. While the locks aren't trapped, the bier-steps before the locks are, shifting beneath 25 lbs. or more weight. Incautious thieves stepping directly to the sarcophagus are attacked by iron spears lancing down from above (DC 15 Ref save to avoid). On a failed save the thief is impaled and pinned by the spears, taking 1d8 damage. The following round an acrid, viscous poison begins to seep down the spear shafts. The acidic poison melts through cloth in one round and leather in three. It takes the poison 1d5 rounds to reach the thief; if the thief is trapped long enough for the poison to work into the wound, the thief must attempt a DC 10 Fort save or perish. The poison works on contact with flesh – those wiping away the poison to buy their thief time will need to exercise extreme caution or fall victim to the same fate.

The spears can be lifted, freeing trapped victims, with a single DC 25 Strength check or three simultaneous DC 10 Strength checks, but characters touching the acidic poison are left to struggle with its effects. Each of the sarcophagus' four sides can be triggered once.

The Sarcophagus: Each of the four locks can be opened with DC 15 Pick lock checks, allowing the lid of the sarcophagus to be lifted free. Beneath the lid is a corpse bundled in linen atop a bed of salt. The linen is held in place with a dozen lead bands; each band is stamped with symbols from a dozen different religions. PCs cutting free the bands and unwrapping the linens reveal the dried, blackened corpse of a small woman in a wedding gown. The desiccated corpse is none other than Lady Ilse.

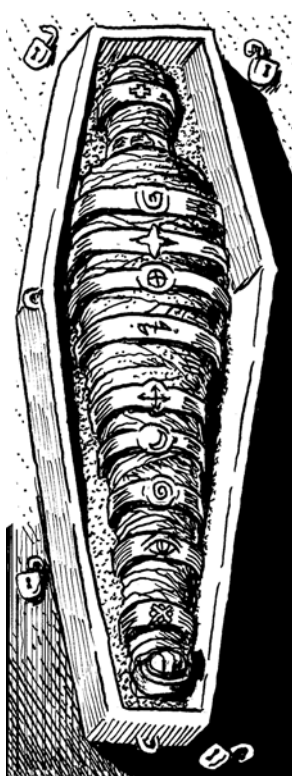

Looped around the ring finger on the corpse's desiccated left hand is a black band – an engagement ring, given to Ilse by Mammon on the night of his summoning. The ring radiates intense heat. Removed from corpse's hand, the ring flares with black hellfire, inflicting 1d12 points of damage every round it is handled. The hellfire is temporarily neutralized so long as the ring is handled with iron (tongs, or the tip of the spear, for instance). Characters donning the ring do so at terrible risk. The sole exception is the character associated with Ilse; this PC can both handle and don the ring without risk, and without taking damage from the ring's heat.

All other characters suffer the following: First, the PC takes the 1d12 damage from the hellfire.

Then, the PC must make a DC 15 Fort save as hellfire roars over his body. On a failed save, the hellfire consumes the PC's arm, and requires a DC 15 Fort save versus death.

If the PC survives the wash of hellfire, he has successfully usurped Ilse as the bride of Mammon. Hereafter, references to the character associated with Ilse are instead references to this PC.

If the PC associated with Ilse (or the surviving replacement) dons the ring, he receives the following benefits and curses:

- The PC is returned to full hit points.
- The PC receives +1 to his Luck stat.
- The character can lay on hands, as a cleric of the same level.
- The character's relationship to any Patrons or God is immediately severed. Henceforth – regardless of his own desires – the PC is the Chosen of Mammon. The judge is free to rule the implications of this association as best suits his campaign. If a wizard or elf, known spells are not lost, but all future spells must be won through negotiations with Mammon.
- The character is overcome with profound avarice. Presented with the opportunity to accumulate wealth, the PC must make a DC 15 Will save or be compelled to do everything in his power to acquire wealth.
- The character is immune to charm or compulsion effects of non-divine origins.

APPENDIX A: THE DEVIL'S MASQUE

10 Bells: As the evening proceeds, the manse slips closer and closer to hell. Beginning with 10 bells, the PCs are able to ascertain the manse's true inhabitants. Faint trceries of regal forms, tumbling jesters, men-at-arms and musicians process down the dark halls, from the moat house to the great hall. Groups pausing in silence can hear faint sounds of celebration – laughter, music, the clack of crockery, and polite applause.

These spectral forms cannot yet perceive the PCs. They pass right through the characters, with only the hint of a chill. Turn unholy checks succeeding on a DC 10 or better dismiss the shapes into vanishing blue wisps. The trceries reform in 1d14 rounds, undeterred by the PCs' actions.

11 Bells: With the tolling, the spectral revelers are rendered in the flesh: lords and ladies, and their entourages, all in elaborate masks. Watchful PCs readily recognize the transformation as it takes place, the specters becoming more and more real with the crash of the great bell. Like the trceries before them, the nobles process from the moat house to the great hall, never venturing into the catacombs (level B) or the high halls (level C).

With the tolling, the great hall undergoes a dramatic transformation. Bright flames spring to life in the hearth and sconces, rich food and drink appear on the long tables, and thick fur rugs and decorated tapestries cover the walls and floor.

Characters traveling level A find it hard to avoid the revelers. Each time the party enters a new area, and every 5 minutes, there is a 66% chance that a band of revelers comes upon the PCs. A band is composed of 1d5 nobles, 1d8 men-at-arms, 1d3 jesters and 1d5 entertainers, all dressed in rich regalia and wearing elaborate masks. All are devils, but this is only apparent to PCs wearing heir masks (see the entry for heir masks in Appendix B).

DC 10 Hide in shadows checks are sufficient to allow thieves to evade the revelers' notice, and with a check of 30 or more, judges may rule that the thief has sufficiently hidden the entire party. Otherwise, the party must resort to other wiles to avoid notice.

If the revelers spot the PCs, they insist that the PCs join them for the grand fete, and brook no protest, calling their comrades, until the PCs are outnumbered 5:1. The revelers don't choose violence of their own accord, but return blows if initiated by the PCs. They fight to subdue the PCs, bearing them to the great hall. Otherwise the revelers simply make themselves a hellish annoyance: masked beauties of either gender plead with the PCs like lost loves, jesters pester the PCs with questions and taunts, and squires harass the PCs, insisting that the masked ball is about to begin.

Characters wearing heir masks suffer none of these dubious attentions. The revelers treat these PCs as their own, letting them come and go at will. With DC 15 Personality checks, the masked PCs can convince the revelers that unmasked

PCs are their slaves, but this check must be repeated each time the PCs encounter more revelers.

Characters donning mundane masks have a chance – albeit slim – of passing as revelers (DC 20 Personality check). Those aided by thieves (DC 15 Disguise self check) are more likely to pass. A check must be made for each PC attempting to pass; the PCs don't know if a disguise is successful or not until encountering one of the devilish revelers.

12 Bells: On the tolling of the midnight hour, the manse undergoes its final transformation. Immediately, all portals, doors, windows, and gates open directly into the masque in the great hall. Any attempt to leave an area, by any means, directly transports the PCs into area A-7. The bells continue their maddening tolling until the PCs arrive.



nce the PCs enter (or are forced into) the hall, read or paraphrase the following: *The pealing bells drive the hordes of revelers into a frenzy. Howling with animalistic frenzy they spin and cavort about the hall in a wild dance. Smaller revelers are crushed underfoot and even the large nobles are sucked into the dark horde, never to emerge.*

The final bell ceases its toll and the mob parts, opening a direct path from the throne to you and your companions. An enormous black form sits atop the throne: a grim, towering form, with curved horns and eyes ablaze with hellfire. Behind the throne, a pulsing portal swirls orange and violet.

The withered old man who first welcomed you into this accursed place stands at the head of the aisle, bearing the bloody head of the stag. The severed head has been gutted and hung with bloody lace to make a grisly veiled crown.

"For the heir of the manor, maid of the ball," the Seneschal declares, holding the dripping head aloft. "Who claims the veil?"

In a seductive voice dripping with malevolence, the devil atop the throne commands: "I have done all I was bid. I gave you a ring to rule the world with the wrath of a fallen god; none could usurp your power. Now surrender to me what you promised. Render unto me my winsome bride."

With the ending of the bells, the revelers' true forms are revealed to all: goat-beasts, adorned in shrouds of flayed flesh; succubi mewling with insatiable lusts; waddling devil-kin, with fat fingers stinking of flesh; arch-cambions and their royal courts; slow flying imps and rolling oozes – all these and worse fill the black manse. The tapestries hanging on the walls are flayed skins. The rich furs on the floor are human bodies, crushed flat, and the food and drink are naught but maggots flesh and curdled blood.

The enormous black being is none other than the archdevil Mammon, come to collect his due: the soul of the Mad Prince. The devil appears as a bare chested 14' tall horned human, arrayed in folds of rich darkness. The dark form clutches a gemstone rod, and drinks from a cracked skull.

Having spoken his part, the devil rouses himself from his



throne and raises a single fist into the air. The air cracks with a thunderclap, and a fiery circlet of hellfire appears in the air. Mammon turns to the PCs, demanding that his bride accept the blazing ring. Any character accepting the hellfire ring is surely doomed, however clever PCs might still escape with their lives (and souls!).



Following are a handful of the obvious choices – some ill-advised – but judges should allow for the wild and creative solutions that can only come from desperate PCs caught in horrific binds.

- **Surrender the Mad Prince to Mammon:** If the PCs can correctly guess the originator of the slaughter, Ilse, and that associated PC willing goes into the arms of the archdevil, the remainder of the party is free to escape.
- **No Fury Like a Devil Scorned:** If the PCs succeed in discovering the engagement ring hidden on Ilse's corpse in C-2, they have the key to their escape. Returning the ring to Mammon, thereby spurning his offer of marriage, voids the devil's contract. Doing so enrages the devil; Ilse's PC suffers the enmity of the arch-devil for the remainder of her soul's existence.
- **False Hand:** PCs that have discovered the arm cleaver (in area A4-a) have the opportunity to dupe the arch-devil. The PCs can sever a living arm prior to the encounter, and present the arm to Mammon. If the arch-devil places the ring on the false hand, the PCs are free to escape the Manse.
- **Begone, Fiend!** Banishing the archdevil is an option, though only slightly less risky than fighting. The banishment cannot be done without possession of the *soul stone*. If the PCs possess the fabled gem, a cleric may attempt a DC 25 turn unholy check. (If the PCs have mastered the gem, they need roll only 15 or better.) On a successful check, Mammon is driven – howling – back through the portal.
- **Deal with the Devil:** If the PCs have mastered the *soul stone*, they can use the power of Mammon's true name to strike a bargain with the archdevil. The judge should call for a DC 15 Personality check and a DC 15 Luck check, and sit back to see how well the players play the role. The judge is obligated to do his very best to twist the PCs' words, honoring the word, but never the spirit of the bargain.
- **To Duel the Devil:** PCs opting to battle the archdevil and his horde of devils face near certain death. They are surrounded on all sides and unable to flee, by either mundane or magical means. Unless the PCs take intentional, defensive tactics, each will be beset by multiple attacks each round; there is no end to the number of devils that can flood the hall.

Slaying one or more devils buys a PC a single round free from attacks. In this way exceptionally deadly (or lucky) PCs might escape the wrath of the horde for a period of time, but eventually even the staunchest of

warriors must fall before the onslaught.

Each PC class is set upon by a specific type of devil. Up to six devils can attack a single PC at once, but careful use of terrain and choke points – or simply fighting back to back – is effective in reducing the number of attacks.

Wizards, Clerics and Elves: Mewling succubi swarm the caster, lusting for the taste of hot flesh. On a successful kiss attack, the PC takes 1d4+3 damage, and must attempt a DC 15 Will save. On a failed check, the PC loses one random spell. On a subsequent round, the spell can be cast by the succubus with a d20+3 spell check.

Succubus: Init +1; Atk kiss +2 melee (1d4+3) or claw +4 melee (1d6+2); AC 13; HD 3d12; hp 18; MV 30'; Act 1d20; SP devil traits, drain spell as above; SV Fort +4, Ref +2, Will +0; AL C.

Warriors and Dwarves: Fighting men and their bearded kin are beset by lumbering, boil-backed devils with scythe-like limbs. If a devil succeeds in slaying a PC, it drives a proboscis down the PC's throat, then sucks itself inside the dead PC, animating the corpse with its former stats the following round. The reanimated PC has the devil's hp, but otherwise has stats identical to those it enjoyed in life.

Boil-Back Devil: Init +1; Atk scythe-arm +2 melee (1d8+2) or bite +4 melee (1d3+2); AC 13; HD 3d12; hp 18; MV 30'; Act 1d20; SP devil traits, critical hit on 18+; SV Fort +4, Ref +2, Will +0; AL C.

Halflings and Thieves: Fat, gamboling devil-kin assault halflings and thieves from every side. Resembling overfed cherubs bursting at the pores, the laughing devils clutch at the PCs like eager children. Any time a halfling or thief attempts to burn Luck (whether aiding himself or an ally), the PC must make a DC 15 Will save. On a failed save, the Luck is burned, but to no effect; instead the nearest luck eater gains 1d7 hp, +1 AC, +1 to hit, damage, and to all saves, for every point of Luck burned.

Luck Eater: Init +3; Atk claw +2 (1d3); AC 10; HD 1d12; hp 6; MV 30'; Act 1d20; SP devil traits; SV Fort +0, Ref +2, Will +0; AL C.



Should any of the PCs don the devil's wedding ring, their fate is inescapable. Mammon claims the PC for his own and returns to hell, dragging the screaming character after.

If the PCs somehow fulfill the devil's bargain without sacrificing their own souls, they have won a decisive victory over the fell being. The diabolic court responds in kind:

Mammon howls his fury, spilling terror through the ranks of lesser devils. The portals about the hall flare with hellfire and the PCs have but four rounds to escape. Call for initiative checks and actions.



Round 1

Initiative Manse Action

- 15 The devils erupt in deafening howls. The judge may rule that the players can no longer engage in table talk, but instead can only describe their actions. The ceiling of the manse cracks and begins to give way. Thousands of coins spill from Mammon's throne. Any PC sacrificing all other actions can scoop up 1d100 coins of copper, silver and gold.

Round 2

Initiative Manse Action

- 10 One by one, the devils are torn back to their planes of torment. They clutch and claw at the PCs. Any character remaining in the great hall must make DC 5 Ref save or be dragged into hell. Gemstones tumble from the cracks in the ceiling. Any PC sacrificing all other actions can scoop up 1d30 gemstones, each worth 1d10 x 20 gp each, along with coins, as above.

Round 3

Initiative Manse Action

- 15 The great hall begins to collapse. All characters in the hall must succeed on DC 5 Ref saves or take 1d14 damage from the falling rubble.
- 10 The floor of the manor gives way, beginning in the great hall and radiating out. Characters in areas A-7, A-6 or A-8 must succeed in DC 10 Ref saves or plummet to their doom. Characters remaining in the hall and giving up all actions for the round can scoop up gemstones and coins as above. If the PCs possess any magical weapons or armor, these items begin to glow with a hell-light, gaining +1 to any previous bonuses.

Round 4

Initiative Manse Action

- 15 Hellfire erupts from below, blossoming throughout the haunted halls. All PCs within the manor-house must succeed on a DC 10 Fort save or take 1d10 damage.

- 7 Mammon makes one final call to PCs remaining within the manor-house. As above, PCs sacrificing actions may scoop up coins and gemstones, and any previously magical arms or armor are increased by a second +1 bonus. Characters failing a DC 10 Will save are consumed by avarice for the remainder of their mortal lives.
- 5 The Black Manse collapses into the darksome swamp. Any PCs remaining within the manse (excluding areas A-1 and A-2) must succeed on DC 10 Fort saves or be sucked under by the dread currents and never heard from again.

Mammon (lesser manifestation): Init +6; Atk rod +12 melee (dmg 3d10+6) or tail +16 melee (1d12+4); AC 22; HD 18d12; hp 89; MV 60' or fly 60'; Act 2d20; SP spells (+10 spell check): *detect good*, *word of command*, *scare*, *charm*, demon traits; SV Fort +12, Ref +8, Will +16; AL C.

APPENDIX B: HEIR MASKS



cattered throughout the adventure, the heir masks offer specific PCs skills and abilities from their former lives. As detailed in their specific entries, the masks only provide these abilities for keyed PCs.

However, all the masks provide the following powers to any that wear them:

- The true form of the revelers is revealed.
- A PC wearing a mask is ignored by the revelers.
- The manse's secret and hidden doors are limned by a faint red light.
- The PC is granted +3 to hit and damage against fellow PCs, and is granted +6 to Will saves against spells and charms cast by fellow PCs.
- The character radiates evil, detectable by *detect evil* and the like.

The masks lose all their powers at the end of the night, whether the PCs have triumphed or failed.

Here is a summary of the masks and where they can be found in the text:

Heir to House Liis

Ilse (Mad Prince)
Ursula
Jost
Sabian
Kethe
Josef
Demut
Matias

Heir Mask

None
Lion Mask (area A-2)
Horned Mask (area A-5)
Wolf Mask (area A-8)
Crow Mask (area A-8)
Three-Faced Mask (area B-3)
Medusa Mask (area A-8)
Iron Mask (area B-3)

LEVEL A



□ = 10

UPTO C1

A8

A7

A6

A5

A3a

A3

A4A

A4B

A4

A4B

A2a

A2

A1

DOWN
TO B-1



BELL TRACKER



PK603

THE HIGH HAIRS

DOWN
TO

Hall Below :A7

narrow
apertures

C1a

Bell
Tower

C2

Hall
Below
:A5

B2

B3

NORTH

THE
CATA
combs

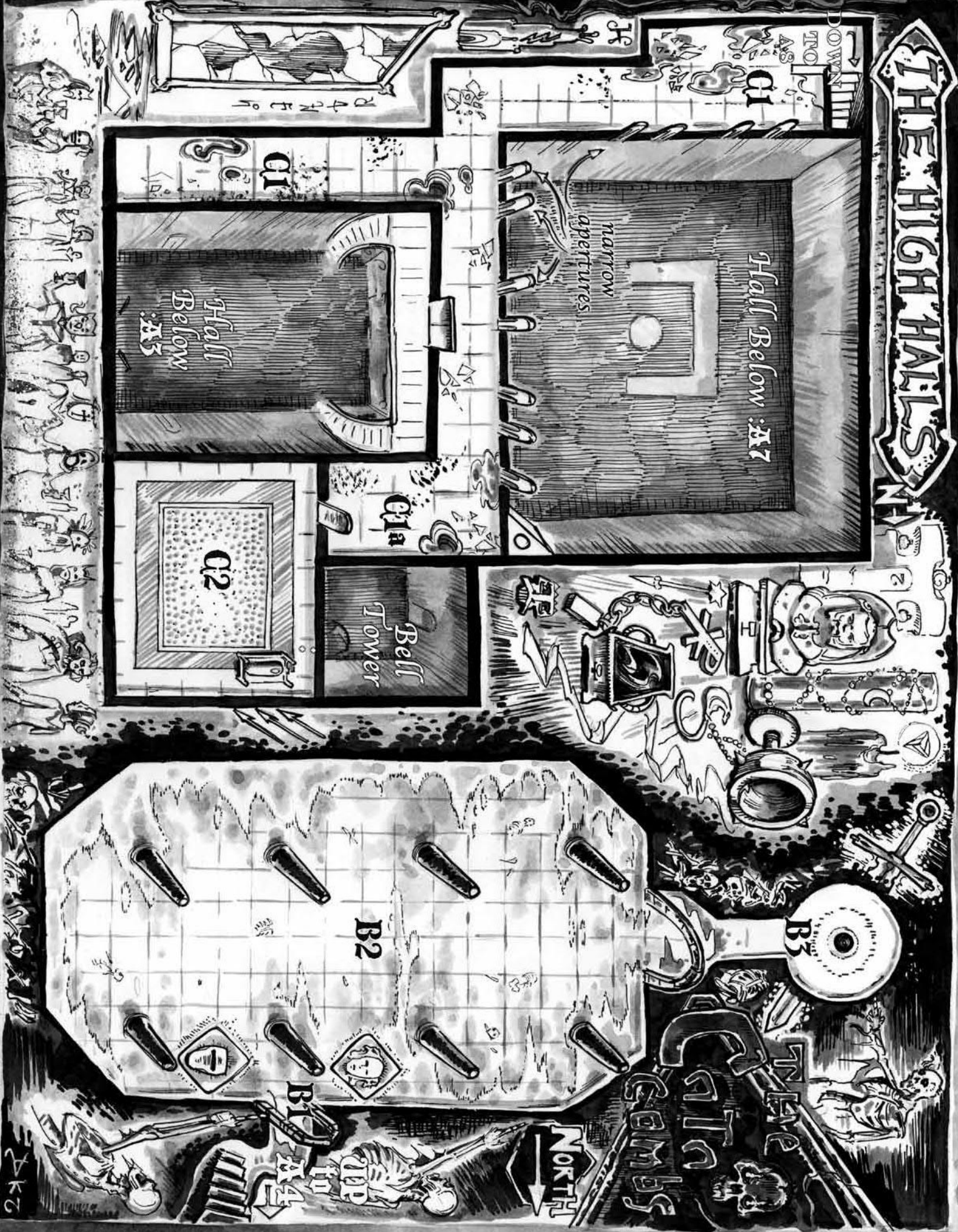

BLOOD FOR THE SERPENT KING

A Level 2 Adventure

By Edgar D. Johnson III • **Editor:** Rev. Dak J. Ultimak • **Playtesters:** Bob Brinkman, Jen Brinkman, Mark Collins, Gabriel Perez Gallardi, John Iverson, Kirk Kirkpatrick, James MacGeorge, Crista Megee, Jason Miller, Adam Muszkiewicz, Michael J. O'Connor, Bill Porter, Wayne Snyder, Phil Spitzer, and Bear Wojteck

INTRODUCTION

Remember the good old days, when adventures were underground, NPCs were there to be killed, and the finale of every dungeon was the dragon on the 20th level? Those days are back. Dungeon Crawl Classics adventures don't waste your time with long-winded speeches, weird campaign settings, or NPCs who aren't meant to be killed. Each adventure is 100% good, solid dungeon crawl, with the monsters you know, the traps you remember, and the secret doors you know are there somewhere.

Blood for the Serpent King is designed for 6 to 8 2nd level characters. Danger awaits the adventurers in this thrilling dungeon crawl set in a mysterious jungle crypt. The PCs must win through fearful denizens and traps both magical and mundane, discover a way to reach the Great Ziggurat, defeat the Emerald Cobra, and escape with his crown!

BACKGROUND

The crypt holds the Emerald Cobra, a long-dead serpent-man named Xiuhcoatl, who first appeared in *DCC #16: Curse of the Emerald Cobra*. Judges also may reference *DCC #35: The Known Realms* for additional information. If the PCs win through to his resting place, they will find him in repose at the top of a great ziggurat. Once disturbed, his spirit will return to battle the transgressors.

Unknown to the players, a group of serpent-men and their shaman will arrive soon. On this night of double full moons, they aim to make an important sacrifice. While the party tackles the various static locations of the crypt, the serpent-men close with them, and attack from behind. During playtesting, the location of this encounter varied. Ideally, it should happen in area 1-3 or area 2-1.

Players could find their way to the crypt by following a treasure map or pursuing rumors heard in a tavern, or they could discover it in a swamp or jungle.



ENCOUNTER TABLE

Area	Type	Encounter
1-1	C	8 savage serpent-men hunters Winged serpent swarm
1-2	T	Pit trap
1-3	C	5 skeletal serpent-men
2-1	P	Undulating bridge
2-2	T/C	Crushing doors 4 guardian statues
3-1	C	Water serpent
3-2	C	The Emerald Cobra Bones of the sacrificed

MAGICAL DEVICES

The crypt contains three Traveling Stones (white, green, and black), three Teleport Circles (also white, green, and black), and two Sending Statues (white and green). A Sending Statue is activated by inserting one of the Traveling Stones into a socket in its base, and then putting blood into a sacrificial bowl. Each Teleport Circle has its own color, linked to the Traveling Stone of the same color. On the ceiling above each Teleport Circle is a mural done in its identifying color and with images related to that destination (Black for area 2-1; White for area 2-2; Green for area 3-1).

AREA DESCRIPTIONS

Area 1-1—Crypt Entrance: After mile upon mile of slog-ging through deep jungle, the party has finally reached its destination. Ahead of you lies a half-buried ruin of dark stone, overgrown with thorny vines and rank fungi, and bathed in the light of the two moons, both of which are full. A great tree stands athwart the ruins, and you can see small winged shapes silently flitting among its branches.

Tall steps lead up to a large, stone door engraved with blocky carvings of serpents, men, and things that are something of both. In the center of the door is a colorful mosaic in the likeness of a serpent-man. In his left hand he holds a crudely rendered humanoid figure, dripping what appears to be blood into a bowl in his right hand. The bowl projects outward from the door itself. It is empty except for some blackish muck and a few leaves.

In the branches of the gigantic tree atop the crypt are dozens of small, feathered and winged serpents. They are non-venomous insectivores, and won't attack unless the PCs attack them first; then, they attack as a swarm.

Winged Serpent Swarm: Init +4; Atk swarming bite +1 melee (1d3); AC 10; HD 4d8; hp 20; MV fly 50'; Act special; SP bite all targets within 20' x 20' space, half damage from non-area attacks; SV Fort +2, Ref +5, Will -2; AL N.

To open the crypt door, the PCs must shed fresh blood into the bowl sticking out from the mural (1 hp damage is sufficient). With this blood sacrifice, the door glows with a fiendish green light, recedes inward, and rolls out of the way.

Eight hunters from a tribe of savage serpent-folk watch from the nearby jungle. The ruin is sacred to their people. They watch and wait unless the party manages to open the door, in which case they attack immediately. The survivors attempt to flee if the PCs kill 4 of them.

Savage Serpent-folk Hunters (8): Init +1; Atk bite +3 melee (1d4 + poison, DC 14 Fort save or paralysis 1d6 rounds) or dagger +3 melee (1d4+1), or short bow +3 missile (1d6); AC 12; HD 2d8; hp 4, 8, 9, 7, 10, 4, 6, 9; MV 30'; Act 1d20; SP +10 to move silently; SV Fort +2, Ref +1, Will +2; AL L.

Another group of serpent-men are traveling toward the crypt bringing, as sacrificial victim, a princess of the savage wood elves who also inhabit this jungle. They arrive 1d4+3 rounds after the party opens the crypt. The group consists of a cobra shaman, four asp-men, and two great python serpent-men. The shaman carries a wooden scepter bearing chips of the Traveling Stones used to activate the crypt's Sending Statues (these function just as the stones themselves), and frequently visits the site to cast sacrifices into the Great Well. The cobra shaman knows the crypt's secrets.

Cobra Shaman (1): Init +1; Atk bite +3 melee (1d4 + poison DC 20 Fort or death), or spit +3 missile (range 40'; DC 14 Fort save or target blinded for 1d3 turns), or +6 spell; AC 14; HD 6d6; hp 20; MV 30'; Act 1d20+1d14; SP +10 to move silently, harmful spell 4 times per day (drain 1d4 each from Strength, Agility, and Stamina, DC 13 Will save or avoid); SV Fort +2, Ref +1, Will +3; AL L.

Great Python Serpent-men (2): Init +1; Atk bite +3 melee (1d4+1) or claws +3 melee (1d4 plus crushing grasp); AC 14; HD 2d10; hp 11, 12; MV 30'; Act 1d20; SP +7 to move silently in jungle, crushing grasp 1d4+1 each round, DC 15 Strength check to escape; SV Fort +3, Ref +0, Will +2; AL L.

Asp-men (4): Init +1; Atk bite +3 melee (1d4 + poison DC 14 Fort or death within 1d3+1 rounds if not healed), or spear +3 melee (1d8), or short bow +3 missile (1d6); AC 12; HD 2d8; hp 4, 12, 11, 6; MV 30'; Act 1d20; SP +10 to move silently; SV Fort +2, Ref +1, Will +2; AL L.

Area 1-2—The Long Stair: *Shallow stairs slope downward into the darkness. Roots from the mighty tree above have broken through the ceiling in places, casting wavering shadows in the torchlight.*

The stairway descends to a landing, where can be found two recessed areas (4x4" and 6" deep), about 7' up, on both the north and south walls. These are difficult to see due to shadows cast by the tree roots (DC 10 Intelligence check to spot). Each recess has a metal ring. Pulling the northern

ring deactivates the pit trap below the landing, locking it in place with a distinct "thunk" sound, and pulling the southern ring flush to the back of its recess. Pulling the southern ring reactivates the trap and draws the northern ring flush. Currently, the pit trap is ACTIVATED.

Beyond the landing, the stairs descend to a bronze door decorated in a serpent motif. These stairs cover a pit trap. If it is not deactivated (see above), then the stairway pivots once half the party has passed the center of the span, dumping them into a pit full of obsidian spikes (2d6+4 damage).

Area 1-3—Antechamber: *The door opens into a large chamber with walls intricately carved to depict serpent-folk led by a cobra-hooded figure. Inside, a large, elevated altar stands, flanked by two statues of spear-wielding serpent-men. On the altar you see a small reliquary made of green stone. On the wall behind the altar is an inscription in the ancient tongue of the serpent-folk.*

The inscription reads (if translated):

Come unto Him bearing the jewels of the winds.

Ride the ghost serpent to the white traveling ground.

Make there an offering first of stone and then of blood.

The sacrifices shall feed the black storm.

The faithful shall follow the emerald road to His kingdom.

The returning pilgrim shall be borne home upon white wings.

Come humbly unto Him in worship,

But disturb not the god-king in His slumber.

The reliquary sits atop a thick slab of dark basalt. It is trapped, but can be disarmed using levers located on the back of each statue. If the trap is not disabled, opening the reliquary causes the statues to turn rapidly, thrusting their spears toward the area in front of it (2d8 damage, DC 14 Ref save for half).

The reliquary holds the three Traveling Stones: black, white, and green. Each of these magical artifacts is spherical and the size of a fist. A chip has been taken from each stone (these are in a medicine pouch attached to the scepter of the cobra shaman).

Three secret doors lead to the north, south, and east.

The northern and southern doors may be opened simply by pressing inward against the doors themselves. They close automatically.

The northern chamber contains partially collapsed shelves of rotted wood, and a variety of pottery vessels, both broken and whole. Most contained long-spoiled foodstuffs, but among them can be found 55 gp, 175 sp, and 1d10 gems worth 2d4 x 10 gp each.

The southern chamber contains the skeletal remains of 5 serpent-men laid atop stone biers. They are clad in robes and wear holy symbols (worth 15 gp each). If disturbed, they rise and attack.

On the floor lie the bones of a dead, dwarven adventurer. He wears rotted leather armor and a bronze circlet with a hinged monocle but no lens. He carries a short sword and a wooden box holding four glass lenses, with space for a fifth lens. He also carries 43 gp. The missing lens can be found on the ground near the door. The bronze circlet and monocle, when fitted with the proper lens, allow the wearer to understand the following languages: celestial, demonic, serpent-man, common, and elven (the loose lens is for serpent-man). Using the circlet without a lens makes the user disoriented (-4 to all rolls) for 1d4 turns (DC 12 Will save to avoid).

The eastern secret door is behind the altar. It pivots on a hub at its left side and opens inward to a steep stairway leading downward to unlocked double doors.

Skeletal Serpent-men (5): Init -4; Atk bite +3 melee (1d4); AC 9; HP 12, 15, 15, 9, 17; MV 20'; Act 1d20; SP un-dead; SV Fort +4, Ref -4, Will +2; AL C.

Area 2-1—The Great Well (top): *Double doors open upon a vast chamber of black stone, lit by dim light from two large statues atop small shelves on the north and south walls (serpent-men with raised lanterns). Lurid carvings of the serpent king's exploits and martial prowess are prominent, and a mural on the ceiling surrounds a thick disk of black stone carved with serpentine script. It depicts humanoid figures plummeting from the sky above a ziggurat.*

The floor in front of you ends in a gaping chasm, across which is another stone ledge, with two massive columns rising to the ceiling, and a squat, triangular doorway leading into the regions beyond.

The Black Teleport Circle, a thick disc of black stone covered in arcane symbols, is on the ceiling of this chamber. If the PCs put the Black Traveling Stone in either of the Sending Statues (found in 2-3 and 3-1), stand in its Teleport Circle, and activate it by shedding blood into the sacrificial bowl, anyone standing in the circle is transported to this location and will fall into area 3-2 (33d6 damage).

In the chasm, 100' below, is sea of swirling black clouds and frequent flashes of red lightning. Falling from the ledge lands its victim in area 3-2, dealing 25d6 damage.

An invisible bridge crosses to the platform on the other side. A *detect magic* spell reveals it. Though something like chalk or dust can show its presence, the ground here does not have either in quantity.

The bridge undulates like a serpent crawling across sand. A PC crosses automatically by standing on it and letting it draw him to the other side. Those attempting to aid or resist this movement must make a DC 10 Ref save or fall.

Narrow ledges cross the chasm along the north and south walls, intersecting shelves holding the illuminating statues. Crossing this way is dangerous (DC 15 Agility check).

Across the chasm, a ledge juts out between two massive columns. An open doorway beyond them leads to the east. The doorway is a squat triangle, 15' high and 40' wide.

The players could climb down to area 3-2, but passing through the cloud level is perilous. It takes 3 rounds to pass through the layer. Each round, the climber must make a successful Luck check or be struck by lightning (1d8 damage, DC 20 Ref save or fall) and pass a DC 15 Will save or suffer major corruption (save for minor corruption).

Area 2-2—Guardian Statues: *The north and south walls beyond the doorway are decorated with bas-relief murals in alabaster, of gigantic serpent-men armed with great spears.*

Checking for traps at the door (DC 12) reveals that the two large slabs of stone are engineered to close when triggered (trigger is between the last two Guardian Statues in area 2-2).

There is a pressure plate located between the second pair of statues. Stepping on it causes the triangular doorway from area 2-1 to release two stone slabs from above. Characters standing in the doorway must make a DC 12 Ref save or take 1d10 damage. Two cranks are hidden behind separate panels in the walls on each side of the doorway, and two more in the columns on the area 2-1 side. They raise the doors and reset the pressure plate. This requires 3 rounds, and the doors only lock into place after the last round. PCs may crawl under the doors as they are being raised.

The area contains bas-relief murals of oversized serpent-men on the north and south sides. Guardian statues emerge from the bas-relief images once a PC has reached the area just west of the trigger for the door trap.

Guardian Statues (4): Init +0 (surprise); Atk great spear +5 melee (1d10+2); AC 16; HD 5d8; hp 19, 17, 21, 25; MV 30'; Act 1d20; SP surprises 50% of time; SV Fort +4, Ref -2, Will -2; AL N.

Area 2-3—White Traveling Ground: *The chamber beyond consists of three rising levels connected by stairs. The first flight of stairs climbs to a landing upon which is set a large, white stone circle with an altar in its center. Beyond, more stairs climb to a gigantic statue of a cobra-man holding a macuahuitl. It gazes down upon the altar. The walls of the chamber are brilliantly white, and adorned with intricate carvings of the skeletons of a veritable bestiary of creatures. On the ceiling, above the white stone circle, is a mural of a white, feathered and winged serpent flying among clouds and stars.*

The first flight of stairs leads to a large circular platform of white stone. In its center is a carved altar of the same stone, with a sacrificial bowl carved into its top. This is the White Teleport Circle. The White Sending Statue stands at the top of the chamber. A prominent socket of bronze juts from its base.

As described earlier, a Traveling Stone must be placed in the socket and blood must be shed into the sacrificial bowl (1 hp damage) to trigger the teleport effect. With both conditions met, beings or objects on the Teleport Circle are bathed in brilliant green light, disappear, and then reappear in the Teleport Circle of the same color as the Traveling stone used (i.e., green goes to green, white to white,

etc.). Using the Black Traveling Stone sends sacrifices to the Black Teleport Circle (on the ceiling of area 2-1), from which they plummet into the depths of the Great Well, down to area 3-2. The Traveling Stone used also accompanies the travelers to their destination, reappearing in the socket of the destination's Sending Statue. However, there is no Sending Statue associated with the Black Teleport Circle. The Black Traveling Stone remains in the socket where it was placed, if used.

Area 3-1—Green Teleport Circle and Sending Statue:

It is as if each of your bodies has been dispersed like dust into a hurricane and then suddenly crushed back together. You find yourselves standing upon a round platform of greenish stone. An altar with a carved bowl in its top stands in its center. A vivid mural around the platform shows a green ziggurat above which floats a smaller pyramid with an eye at its apex. Behind you looms another Sending Statue.

To the east lies a dark lake and a massive ziggurat of green stone, a smaller pyramid of the same stone floating unsupported above it. Above you is a boiling sea of black clouds crackling with red lightning.

A narrow rope bridge crosses to the Great Ziggurat.

The characters must cross the bridge single file, and the water serpent attacks when they do, its weight breaking the bridge. Anyone crossing at that time will fall into the water, but may make a DC 12 Ref save to grasp a rope. It is possible to sneak across to the ziggurat (DC 15 Agility check). On a successful attack, the water serpent will retreat with its prey into deeper water.

Water Serpent (1): Init +4; Atk bite +10 melee (1d6 +constrict); AC 18; HD 8d8; hp 35; MV 30' on land, 40' in water; Act 1d20; SP constriction 1d6+2; SV Fort +6, Ref +3, Will +2; AL N.

Area 3-2 – Great Ziggurat: *The ziggurat looms above the black waters of the lake, bathed in the light of the glowing, green orb at its apex. Tendrils of glowing mist stream down from it, and up into the swirling black clouds. Occasional flashes of red lightning can be seen among them. Steep stairs climb each side of the ziggurat to its flattened summit.*

As soon as the PCs start to ascend the stairs, read the following:

There is a disturbance in the waters behind you as the bones littering the lake's bottom begin climb out of the lake in a growing horde, closing in from all sides.

The bones of the sacrificed attack as a swarm, affecting any target in contact, until the Emerald Cobra is slain.

Bones of the Sacrificed: Init -2; Atk swarming +3 melee (1d3); AC 9; HD special; MV 15'; Act special; SP claw or bite all targets in contact with swarm; un-dead; can only be defeated by destroying Emerald Cobra; SV Fort +0, Ref -2, Will +0; AL C.

Once the PCs have reached the summit of the ziggurat, read the following:

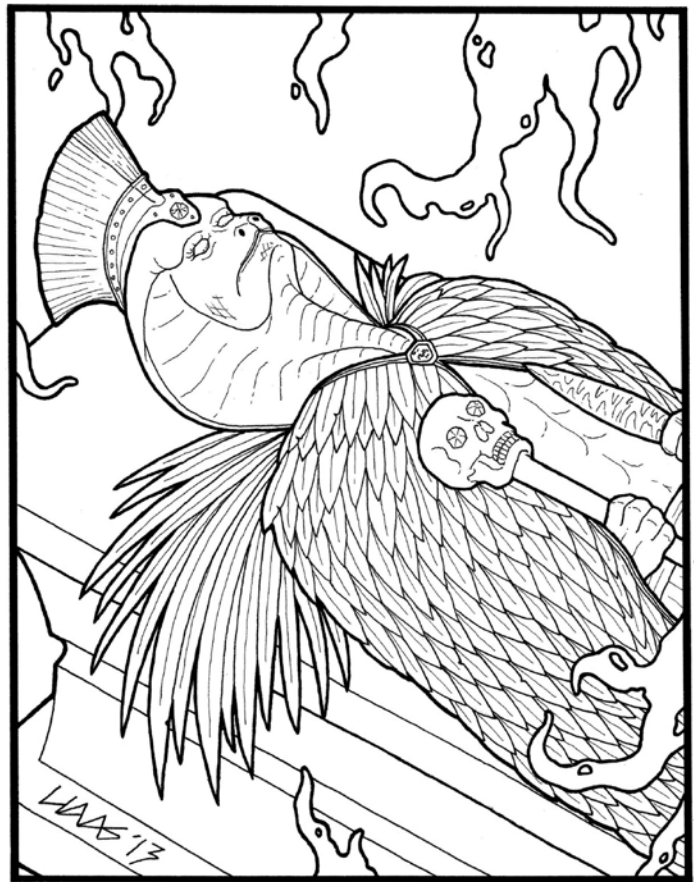

A stone bier carved from green stone supports a large serpent-man with the hood of a cobra. His skin is rough and gray. He is clad in a feathered cape and wears a crest-like crown of gold set with onyx, diamonds, and emeralds. The body lies in an attitude of repose, one hand gripping a scepter of black metal, topped with a ruby-eyed skull. The other holds a long dagger with a plain bronze hilt and an obsidian blade. A light greenish-gold mist drifts down from the floating pyramid's "eye," curling in tendrils around the body. They thicken and stream into the body before you, making it glow with a baleful light. A large gem centered on its crown blazes blue-white, and then dims to the poisonous green of the thickening mist. The creature's stony, gray skin cracks, revealing brilliant green scales and golden eyes. It rises with a hiss, brandishing its weapons toward the sky. A great gust of wind seems to come from the Emerald Cobra himself, blowing you toward the edge of the platform, and red light beams from the scepter.

PCs not standing on the stairs must make a DC 10 Ref save or be blown off the platform and fall to the next level of the ziggurat (taking 1d6 damage). Those who save are blown back from the bier, but do not fall. He also attacks one of the party's warriors with the scepter's missile attack.

The floating pyramid preserves the body against the ravages of time. He also can use it to drain hit points from PCs standing within a 10' radius at a rate of 1d4 hp per victim, until he is slain.

The Emerald Cobra: Init+4; Atk bite +5 melee (1d4+2 plus poison) and others (see below); AC 16 (18 against missile attacks); HD 8d12; hp 50; MV 30'; Act 2d20; SP see below; SV Fort +5, Ref +4, Will +3; AL C.

The Emerald Cobra has many special attacks, but may only make two per round:

- *Bite*: +5 melee (1d4+2 plus 1d8 poison damage, DC 15 Fort save for half)
- *Death Scepter*: +6 melee (1d4+1) or scepter beam +3 missile (drains 1d6 Strength)
- *Blood Drinker (dagger)*: +6 melee (1d4+1 special; dagger causes an additional 1 hp damage per round until PC is healed)
- *Call the Red Lightning*: +8 missile (1d8+3, DC 15 Will save or minor corruption, +1d8 damage and major corruption on critical hit)
- *Call the Winds*: Creates a whirlwind around him (PCs within 20' must make DC 12 Ref save or are blown back 20')
- *Drain Vitality*: Use both attack dice to drain 1d4 hp from each character within 10' radius and add them to his hp total.

The Emerald Cobra's Raiment

- *Death Scepter*: A small mace made of black metal. Its head is a skull with ruby eyes. As a melee weapon it is +1 to hit and does 1d4+1 damage; or it can project a beam from the eyes of the skull. The beam drains 1d6 Strength from the target unless DC 15 Fort save is

made. Using it drains blood from any living user (-1 hp per wielder level, per use).

- *Blood Drinker*: This obsidian dagger is +1 to hit and damage, and causes wounds that continue to bleed (-1 hp per round) until healed magically.
- *Feather Cape*: as leather armor, but +2 AC against normal missile attacks.
- *Crown of Xiuhcoatl*: The crown worn by the Emerald Cobra holds the blue-white gem in which his soul has been imprisoned, and allows him to control the body of anyone wearing it. If the body is slain, his soul returns to the gem in this crown. The crown's gold and gems are worth 500 gp, not counting the blue-white gem. The value of the intact artifact (or just the blue-white gem) is left to the judge's discretion, but discovery of such an artifact draws the attention of powerful enemies.

Area 3-3 – Subterranean Lake: *A still, black lake surrounds the ziggurat, its waters extending into the darkness.*

The lake is from 5 to 50' deep. A search of the lake bottom on the bridge side of the ziggurat reveals a variety of animal and humanoid bones, and small items of crude jewelry worth 5d100 gp (total). A mostly-submerged, sealed door is on the south side of the ziggurat. It's up to the judge to determine what might open it and what the adventurers find beyond it.

This printing of DCC #82: Bride of the Black Manse is done under version 1.0 of the Open Gaming License, and the System Reference Document by permission from Wizards of the Coast, Inc. Designation of Product Identity: The following items are hereby designated as Product Identity in accordance with Section 1(e) of the Open Game License, version 1.0: Dungeon Crawl Classics, DCC RPG, Mighty Deed of Arms, spell check, Luck check, spellburn, mercurial magic, corruption, disapproval, all spell names, all proper nouns, capitalized terms, italicized terms, artwork, maps, symbols, depictions, and illustrations, except such elements that already appear in the System Reference Document.

Designation of Open Content: Subject to the Product Identity designation above, such sections of creature statistics as derive from the SRD are designated as Open Gaming Content.

Some of the portions of this book which are delineated OGC originate from the System Reference Document and are copyright © 1999, 2000 Wizards of the Coast, Inc. The remainder of these OGC portions of these books are hereby added to Open Game Content and, if so used, should bear the COPYRIGHT NOTICE "DCC #82: BRIDE OF THE BLACK MANSE, copyright © 2014 Goodman Games, all rights reserved, visit www.goodman-games.com or contact info@goodman-games.com"

DCC #82: Bride of the Black Manse is copyright © 2014 Goodman Games. Open game content may only be used under and in the terms of the Open Game License.

OPEN GAME LICENSE Version 1.0a

The following text is the property of

Wizards of the Coast, Inc. and is Copyright 2000 Wizards of the Coast, Inc. ("Wizards"). All Rights Reserved.

1. Definitions: (a) "Contributors" means the copyright and/or trademark owners who have contributed Open Game Content; (b) "Derivative Material" means copyrighted material including derivative works and translations (including into other computer languages), potation, modification, correction, addition, extension, upgrade, improvement, compilation, abridgment or other form in which an existing work may be recast, transformed or adapted; (c) "Distribute" means to reproduce, license, rent, lease, sell, broadcast, publicly display, transmit or otherwise distribute; (d) "Open Game Content" means the game mechanic and includes the methods, procedures, processes and routines to the extent such content does not embody the Product Identity and is an enhancement over the prior art and any additional content clearly identified as Open Game Content by the Contributor, and means any work covered by this License, including translations and derivative works under copyright law, but specifically excludes Product Identity. (e) "Product Identity" means product and product line names, logos and identifying marks including trade dress; artifacts; creatures characters; stories, storylines, plots, thematic elements, dialogue, incidents, language, artwork, symbols, designs, depictions, likenesses, formats, poses, concepts, themes and graphic, photographic and other visual or audio representations; names and descriptions of characters, spells, enchantments, personalities, teams, personas, likenesses and special abilities; places, locations, environments, creatures, equipment, magical or supernatural abilities or effects,

logos, symbols, or graphic designs; and any other trademark or registered trademark clearly identified as Product Identity by the owner of the Product Identity, and which specifically excludes the Open Game Content; (f) "Trademark" means the logos, names, mark, sign, motto, designs that are used by a Contributor to identify itself or its products or the associated products contributed to the Open Game License by the Contributor (g) "Use", "Used" or "Using" means to use, Distribute, copy, edit, format, modify, translate and otherwise create Derivative Material of Open Game Content. (h) "You" or "Your" means the licensee in terms of this agreement.

2. The License: This License applies to any Open Game Content that contains a notice indicating that the Open Game Content may only be Used under and in terms of this License. You must affix such a notice to any Open Game Content that you Use. No terms may be added to or subtracted from this License except as described by the License itself. No other terms or conditions may be applied to any Open Game Content distributed using this License.

3. Offer and Acceptance: By Using the Open Game Content You indicate Your acceptance of the terms of this License.

4. Grant and Consideration: In consideration for agreeing to use this License, the Contributors grant You a perpetual, worldwide, royalty-free, non-exclusive license with the exact terms of this License to Use, the Open Game Content.

5. Representation of Authority to Contribute: If You are contributing original material as Open Game Content, You represent

that Your Contributions are Your original creation and/or You have sufficient rights to grant the rights conveyed by this License.

6. Notice of License Copyright: You must update the COPYRIGHT NOTICE portion of this License to include the exact text of the COPYRIGHT NOTICE of any Open Game Content You are copying, modifying or distributing, and You must add the title, the copyright date, and the copyright holder's name to the COPYRIGHT NOTICE of any original Open Game Content you Distribute.

7. Use of Product Identity: You agree not to Use any Product Identity, including as an indication as to compatibility, except as expressly licensed in another, independent Agreement with the owner of each element of that Product Identity. You agree not to indicate compatibility or co-adaptability with any Trademark or Registered Trademark in conjunction with a work containing Open Game Content except as expressly licensed in another, independent Agreement with the owner of such Trademark or Registered Trademark. The use of any Product Identity in Open Game Content does not constitute a challenge to the ownership of that Product Identity. The owner of any Product Identity used in Open Game Content shall retain all rights, title and interest in and to that Product Identity.

8. Identification: If you distribute Open Game Content You must clearly indicate which portions of the work that you are distributing are Open Game Content.

9. Updating the License: Wizards or its designated Agents may publish updated versions of this License. You may use any authorized version of this License to copy, modify and distribute any Open Game Content originally distributed under any

version of this License.

10. Copy of this License: You MUST include a copy of this License with every copy of the Open Game Content You Distribute.

11. Use of Contributor Credits: You may not market or advertise the Open Game Content using the name of any Contributor unless You have written permission from the Contributor to do so.

12. Inability to Comply: If it is impossible for You to comply with any of the terms of this License with respect to some or all of the Open Game Content due to statute, judicial order, or governmental regulation then You may not Use any Open Game Material so affected.

13. Termination: This License will terminate automatically if You fail to comply with all terms herein and fail to cure such breach within 30 days of becoming aware of the breach. All sublicenses shall survive the termination of this License.

14. Reformation: If any provision of this License is held to be unenforceable, such provision shall be reformed only to the extent necessary to make it enforceable.

15. COPYRIGHT NOTICE

Open Game License v 1.0 Copyright 2000, Wizards of the Coast, Inc.

System Rules Document Copyright 2000 Wizards of the Coast, Inc.; Authors Jonathan Tweet, Monte Cook, Skip Williams, based on original material by E. Gary Gygax and Dave Arneson.

DCC #82: Bride of the Black Manse, copyright © 2014 Goodman Games, all rights reserved, visit www.goodman-games.com or contact info@goodman-games.com

1-1
1-2
Trap controls

1-3

black teleport circle
2-1

2-2

2-3

white teleport circle

CRYPT OF THE EMERALD COBRAS

3-2

3-1

3-3

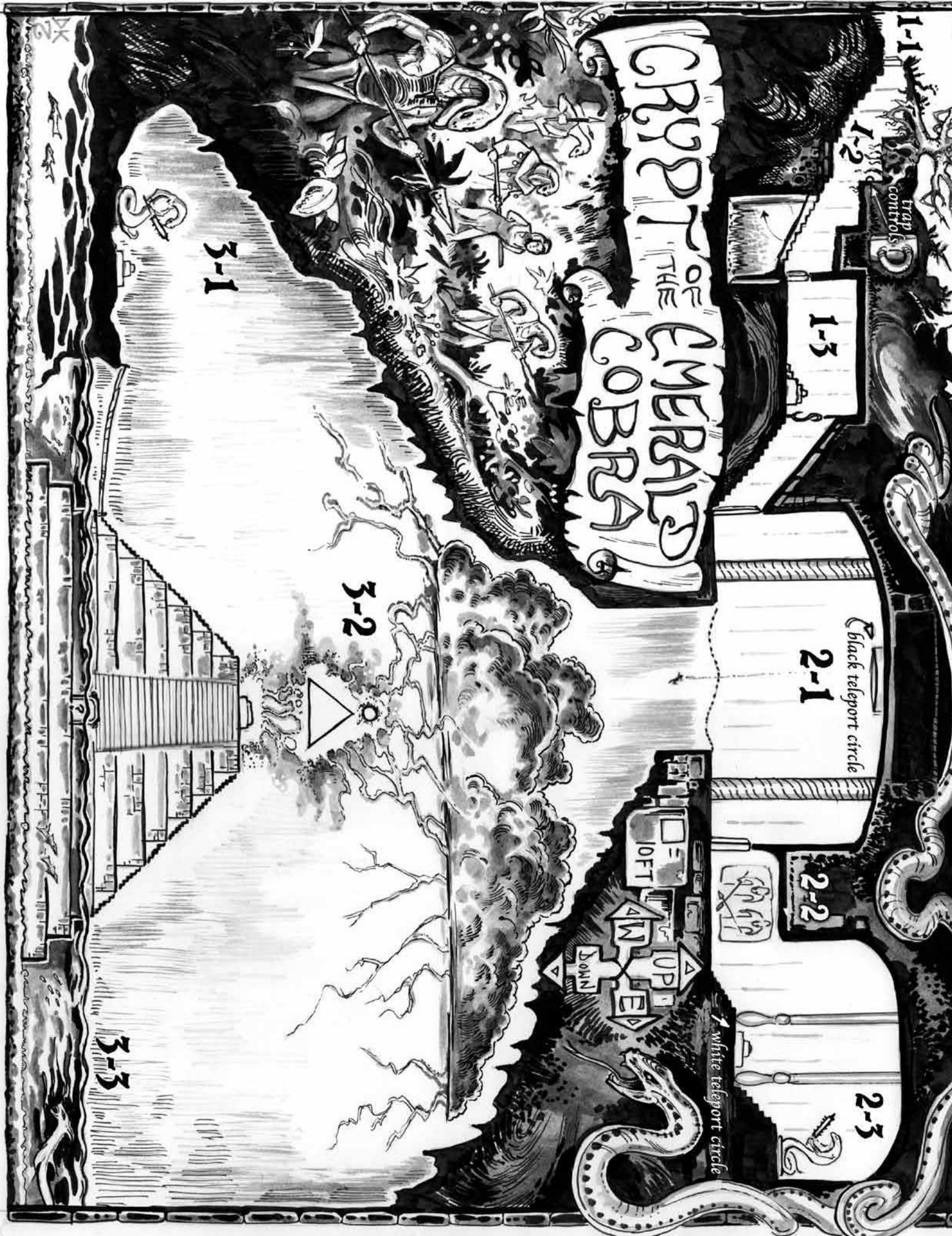

UPPER LEVELS

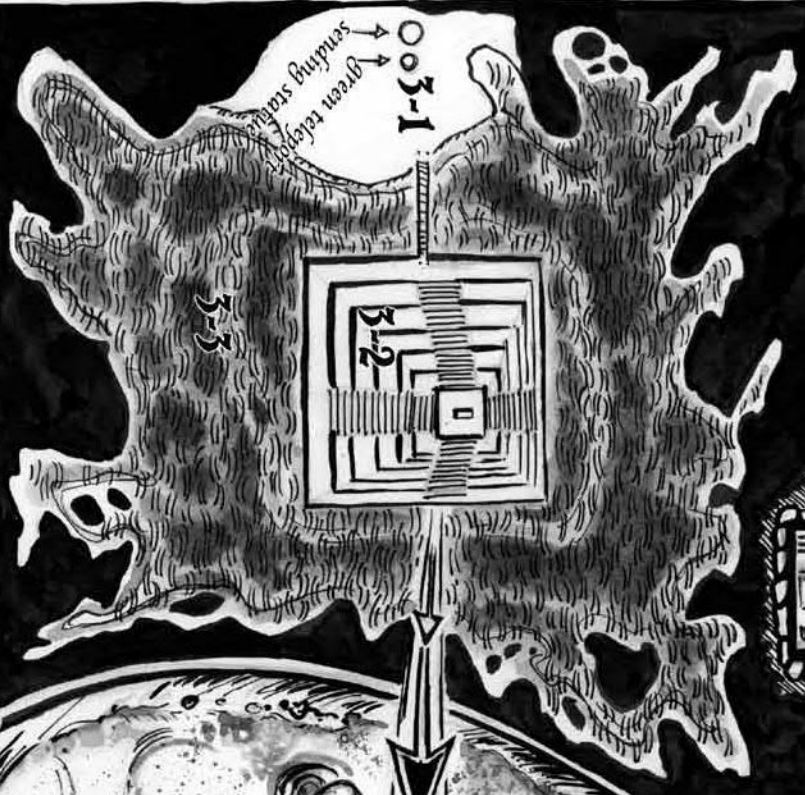
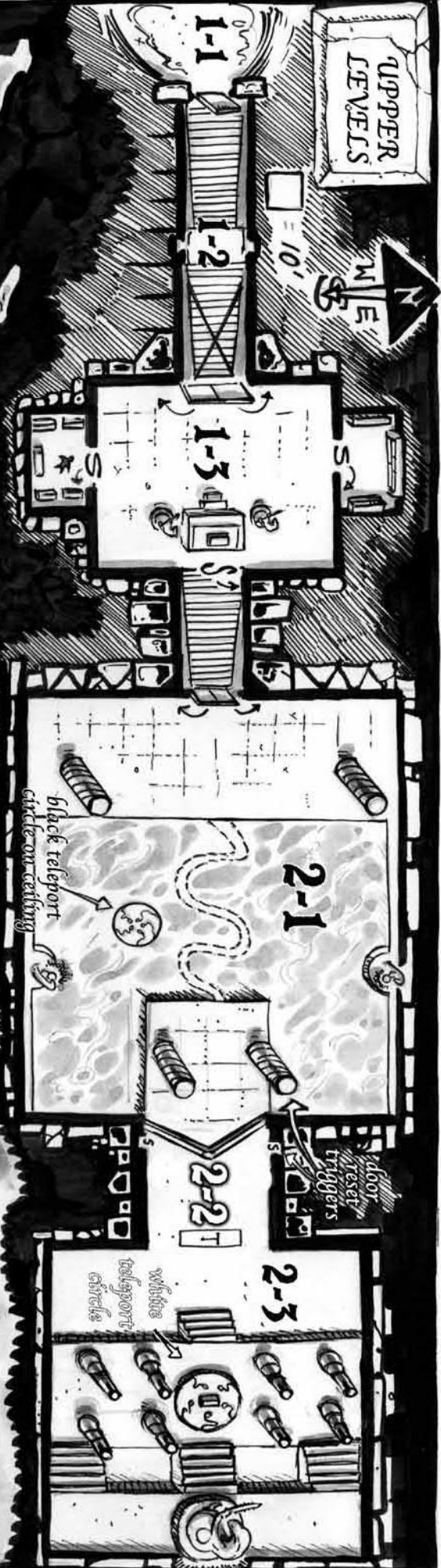

THE ZIGGURATES

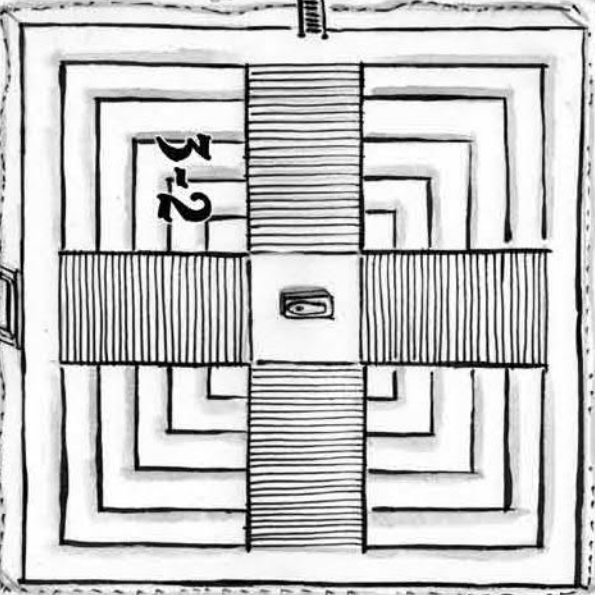

BOTTOM OF THE GREAT WELL

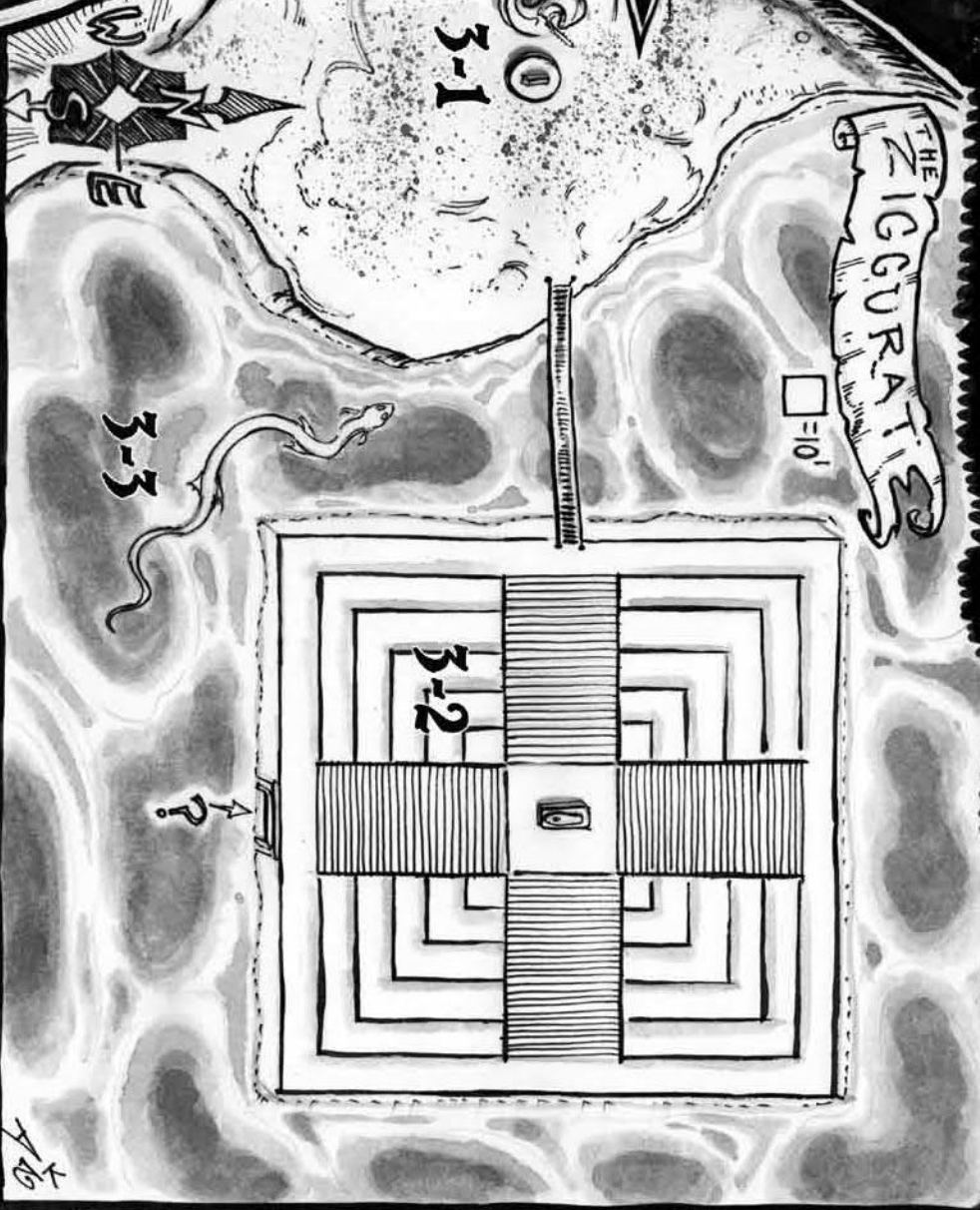

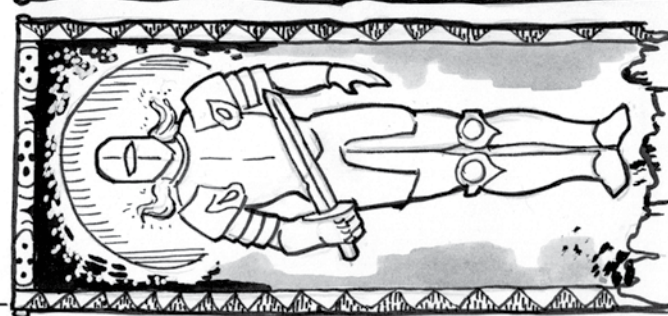
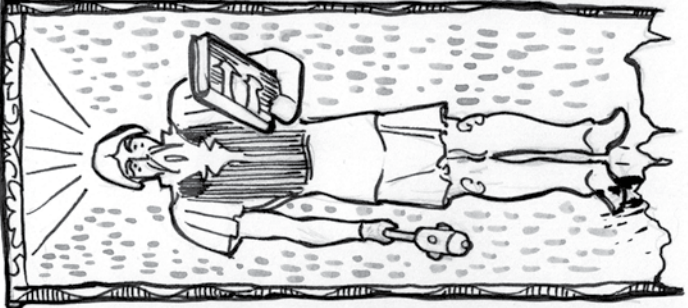
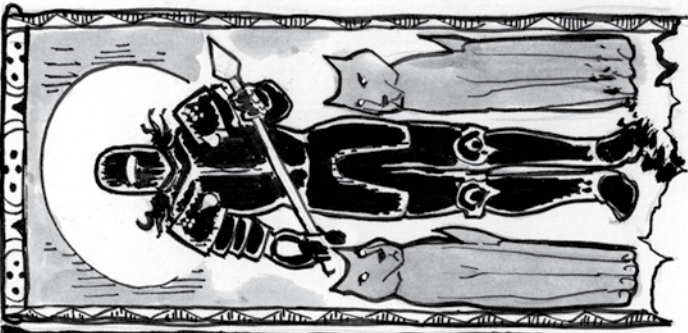
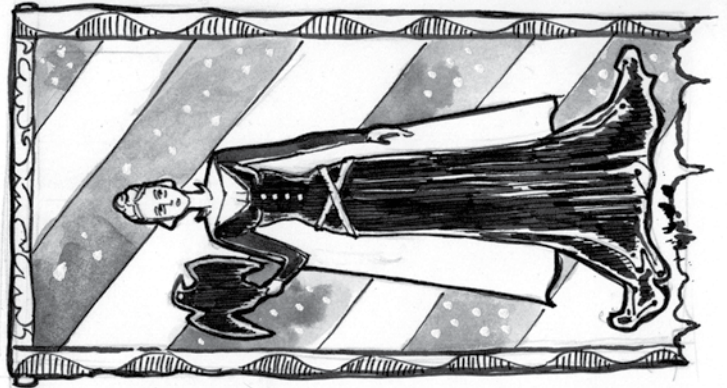
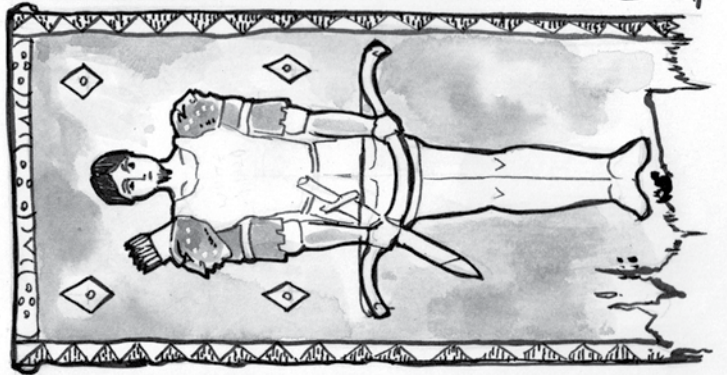
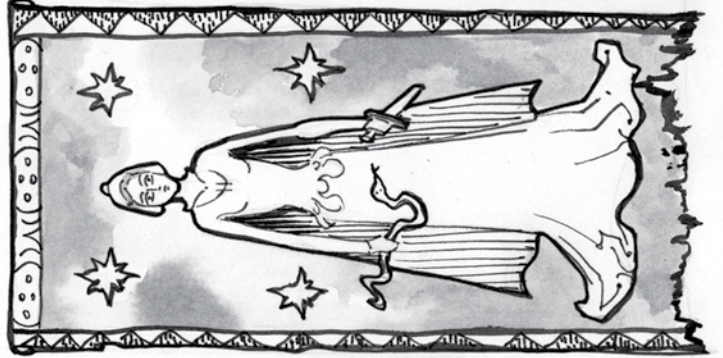
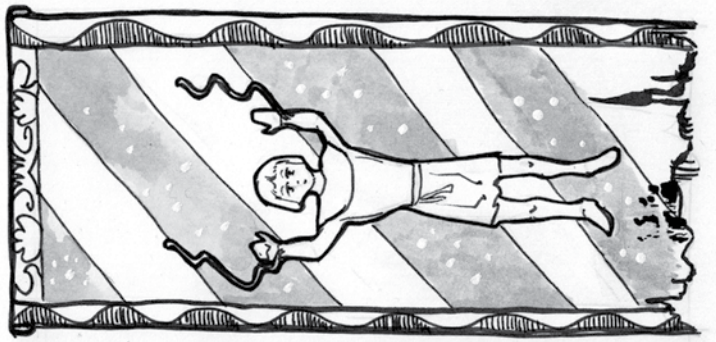

DUNGEON CRAWL CLASSICS

BRIDE OF THE BLACK MANSE

#82: A LEVEL 3 ADVENTURE
BY HARLEY STROH

Centuries past, Lady Ilse ascended to scion of House Liis by trading the archdevil Mammon what he wanted most: her immortal soul – and a diabolical betrothal. The triumph proved hollow, for every year on the eve of her fell covenant, she was beset by visions of Mammon and her foul promise. Seeking to save herself, she was buried alive, swaddled in the holy symbols of a dozen divergent faiths. This desperate ploy held Mammon at bay for centuries...but a devil can afford to wait a very long time.

After hundreds of years, the last of the holy wards has fallen. The devil has come to collect his due. Tonight a storm crashes against the ancient manor house and forgotten spirits rise from the muck and mire. The fallen belfry tolls once more, announcing the hellish fete. As the adventurers arrive to explore the Black Manse, Mammon calls for his winsome bride. He will leave with a soul at the end of the night. The only question is: Whose?



\$9.99
GMG5082