

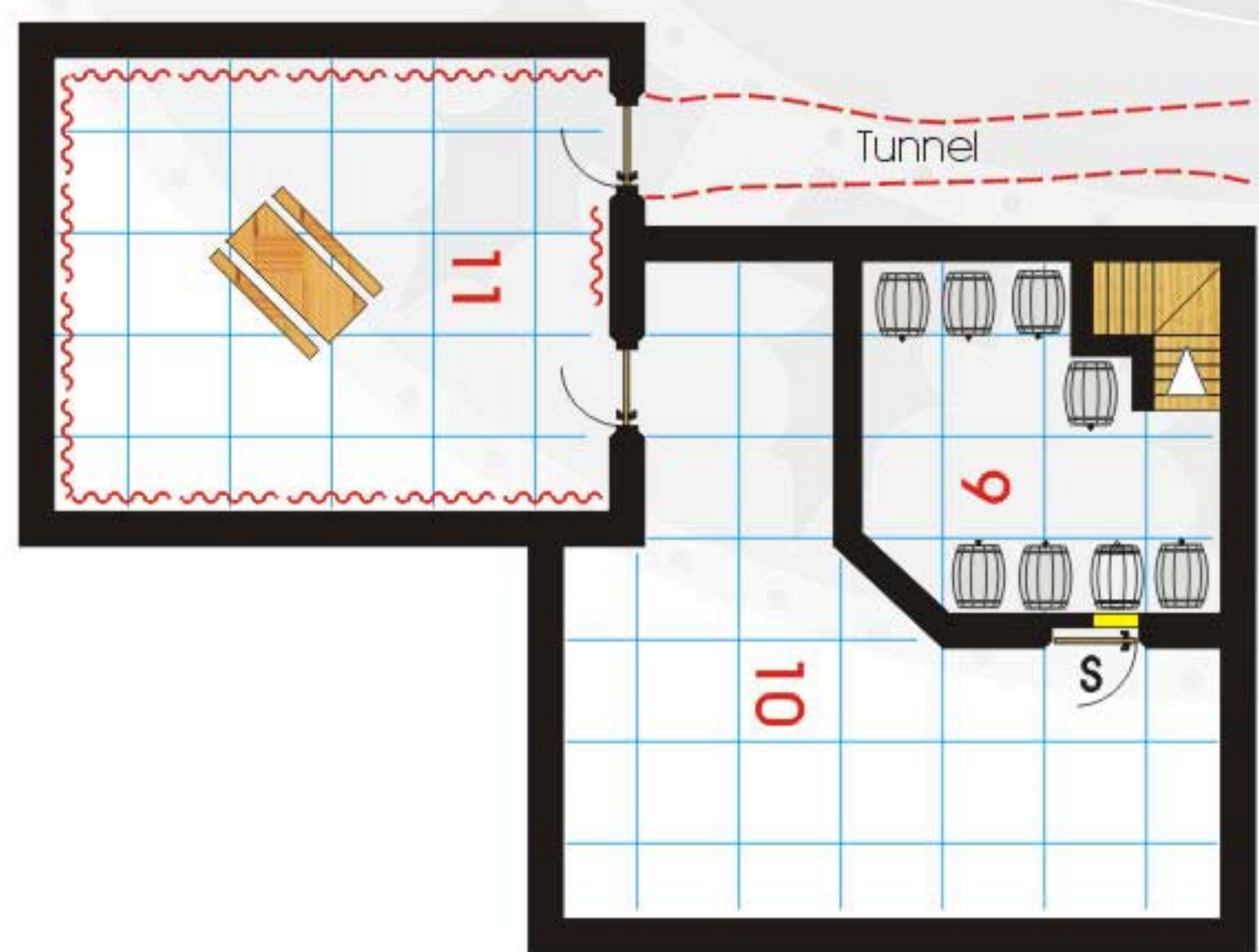



Secret Door
Detail

JOPPIES
TAVERN
Level: 1
& Cellar
CASTLEWALLS
©2000

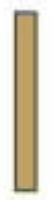
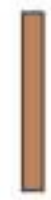

Cellar rotated 90 degrees
counter clockwise



-  Wood Railing
-  Wood Wall
-  Stone Wall
-  Stairs Down
-  Stairs Up



JOPPIES
TAVERN
Level: 2
CASTLEWALLS
©2000



LEVEL: 1

- Area: 1 Entrances
- Area: 2 Pub areas.
- Area: 3 Middens.
- Area: 4 Bar.
- Area: 5 Kitchens.
- Area: 6 Outside "hallways", note the hidden/secret trapdoor in the ceiling from Level: 2, Area: 6.
- Area: 7 Typical stables.
- Area: 8 Typical rooms for rent.
- Area: 9 Storage.
- Area: 10 Secret storage room.
- Area: 11 Secret meeting room.

LEVEL: 2

- Area: 1 Lounge area.
- Area: 2 Upper hallway.
- Area: 3 Typical rooms for rent.
- Area: 4 Owners office.
- Area: 5 Owners living quarters.
- Area: 6 Secret room with trapdoor to outside.
- Area: 7 Kitchen staff living quarters. This area overlooks the upper hallway and down upon the first level. Curtains can be drawn for privacy.
- Area: 8 Kitchen staff bedrooms.